

ROAD SETTING OUT TABLE				
NAM E	CH	Y	X	DETAILS
D2296_RD ALIGNMENTS				
P11	0.000	-15106.023	2818717.130	
BC2	35.445	-15136.910	2818732.008	R 790.000m DA: 0.336 TL: 134.03m AL: 265.518m
EC2	300.963	-15351.999	2818886.149	
P13	860.954	-15746.938	2819283.156	
BC4	860.954	-15746.938	2819283.156	R 26038.452m DA: 0.002 TL: 22.459m AL: 44.997m
P4	905.951	-15778.700	2819315.029	
P15	967.861	-15822.438	2819359.844	
BC6	967.861	-15822.438	2819359.844	
P16	967.861	-15841.154	2819377.633	R 23723.871m DA: 0.002 TL: 26.546m AL: 53.096m
EC8	1020.957	-15898.908	2819396.464	
P17	1317.648	-16069.045	2819606.910	
BC8	1317.648	-16099.045	2819606.910	R 4888.159m DA: 0.003 TL: 7.151m AL: 14.303m
P18	1331.951	-16078.112	2819617.070	
EC8	1331.951	-16078.112	2819617.070	
P19	1585.530	-16257.332	2819797.458	
BC10	1585.530	-16257.332	2819797.458	R 350.000m DA: 0.117 TL: 20.419m AL: 40.792m
P10	1626.522	-16291.625	2819824.742	
EC10	1626.522	-16291.625	2819824.742	
P11	1639.451	-16297.876	2819832.945	
BC12	1639.451	-16297.876	2819832.945	R 280.000m DA: 1.509 TL: 263.225m AL: 422.536m
P12	2061.987	-16690.250	2819997.413	
EC12	2061.987	-16690.250	2819997.413	
P13	2506.615	-16978.930	2819473.083	
BC14	2506.615	-16978.930	2819473.083	R 600.000m DA: 1.154 TL: 46.208m AL: 92.236m
P14	2506.615	-17009.973	2819438.655	
EC14	2506.615	-17009.973	2819438.655	
P15	2732.630	-17109.214	2819286.338	
BC16	2732.630	-17109.214	2819286.338	R 300.000m DA: 1.297 TL: 151.546m AL: 259.572m
P16	2992.301	-17337.003	2819207.000	
EC16	2992.301	-17337.003	2819207.000	
P17	3066.107	-17403.314	2819230.343	
BC18	3066.107	-17403.314	2819230.343	
P18	3101.668	-17440.992	2819241.757	
EC18	3101.668	-17440.992	2819241.757	R 1000.000m DA: 0.936 TL: 17.782m AL: 35.561m
P19	3167.176	-17502.650	2819263.882	
BC20	3167.176	-17502.650	2819263.882	
P20	3167.176	-17553.850	2819282.255	R 90.000m DA: 1.087 TL: 54.397m AL: 97.857m
EC20	3205.034	-17561.384	2819336.127	
P21	3222.805	-17597.088	2819591.414	
BC22	3222.805	-17597.088	2819591.414	
P22	3222.805	-17602.458	2819629.807	
EC22	3222.805	-17602.458	2819629.807	R 160.000m DA: 4.475 TL: 38.766m AL: 76.067m
P23	3638.328	-17647.549	2819693.725	
BC24	3638.328	-17647.549	2819693.725	
P24	3712.185	-17702.984	2819741.368	
EC24	3712.185	-17702.984	2819741.368	R 150.000m DA: 6.482 TL: 37.693m AL: 73.857m
P25	4044.142	-17999.836	2819889.969	
BC26	4044.142	-17999.836	2819889.969	
P26	4044.142	-17999.836	2819889.969	R 210.000m DA: 1.019 TL: 117.303m AL: 213.953m
EC26	4044.142	-17999.836	2819889.969	
P27	4504.199	-18136.647	2820304.474	
BC28	4504.199	-18136.647	2820304.474	R 400.000m DA: 0.513 TL: 117.961m AL: 233.731m
P28	4734.929	-18098.388	2820259.455	
EC28	4734.929	-18098.388	2820259.455	
P29	4865.224	-18044.088	2820548.199	
BC30	4865.224	-18044.088	2820548.199	R 380.000m DA: 0.809 TL: 119.514m AL: 231.884m
P30	5006.807	-18017.371	2820874.543	
EC30	5006.807	-18017.371	2820874.543	
P31	5006.807	-18110.740	2821374.513	

ISSUED FOR APPROVAL		BM	22/05/26	OPGEMEET DEUR / SURVEYED BY		CONSULTING ENGINEERS - RAADGEWENDE INGENIEURS		B.MALEMONA		GOEDGEKEUR / APPROVED		DEPARTMENT: ROADS & TRANSPORT CITY OF MBOMBELA		SCALE / SKAAL		LEER Nr. / FILE No.		DISTRIKT / DISTRICT		TIPPE ONTWERP / TYPE OF PLANNING	
AMENDMENTS - WYSIGINGS		APPROVED GOEDGEKEUR	DATE DATUM	INS HOOF VAN DEPT. / for HEAD OF DEPT.	DATE DATUM	HANDEK. / SIGNTR.	DATE DATUM	 RASK CONSULTING (PTY) LTD OFFICE 161 19 ROTHELY STREET MBOMBELA TEL: (013) 355-3238 E-MAIL: info@raskconsulting.co.za		 F. MURAVHA Pr. Eng. No. 202202328 INS RAADGEWENDE INGENIEUR / for CONSULTING ENGINEER INS HOOF VAN DEPARTEMENT / for HEAD OF DEPARTMENT		UPGRADING OF D2296 ROAD FROM TEKWANE SOUTH TO KANYAMAZANE (6km)		1:250 (A0)		DOREENKOMS Nr. / AGREEMENT No.		ENHLANZENI		DETAIL	
REV		DATE DATUM		DATE DATUM		DATE DATUM		DATE DATUM		DATE DATUM		PPD-2269 - LAY - 011		D2296		RC-2296-RDS-KEY-001					

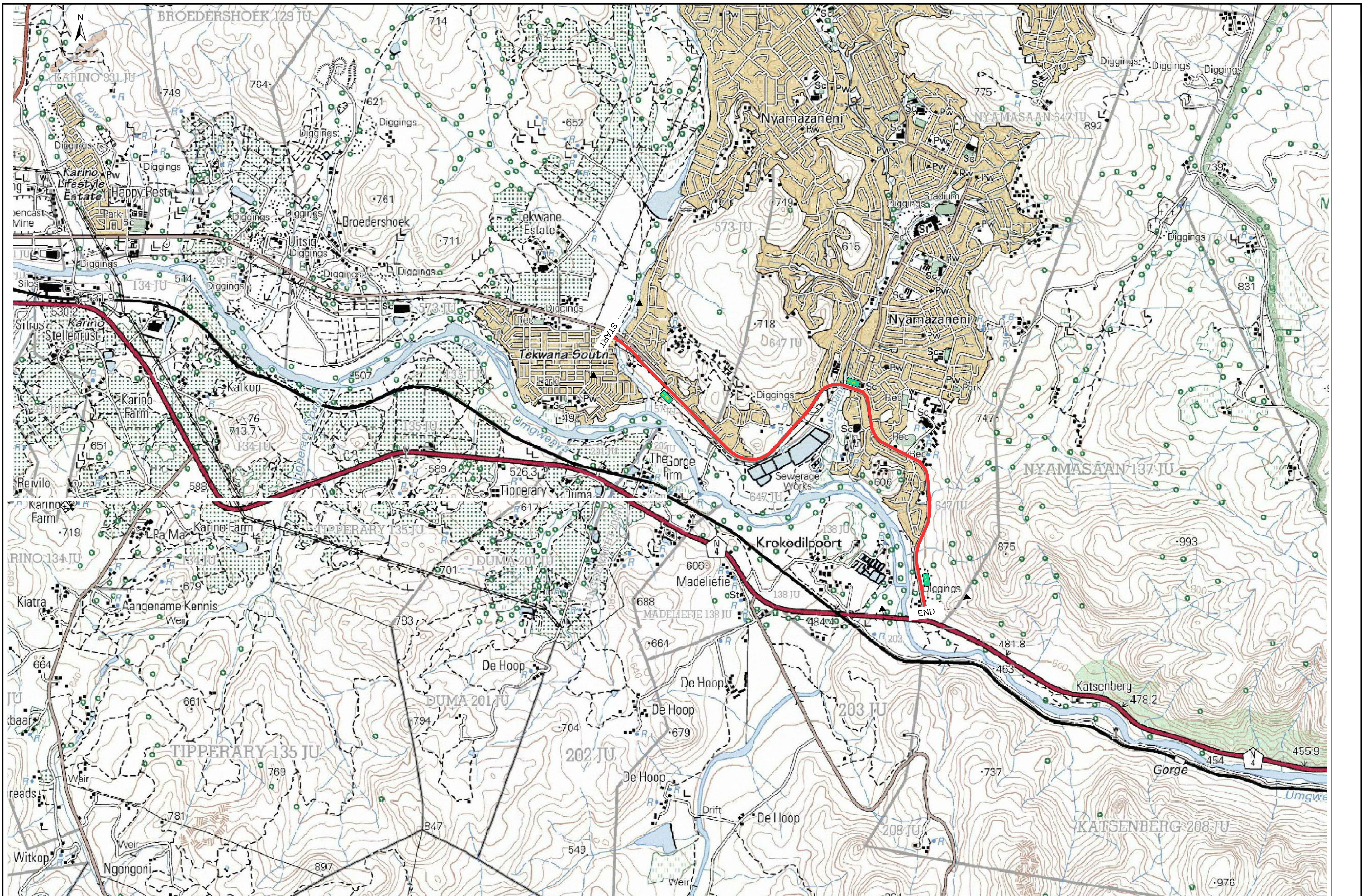

ISSUED FOR APPROVAL	BM	22/05/26	DATE DATUM
AMENDMENTS - WYSIGINGS	APPROVED GOEDGEKUR	DATE DATUM	INS HOOF VAN DEPT. for HEAD OF DEPT.
REV	DATE/DATUM	HANDTEK./SIGNTR.	DATE/DATUM

OPGEMET DEUR / SURVEYED BY
 ADV. DIR. TEG DIENSTE
 DEP. DIR. TECH. SERVICES
 OPMETING / SURVEY

CONSULTING ENGINEERS - RAAGWENDE INGENIEURS
RASK CONSULTING
 CIVIL ENGINEERS & PROJECT MANAGERS
 OFFICE NO. 15 ROSEBURY STREET
 MBOMBELA 1200
 TEL: (013) 750-3230
 E-MAIL: info@raskconsulting.co.za

B.MALEMONA
 ONTWERP / DESIGNED
 F.MURAVHA
 GETEKEN / DRAWN
 S. KGOMO
 NAGESEN / CHECKED

GOEDGEKUR / APPROVED
 Pr. Eng. No. 20220328
 Ins. RAAGWENDE INGENIEUR
 for CONSULTING ENGINEER
 Ins. HOOF VAN DEPARTMENT
 for HEAD OF DEPARTMENT
 DATE/DATUM 22/05/26

DEPARTMENT: ROADS & TRANSPORT
 CITY OF MBOMBELA
 UPGRADING OF D2296 ROAD FROM TEKWANE SOUTH TO KANYAMAZANE (6km)
 LOCALITY MAP



SCALE / SKAAL
 1:250
 (AD)

LEER Nr. / FILE No.	DISTRIK / DISTRICT	TIPPE ONTWERP / TYPE OF PLANNING
COORENOMERS Nr. / AGREEMENT No.	ENHLANZENI	DETAIL
PAD Nr. / ROAD No.	D2296	PLAN Nr. / PLAN No.
		RC-2296-RDS-LM-001

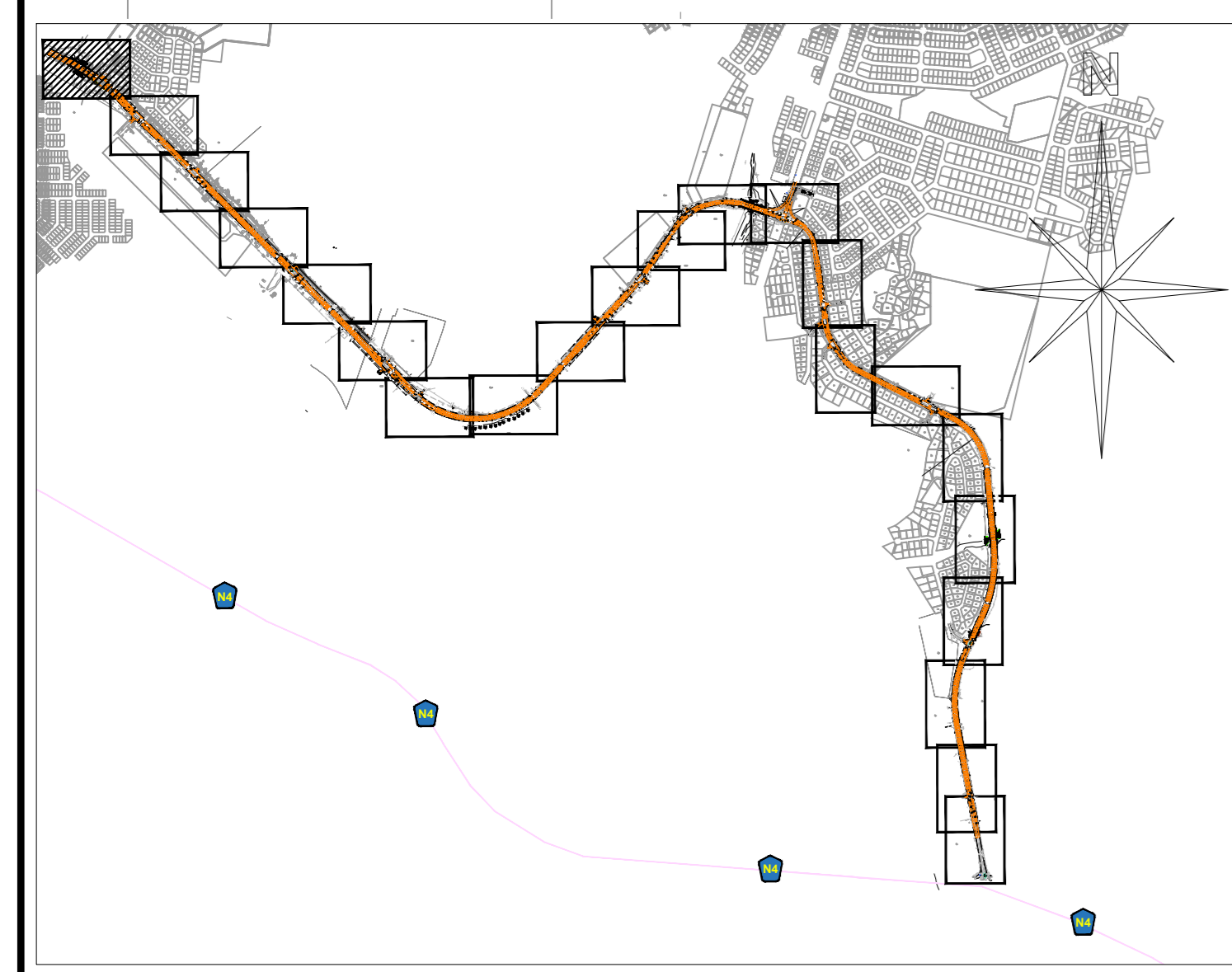
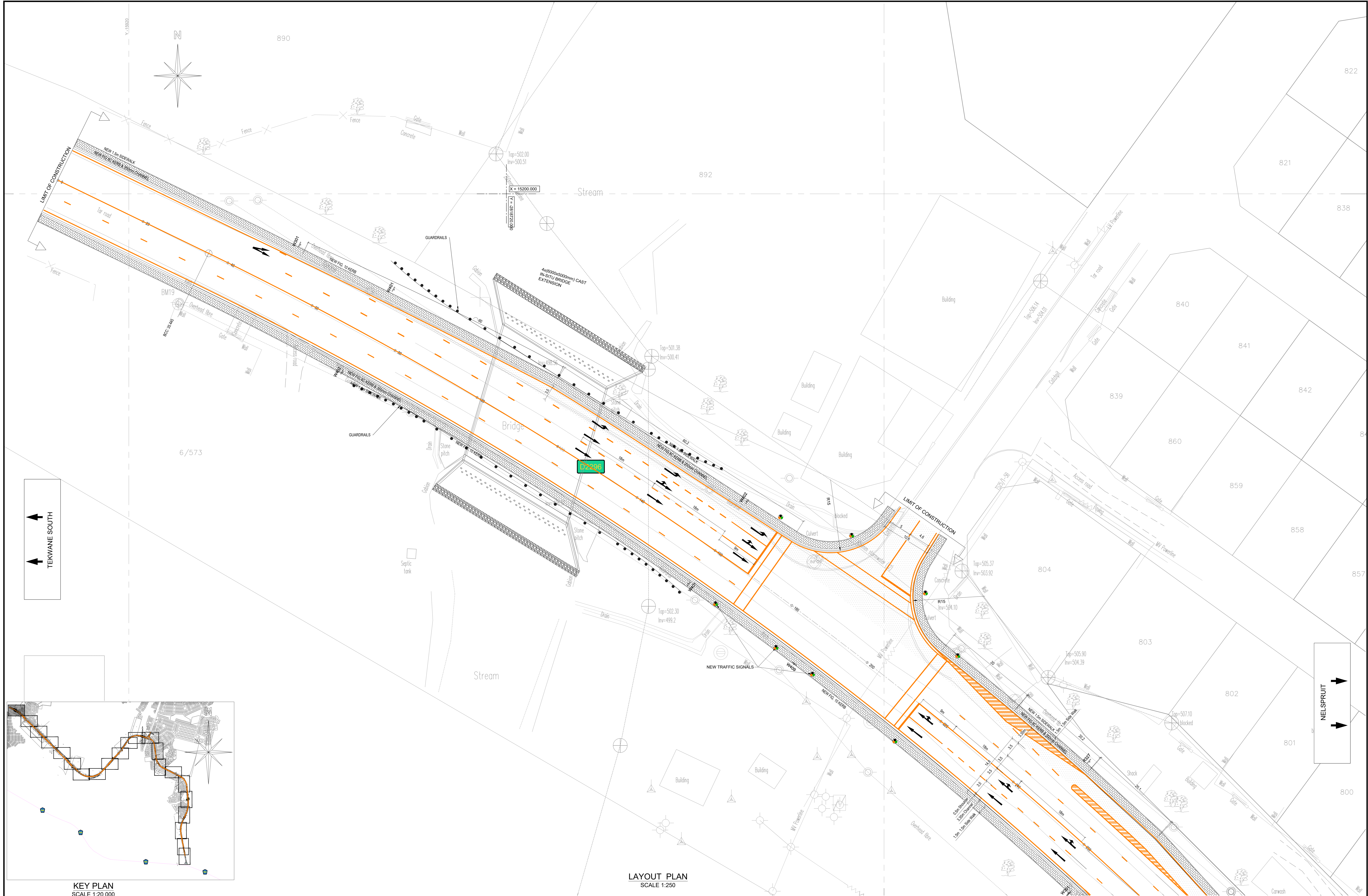

LAYOUT PLAN
SCALE 1:250

REV	AMENDMENTS - WYSIGINGS	APPROVED GOEDGEKEUR	DATE DATUM	INS HOOF VAN DEPT. FOR HEAD OF DEPT.	DATE DATUM
A	ISSUED FOR APPROVAL	BM	22/05/26		

OPGEMET DEUR / SURVEYED BY	CONSULTING ENGINEERS - RAADGEWENDE INGENIEURS	B.MALEMONA	GOEDGEKEUR / APPROVED
ADJ. DIR. TEG-DIENSTE DEP. DIR. TECH. SERVICES OPMETING / SURVEY	RASK CONSULTING (Pty) LTD OFFICE NO. 19 ROSEBERRY STREET MBOMBELA 1200 TEL: (013) 755-3230 E-MAIL: info@raskconsulting.co.za	F.MURAVHA GETEKEN / DRAWN	Pr. Eng. No. 202202328 INS RAADGEWENDE INGENIEUR FOR CONSULTING ENGINEER INS HOOF VAN DEPARTEMENT FOR HEAD OF DEPARTMENT
HANDTEK./SIGNTR.	DATE/DATUM	S. KGOMO NAGESIEN / CHECKED	DATE/DATUM 22/05/26

DEPARTMENT: ROADS & TRANSPORT CITY OF MBOMBELA	SCALE / SKAAL 1:250 (AO)	LEER Nr. / FILE No.	DISTRIKT / DISTRICT ENHLANZENI	TYPE ONTWERP / TYPE OF PLANNING DETAIL
UPGRADING OF D2296 ROAD FROM TERKWANE SOUTH TO KANYAMAZANE (6km)	DORREKOMS Nr. / AGREEMENT No.		PAD Nr. / ROAD No. D2296	PLAN Nr. / PLAN No. RC-2296-RDS-LY-001

<p>CITY OF MBOMBELA LOCAL MUNICIPALITY MUNICIPAL BUILDING 1 NEL STREET MBOMBELA CIVIC CENTER MBOMBELA 1200 TEL: (013) 759-2198</p>

<p>CITY OF MBOMBELA LOCAL MUNICIPALITY MUNICIPAL BUILDING 1 NEL STREET MBOMBELA CIVIC CENTER MBOMBELA 1200 TEL: (013) 759-2198</p>

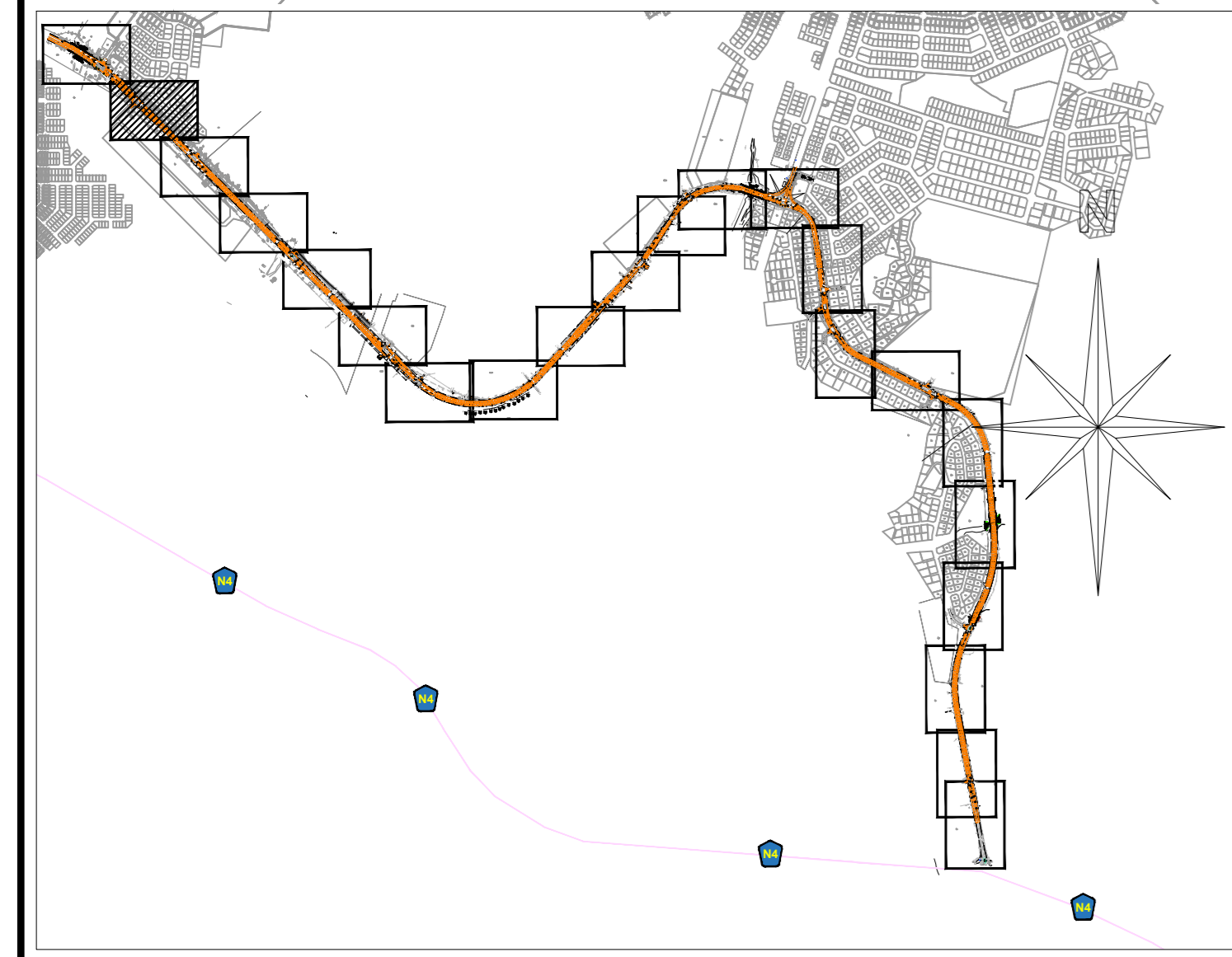

LAYOUT PLAN
SCALE 1:250

DEPARTMENT: ROADS & TRANSPORT CITY OF MBOMBELA		GOEDGEKEUR / APPROVED Pr. Eng. No. 202202328 ins RAADGEWENDE INGENIEUR for CONSULTING ENGINEER ins HOOF VAN DEPARTEMENT for HEAD OF DEPARTMENT		DEPARTMENT: ROADS & TRANSPORT CITY OF MBOMBELA UPGRADING OF D2296 ROAD FROM TEKWANE SOUTH TO KANYAMAZANE (6km)		SCALE / SKAAL 1:250 (A0)		LEER Nr. / FILE No. DOREENKOMS Nr. / AGREEMENT No.		DISTRIKT / DISTRICT ENHLANZENI		TIEP ONTWERP / TYPE OF PLANNING DETAIL	
B.MALEMONA ONTWERP / DESIGNED F.MURAVHA GETEKEN / DRAWN S. KGOMO NAGESIEN / CHECKED		RASK CONSULTING (Pty) LTD OFFICE No. 1 19 ROSEBURY STREET MBOMBELA 1200 TEL: (013) 755-3330 E-MAIL: info@raskconsulting.co.za		CITY OF MBOMBELA LOCAL MUNICIPALITY MUNICIPAL BUILDING 1 NEL STREET MBOMBELA CIVIC CENTER MBOMBELA 1200 TEL: (013) 759-2198		DISTRIKT / DISTRICT ENHLANZENI		PAD Nr. / ROAD No. D2296		PLAN Nr. / PLAN No. RC-2296-RDS-LY-002			
OPGEMET DEUR / SURVEYED BY ins HOOF VAN DEPT. for HEAD OF DEPT.		CONSULTING ENGINEERS - RAADGEWENDE INGENIEURS RASK CONSULTING (Pty) LTD OFFICE No. 1 19 ROSEBURY STREET MBOMBELA 1200 TEL: (013) 755-3330 E-MAIL: info@raskconsulting.co.za		DEPARTMENT: ROADS & TRANSPORT CITY OF MBOMBELA UPGRADING OF D2296 ROAD FROM TEKWANE SOUTH TO KANYAMAZANE (6km)		SCALE / SKAAL 1:250 (A0)		LEER Nr. / FILE No. DOREENKOMS Nr. / AGREEMENT No.		DISTRIKT / DISTRICT ENHLANZENI		TIEP ONTWERP / TYPE OF PLANNING DETAIL	
REV AMENDMENTS - WYSIGINGS APPROVED GOEDGEKEUR DATE DATUM ins HOOF VAN DEPT. for HEAD OF DEPT.		HANDTEK/SIGNTR. DATE/DATUM		DATE/DATUM 22/05/26		DEPARTMENT: ROADS & TRANSPORT CITY OF MBOMBELA UPGRADING OF D2296 ROAD FROM TEKWANE SOUTH TO KANYAMAZANE (6km)		SCALE / SKAAL 1:250 (A0)		DISTRIKT / DISTRICT ENHLANZENI		TIEP ONTWERP / TYPE OF PLANNING DETAIL	

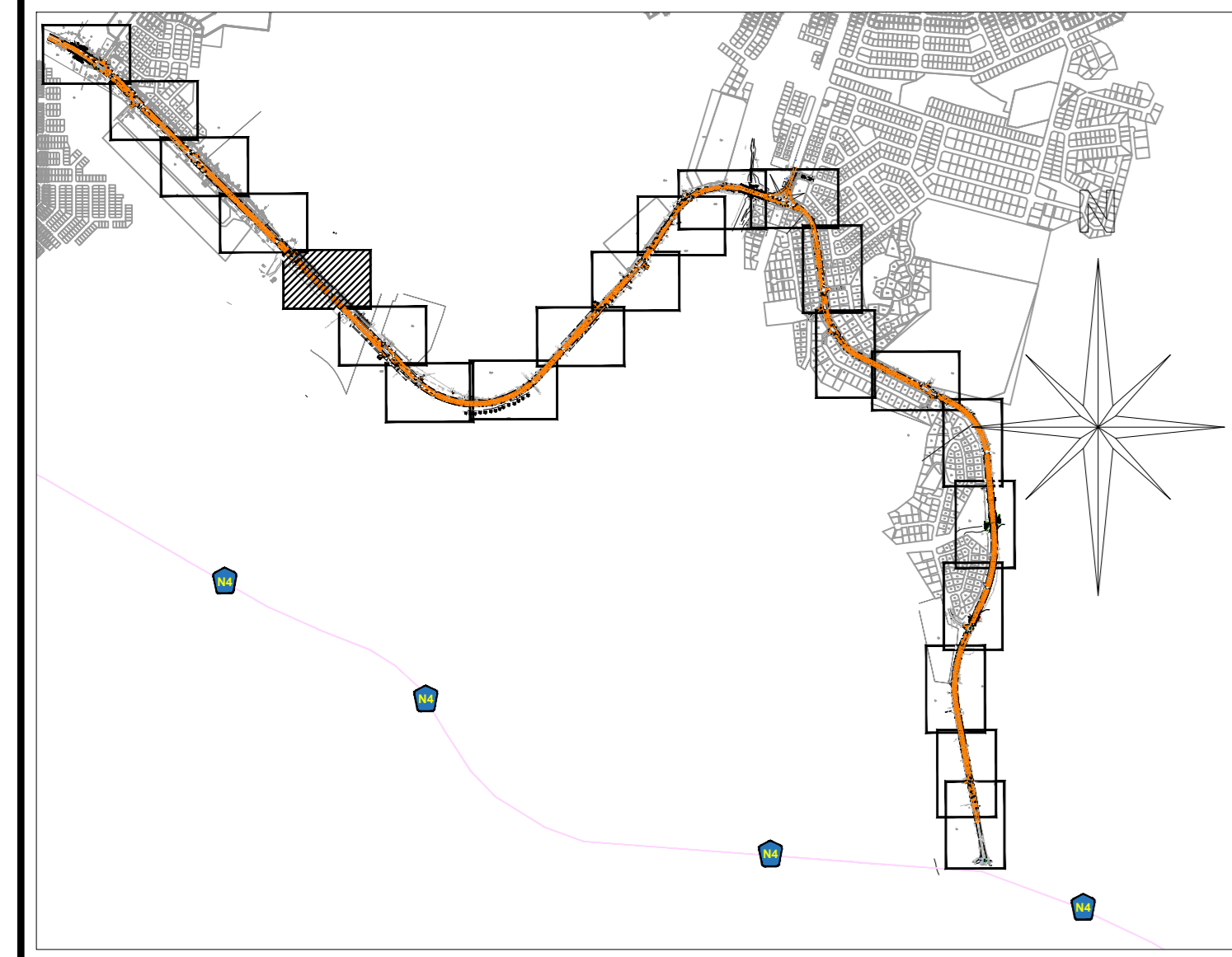
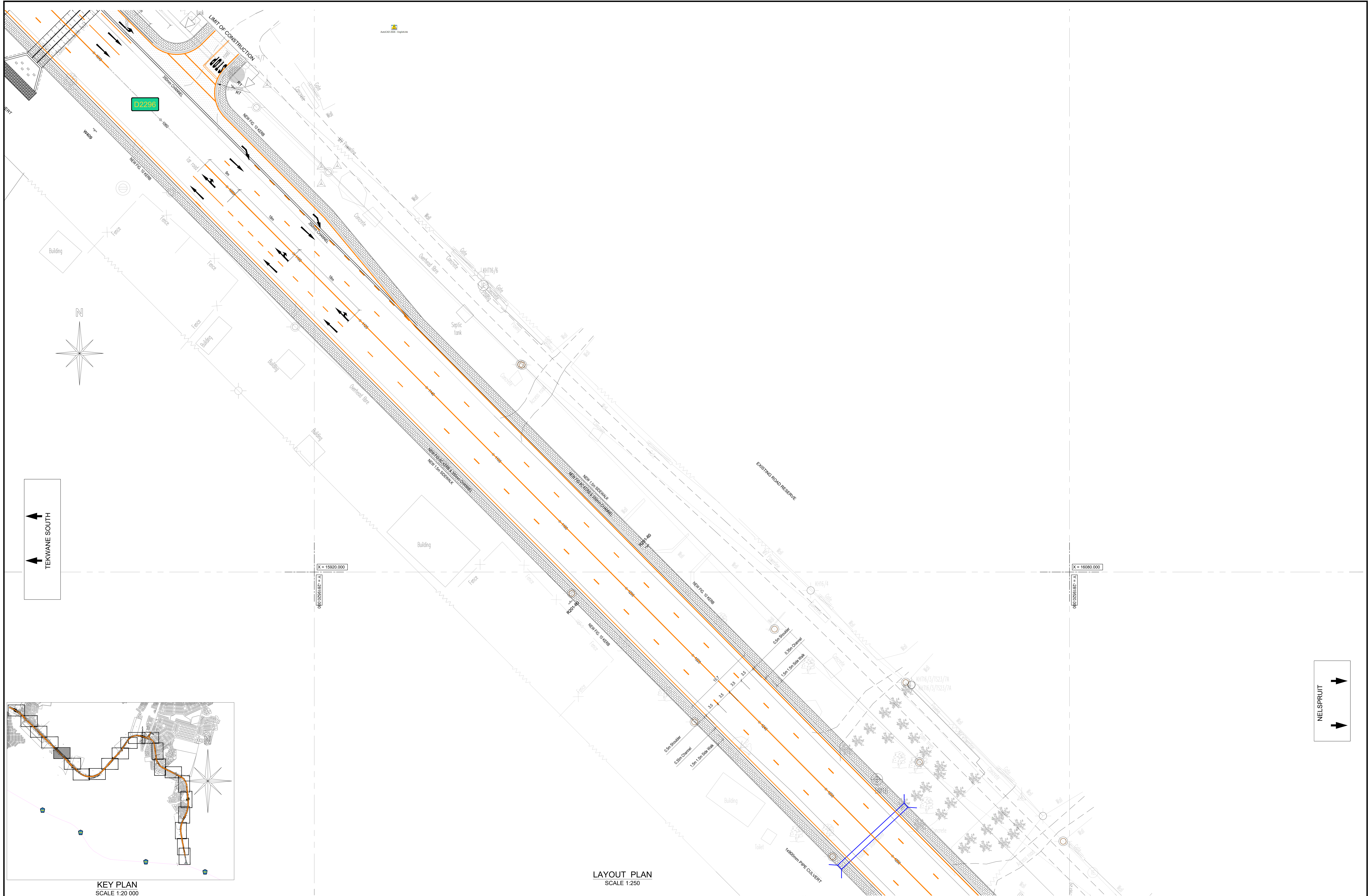

LAYOUT PLAN
SCALE 1:250

OPGEMET DEUR / SURVEYED BY ADJ. DIR. TEG. DIENSTE DEPT. DIR. TECH. SERVICES OPMETING / SURVEY		CONSULTING ENGINEERS - RAADGEWENDE INGENIEURS RASK CONSULTING RASK CONSULTING (Pty) LTD OFFICE No. 1 19 ROSEBERRY STREET MBOMBELA 1200 TEL: (013) 755-3230 E-MAIL: info@raskconsulting.co.za		B.MALEMONA ONTWERP / DESIGNED F.MURAVHA GETEKEN / DRAWN S. KGOMO NAGESIEN / CHECKED		GOEDGEKEUR / APPROVED Pr. Eng. No. 202202328 ins. RAADGEWENDE INGENIEUR for CONSULTING ENGINEER ins. HOOF VAN DEPARTEMENT for HEAD OF DEPARTMENT DATE/DATUM 22/05/26		DEPARTMENT: ROADS & TRANSPORT CITY OF MBOMBELA UPGRADING OF D2296 ROAD FROM TEKWANE SOUTH TO KANYAMAZANE (6km) ROAD & STRUCTURES LAYOUT SHEET 5 OF 22		SCALE / SKAAL 1:250 (A0)		LEER Nr. / FILE No. DOOREENKOMS Nr. / AGREEMENT No.		DISTRIKT / DISTRICT ENHLANZENI PAD Nr. / ROAD No. D2296		TIEP ONTWERP / TYPE OF PLANNING DETAIL PLAN Nr. / PLAN No. RC-2296-RDS-LY-005	
--------------------------------------------------------------------------------------------------------	--	--------------------------------------------------------------------------------------------------------------------------------------------------------------------------------------------------------------------------	--	----------------------------------------------------------------------------------------------------	--	----------------------------------------------------------------------------------------------------------------------------------------------------------------------------------------	--	---------------------------------------------------------------------------------------------------------------------------------------------------------------------------	--	--------------------------------	--	--------------------------------------------------------	--	------------------------------------------------------------------	--	----------------------------------------------------------------------------------------	--

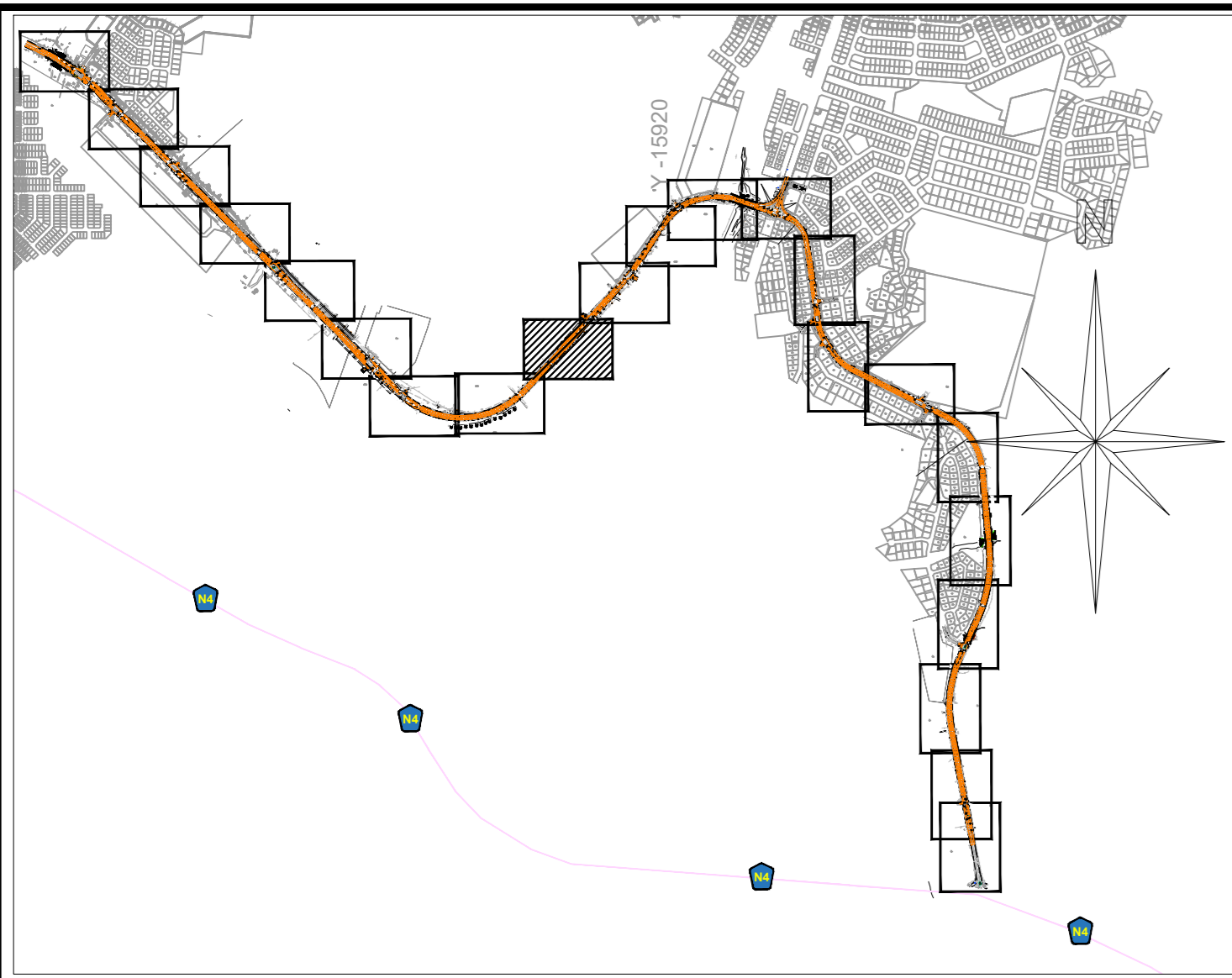

KEY PLAN
SCALE 1:20 000

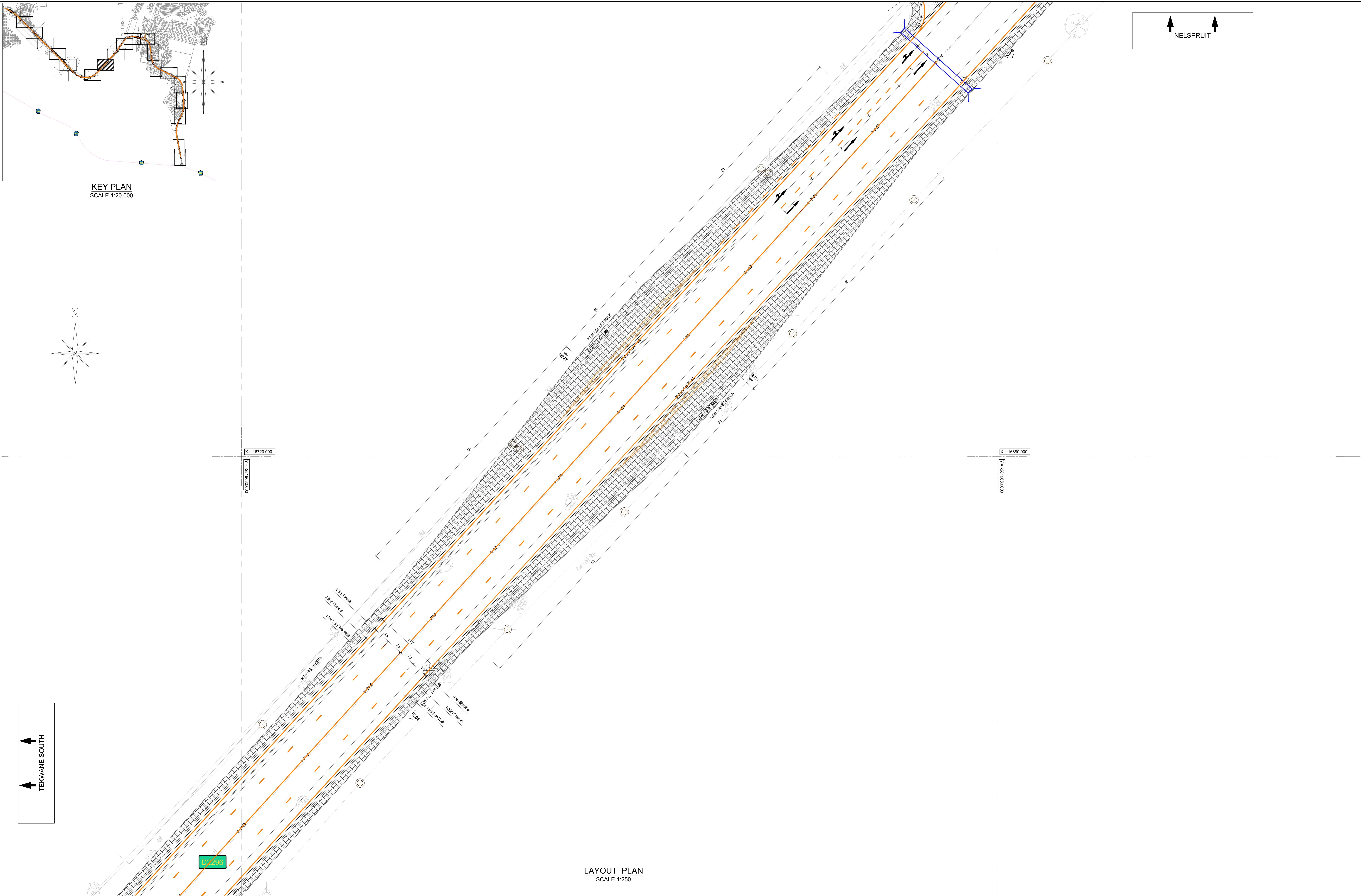
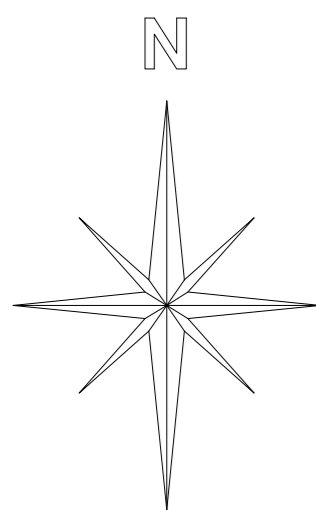

LAYOUT PLAN
SCALE 1:250

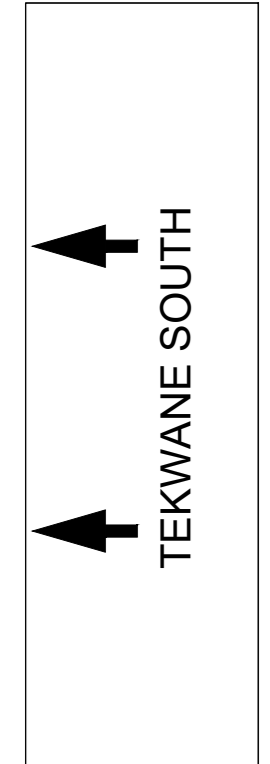

OPGEMET DEUR / SURVEYED BY ADJ. DIR. TEG. DIENSTE DEP. DIR. TECH. SERVICES OPMETING / SURVEY		CONSULTING ENGINEERS - RAADGEWENDE INGENIEURS RASK CONSULTING RASK CONSULTING (Pty) Ltd OFFICE No. 1 19 ROSEBERRY STREET MBOMBELA 1200 TEL: (013) 755-3230 E-MAIL: info@raskconsulting.co.za		B.MALEMONA ONTWERP / DESIGNED F.MURAVHA GETEKEN / DRAWN S. KGOMO NAGESIEN / CHECKED		GOEDGEKEUR / APPROVED Pr. Eng. No. 202202328 ins. RAADGEWENDE INGENIEUR for CONSULTING ENGINEER DATE/DATUM 22/05/26		DEPARTMENT: ROADS & TRANSPORT CITY OF MBOMBELA UPGRADING OF D2296 ROAD FROM TEKWANE SOUTH TO KANYAMAZANE (6km)		DEPARTMENT: ROADS & TRANSPORT CITY OF MBOMBELA CITY OF MBOMBELA LOCAL MUNICIPALITY MUNICIPAL BUILDING 1 NEL STREET MBOMBELA CIVIC CENTER MBOMBELA 1200 TEL: (013) 759-2198		SCALE / SKAAL 1:250 (A0)		LEER Nr. / FILE No. DOOREENKOMS Nr. / AGREEMENT No.		DISTRIKT / DISTRICT ENHLANZENI PAD Nr. / ROAD No. D2296		TIEP ONTWERP / TYPE OF PLANNING DETAIL PLAN Nr. / PLAN No. RC-2296-RDS-LY-009	
A ISSUED FOR APPROVAL REV AMENDMENTS - WYSIGINGS		APPROVED GOEDGEKEUR DATE/DATUM 22/05/26 ins. HOOF VAN DEPT. for HEAD OF DEPT.		DATE/DATUM		DATE/DATUM		ROAD & STRUCTURES LAYOUT SHEET 9 OF 22		CITY OF MBOMBELA THE ULTIMATE DESTINATION		D2296		RC-2296-RDS-LY-009					

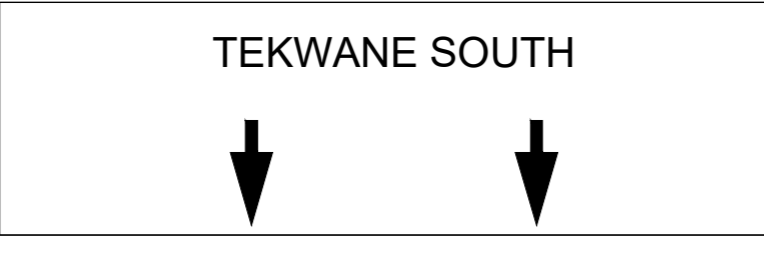
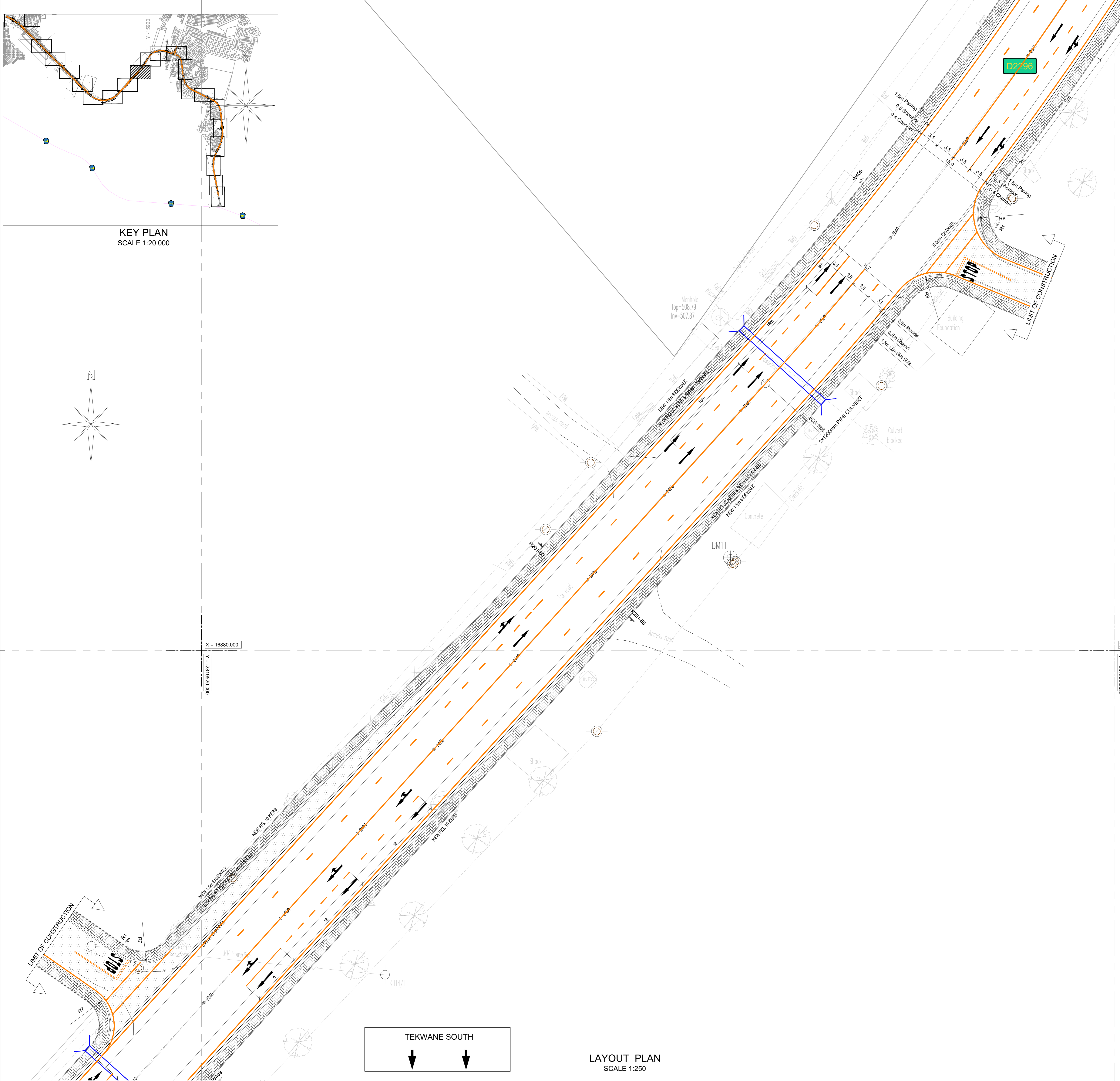
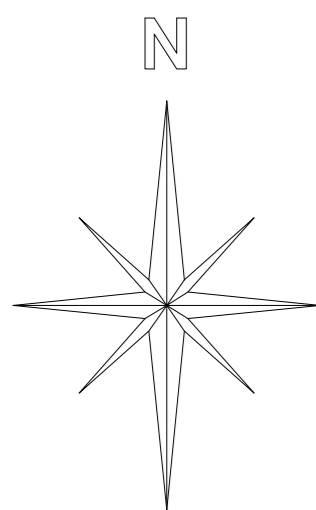
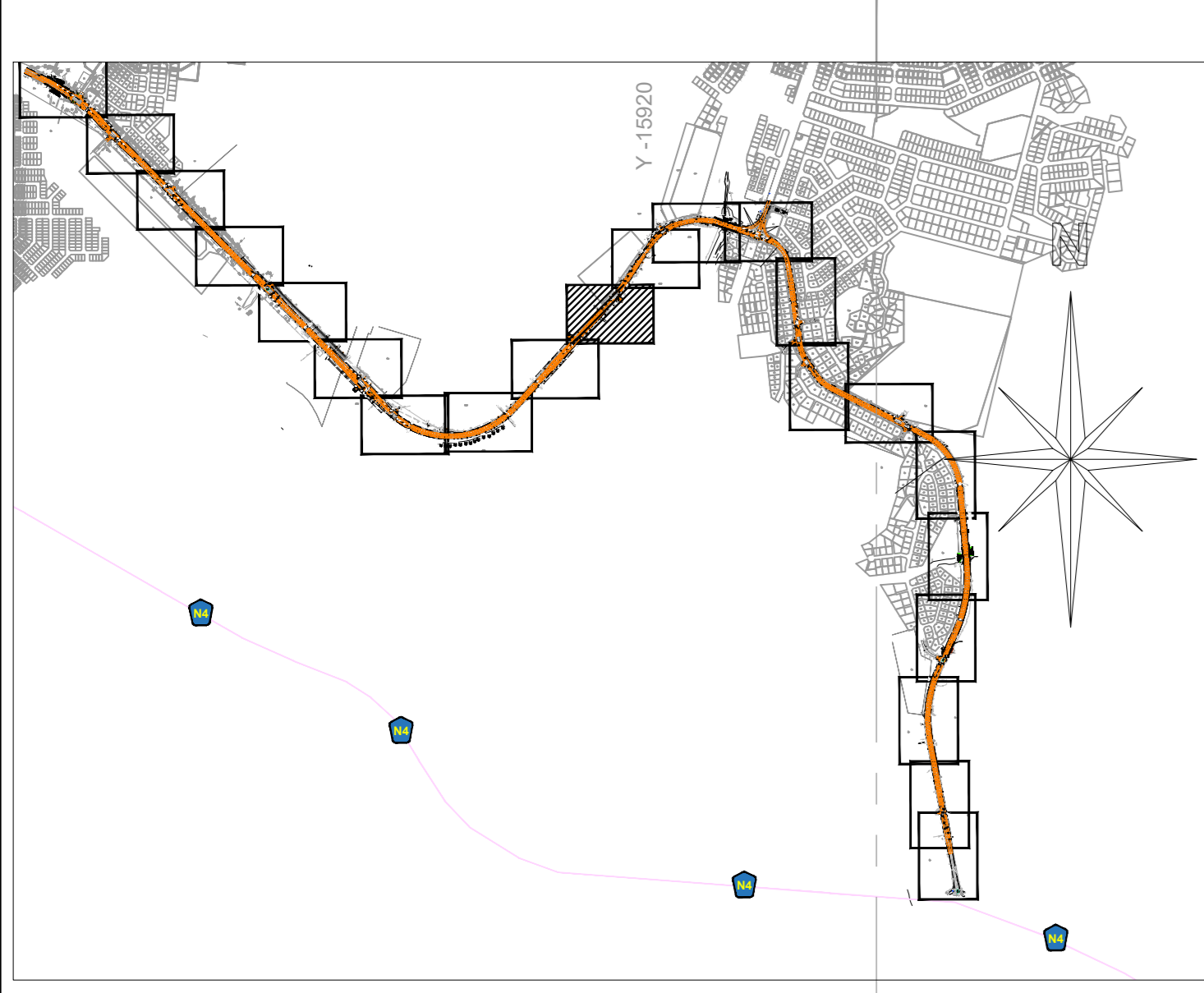

LAYOUT PLAN
SCALE 1:250

REV	AMENDMENTS - WYSIGINGS	APPROVED GOEDGEKEUR	DATE DATUM	INS HOOF VAN DEPT. for HEAD OF DEPT.	DATE DATUM
A	ISSUED FOR APPROVAL	BM	22/05/26		

OPGEMET DEUR / SURVEYED BY	CONSULTING ENGINEERS - RAADGEWENDE INGENIEURS
ADJ. DIR. TEG. DIENSTE DEPT. DIR. TECH. SERVICES OPMETING / SURVEY	RASK CONSULTING RASK CONSULTING (Pty) LTD OFFICE No. 1 19 ROSEBURY STREET MBOMBELA 1200 TEL: (013) 755-3230 E-MAIL: info@raskconsulting.co.za

B. MALEMONA ONTWERP / DESIGNED	GOEDGEKEUR / APPROVED
F. MURAVHA GETEKEN / DRAWN	Pr. Eng. No. 202202328 INS RAADGEWENDE INGENIEUR for CONSULTING ENGINEER
S. KGOMO NAGESIEN / CHECKED	INS HOOF VAN DEPARTEMENT for HEAD OF DEPARTMENT

DEPARTMENT: ROADS & TRANSPORT CITY OF MBOMBELA
UPGRADING OF D2296 ROAD FROM TEKWANE SOUTH TO KANYAMAZANE (6km)
ROAD & STRUCTURES LAYOUT SHEET 10 OF 22

SCALE / SKAAL	LEER Nr. / FILE No.	DISTRIKT / DISTRICT	TIPPE ONTWERP / TYPE OF PLANNING
1:250 (A0)		ENHLANZENI	DETAIL
DOOREENKOMS Nr. / AGREEMENT No.	PAD Nr. / ROAD No.	D2296	PLAN Nr. / PLAN No. RC-2296-RDS-LY-010



SCALE / SKAAL	LEER Nr. / FILE No.	DISTRIKT / DISTRICT	TIPPE ONTWERP / TYPE OF PLANNING
1:250 (A0)		ENHLANZENI	DETAIL
DOOREENKOMS Nr. / AGREEMENT No.	PAD Nr. / ROAD No.	D2296	PLAN Nr. / PLAN No. RC-2296-RDS-LY-010

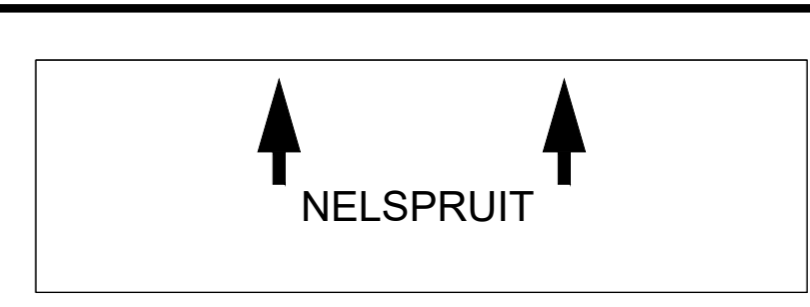
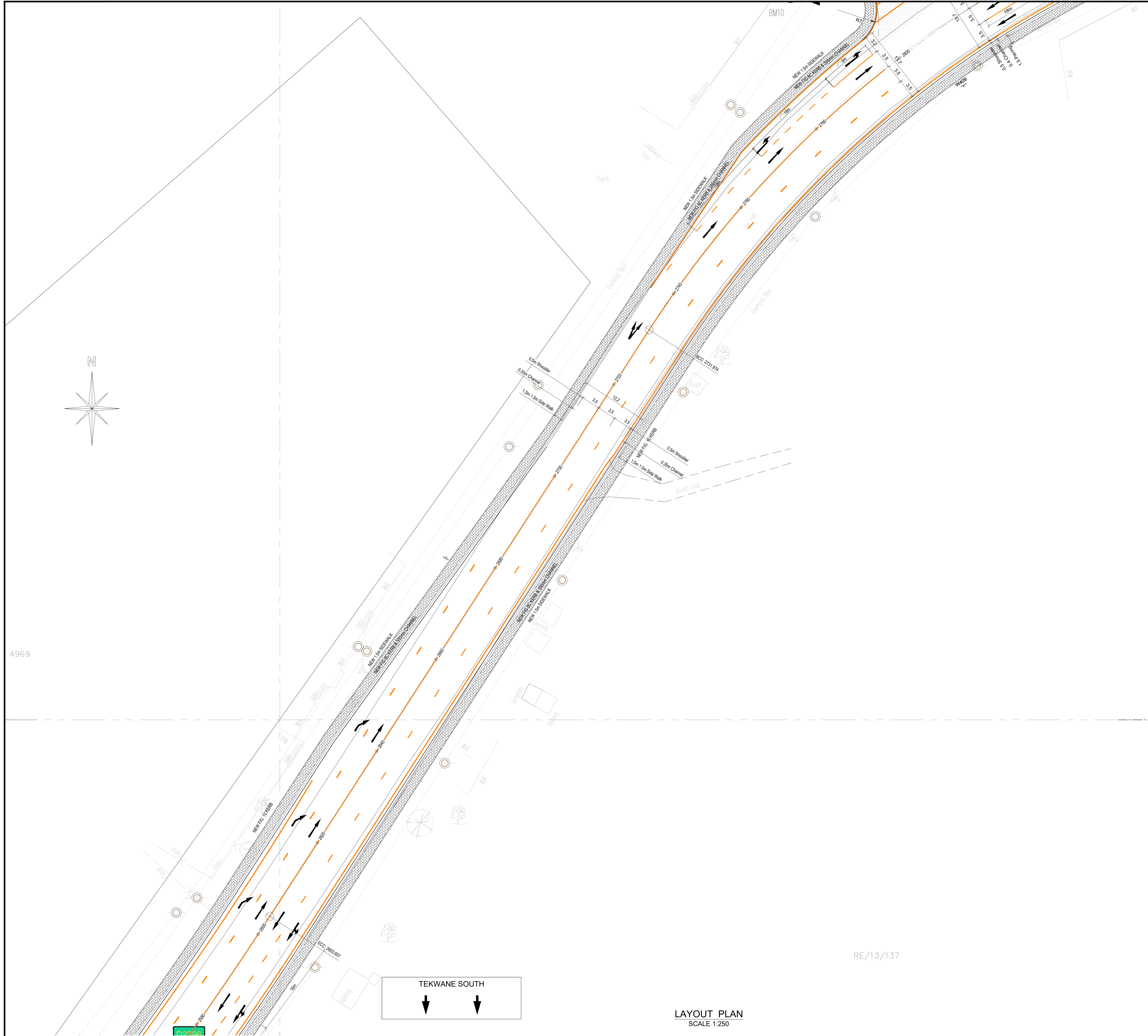

RE/13/137

4969

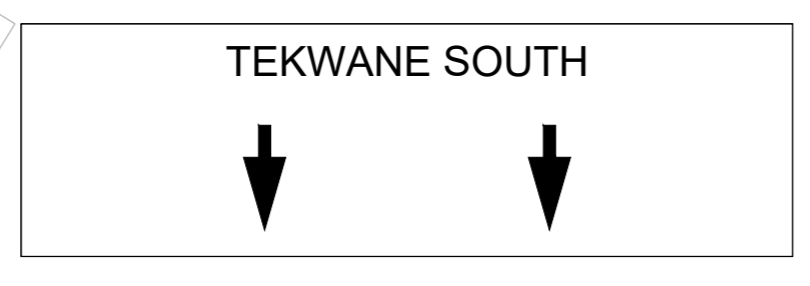

LAYOUT PLAN
SCALE 1:250

RE/13/137

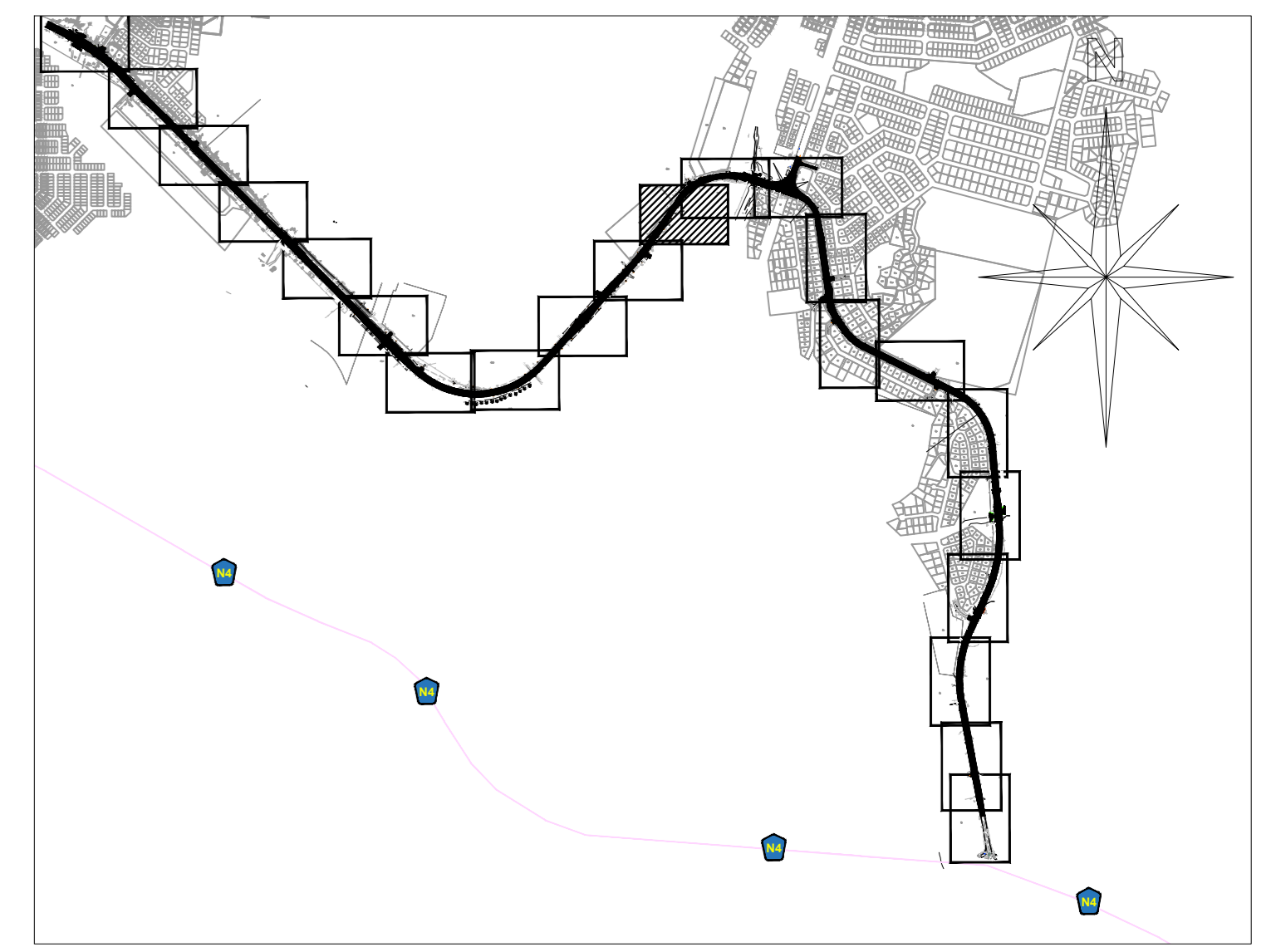

KEY PLAN
SCALE 1:20 000

REV AMENDMENTS - WYSIGINGS APPROVED GOEDGEKEUR DATE DATUM 22/05/26		OPGEMET DEUR / SURVEYED BY ADJ. DIR. TEG. DIENSTE DEPT. DIR. TECH. SERVICES OPMETING / SURVEY		CONSULTING ENGINEERS - RAADGEWENDE INGENIEURS RASK CONSULTING RASK CONSULTING (Pty) Ltd OFFICE No. 19 ROSEBURY STREET MBOMBELA 1200 TEL: (013) 755-3230 E-MAIL: info@raskconsulting.co.za		B.MALEMONA ONTWERP / DESIGNED F.MURAVHA GETEKEN / DRAWN S. KGOMO NAGESIEN / CHECKED		GOEDGEKEUR / APPROVED Pr. Eng. No. 202202328 ins RAADGEWENDE INGENIEUR for CONSULTING ENGINEER DATE/DATUM 22/05/26		DEPARTMENT: ROADS & TRANSPORT CITY OF MBOMBELA UPGRADING OF D2296 ROAD FROM TEKWANE SOUTH TO KANYAMAZANE (6km)		DEPARTMENT: ROADS & TRANSPORT CITY OF MBOMBELA CITY OF MBOMBELA LOCAL MUNICIPALITY MUNICIPAL BUILDING 1 NEL STREET MBOMBELA CIVIC CENTER MBOMBELA 1200 TEL: (013) 759-2198		SCALE / SKAAL 1:250 (A0)		LEER Nr. / FILE No. DOOREENKOM No. / AGREEMENT No.		DISTRIKT / DISTRICT ENHLANZENI		TIEPE ONTWERP / TYPE OF PLANNING DETAIL	
A ISSUED FOR APPROVAL BM		22/05/26		ins HOOF VAN DEPT. for HEAD OF DEPT. DATE DATUM		HANDTEK./SIGNTR. DATE/DATUM		DATE/DATUM		ROAD & STRUCTURES LAYOUT SHEET 11 OF 22		CITY OF MBOMBELA THE ULTIMATE DESTINATION		D2296		RC-2296-RDS-LY-011					

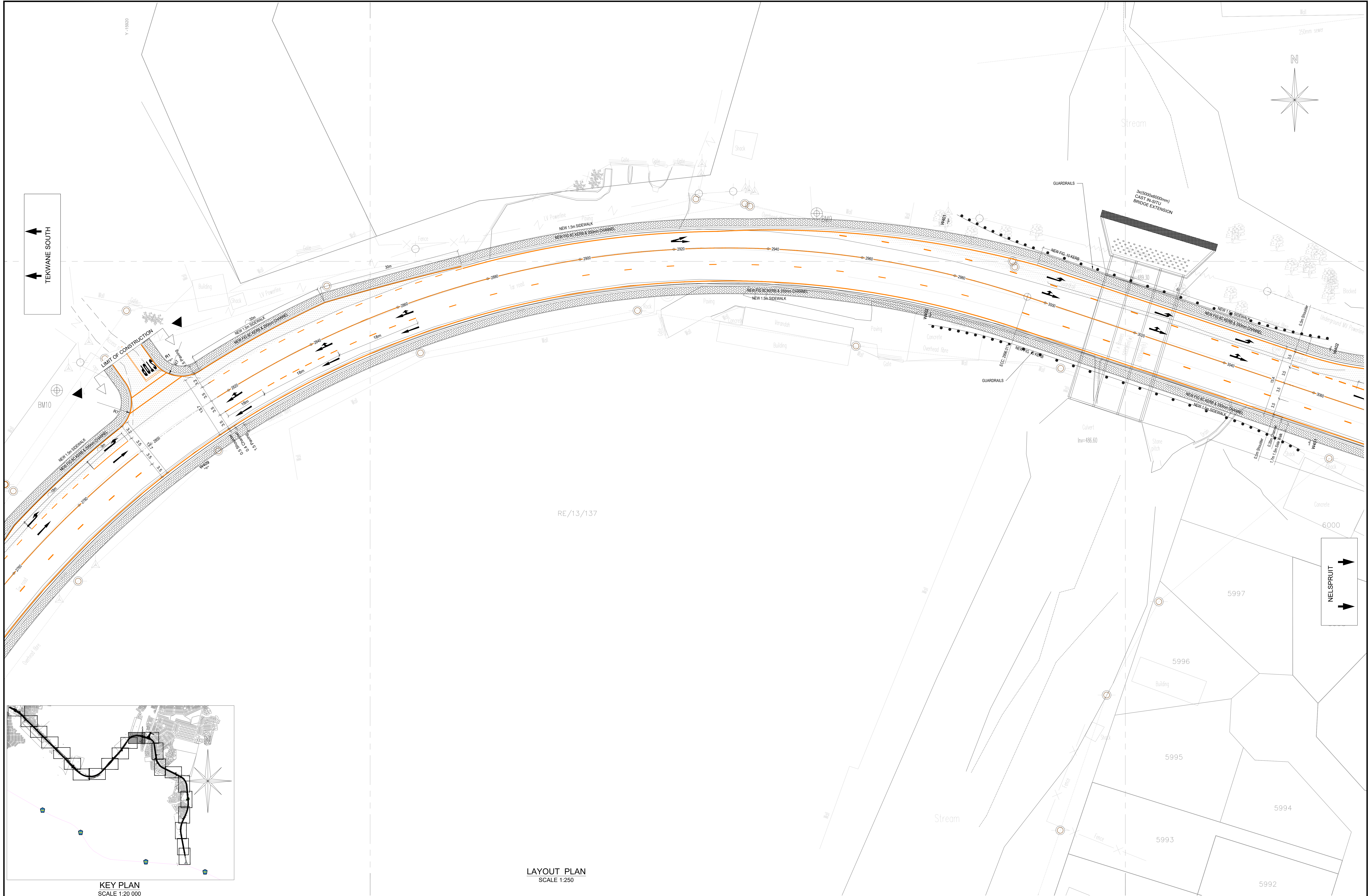

TEKWANE SOUTH

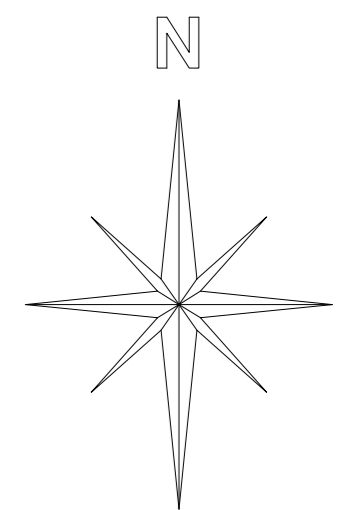

RE/13/137

NELSPRUIT



KEY PLAN
SCALE 1:20 000

LAYOUT PLAN
SCALE 1:250

ISSUED FOR APPROVAL		DATE	22/05/26	APPROVED		DATE	22/05/26	CONSULTING ENGINEERS - RAADGEWENDE INGENIEURS		B.MALEMONA ONTWERP / DESIGNED		GOEDGEKEUR / APPROVED		DEPARTMENT: ROADS & TRANSPORT CITY OF MBOMBELA		SCALE / SKAAL 1:250 (A0)		LEER Nr. / FILE No.		DISTRIKT / DISTRICT ENHLANZENI		TIPPE ONTWERP / TYPE OF PLANNING DETAIL	
AMENDMENTS - WYSIGINGS		APPROVED GOEDGEKEUR	DATE DATUM	ADJ. DIR. TEG-DIENSTE DEP. DIR. TECH. SERVICES OPMETING / SURVEY		DATE DATUM		RASK CONSULTING (Pty) Ltd OFFICE No. 1 19 ROSEBERRY STREET MBOMBELA 1200 TEL: (013) 755-3230 E-MAIL: info@raskconsulting.co.za		F.MURAVHA GETEKEN / DRAWN		Pr. Eng. No. 202202328 ins. RAADGEWENDE INGENIEUR for CONSULTING ENGINEER		UPGRADING OF D2296 ROAD FROM TEKWANE SOUTH TO KANYAMAZANE (6km)		CITY OF MBOMBELA LOCAL MUNICIPALITY MUNICIPAL BUILDING 1 NEL STREET MBOMBELA CIVIC CENTER MBOMBELA 1200 TEL: (013) 759-2198		D00REENKOMS Nr. / AGREEMENT No.		PAD Nr. / ROAD No. D2296		PLAN Nr. / PLAN No. RC-2296-RDS-LY-012	
REV				ins. HOOF VAN DEPT. for HEAD OF DEPT.				S. KGOMO NAGESIEN / CHECKED		DATE/DATUM 22/05/26		DATE/DATUM		ROAD & STRUCTURES LAYOUT SHEET 12 OF 22									

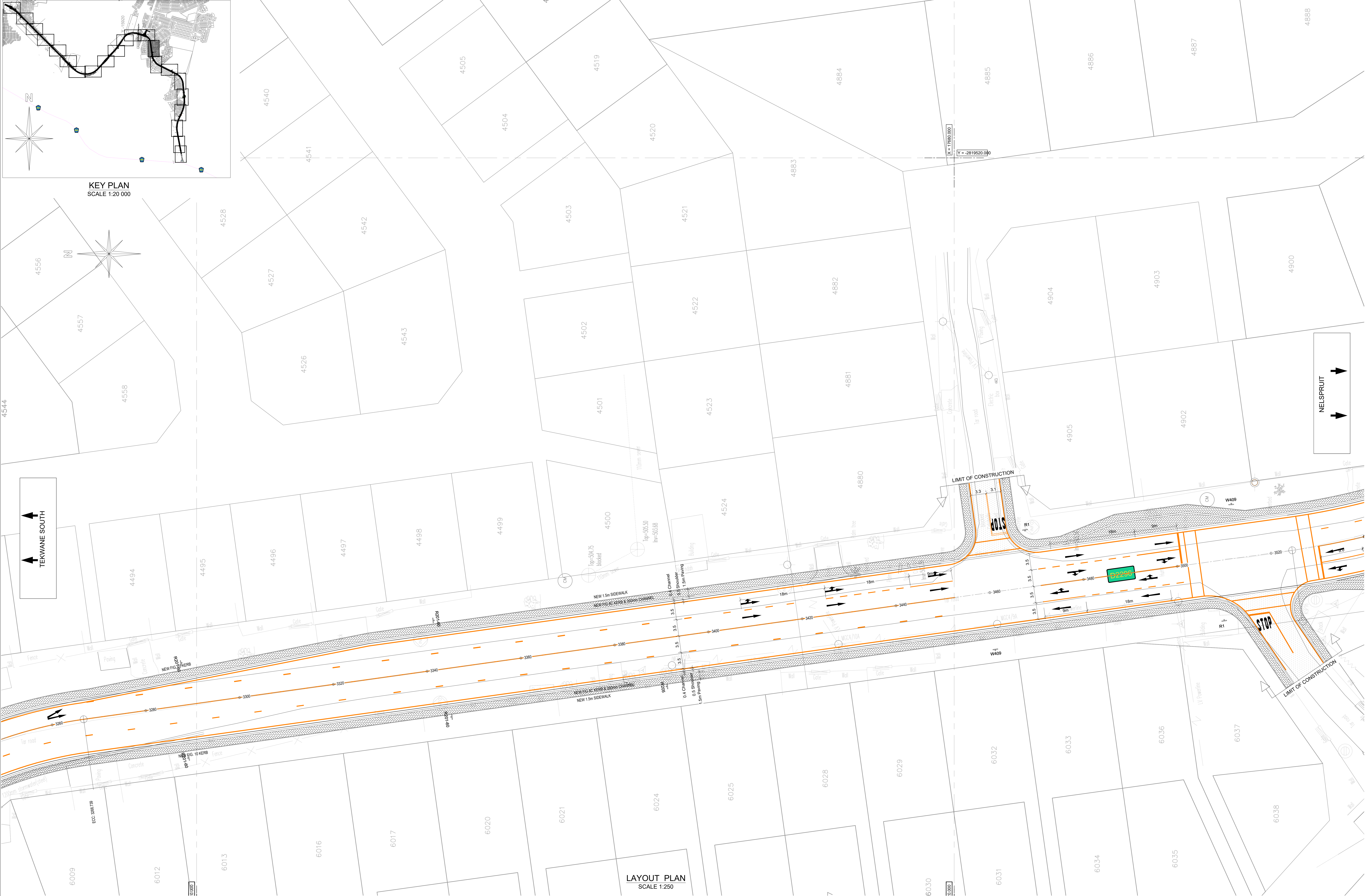

KEY PLAN
SCALE 1:20 000

LAYOUT PLAN
SCALE 1:250

OPGEMET DEUR / SURVEYED BY ADJ. DIR. TEG-DIENSTE DEP. DIR. TECH. SERVICES OPMETING / SURVEY		CONSULTING ENGINEERS - RAADGEWENDE INGENIEURS RASK CONSULTING RASK CONSULTING (Pty) LTD OFFICE No. 19 ROSEBURY STREET MBOMBELA 1200 TEL: (013) 755-3230 E-MAIL: info@raskconsulting.co.za		B.MALEMONA ONTWERP / DESIGNED F.MURAVHA GETEKEN / DRAWN S. KGOMO NAGESIEN / CHECKED		GOEDGEKEUR / APPROVED Pr. Eng. No. 202202328 ins RAADGEWENDE INGENIEUR for CONSULTING ENGINEER ins HOOF VAN DEPARTEMENT for HEAD OF DEPARTMENT		DEPARTMENT: ROADS & TRANSPORT CITY OF MBOMBELA UPGRADING OF D2296 ROAD FROM TEKWANE SOUTH TO KANYAMAZANE (6km)		DEPARTMENT: ROADS & TRANSPORT CITY OF MBOMBELA CITY OF MBOMBELA LOCAL MUNICIPALITY MUNICIPAL BUILDING 1 NEL STREET MBOMBELA CIVIC CENTER MBOMBELA 1200 TEL: (013) 759-2198		SCALE / SKAAL 1:250 (A0)		LEER Nr. / FILE No. DOOREENKOMS Nr. / AGREEMENT No.		DISTRIKT / DISTRICT ENHLANZENI		TYPPE ONTWERP / TYPE OF PLANNING DETAIL	
A ISSUED FOR APPROVAL REV AMENDMENTS - WYSIGINGS		BM 22/05/26 DATE DATUM ins HOOF VAN DEPT. for HEAD OF DEPT.		DATE DATUM HANDTEK./SIGNTR. DATE/DATUM		DATE/DATUM		ROAD & STRUCTURES LAYOUT SHEET 14 OF 22		CITY OF MBOMBELA THE ULTIMATE DESTINATION		D2296		PLAN Nr. / PLAN No. RC-2296-RDS-LY-014					

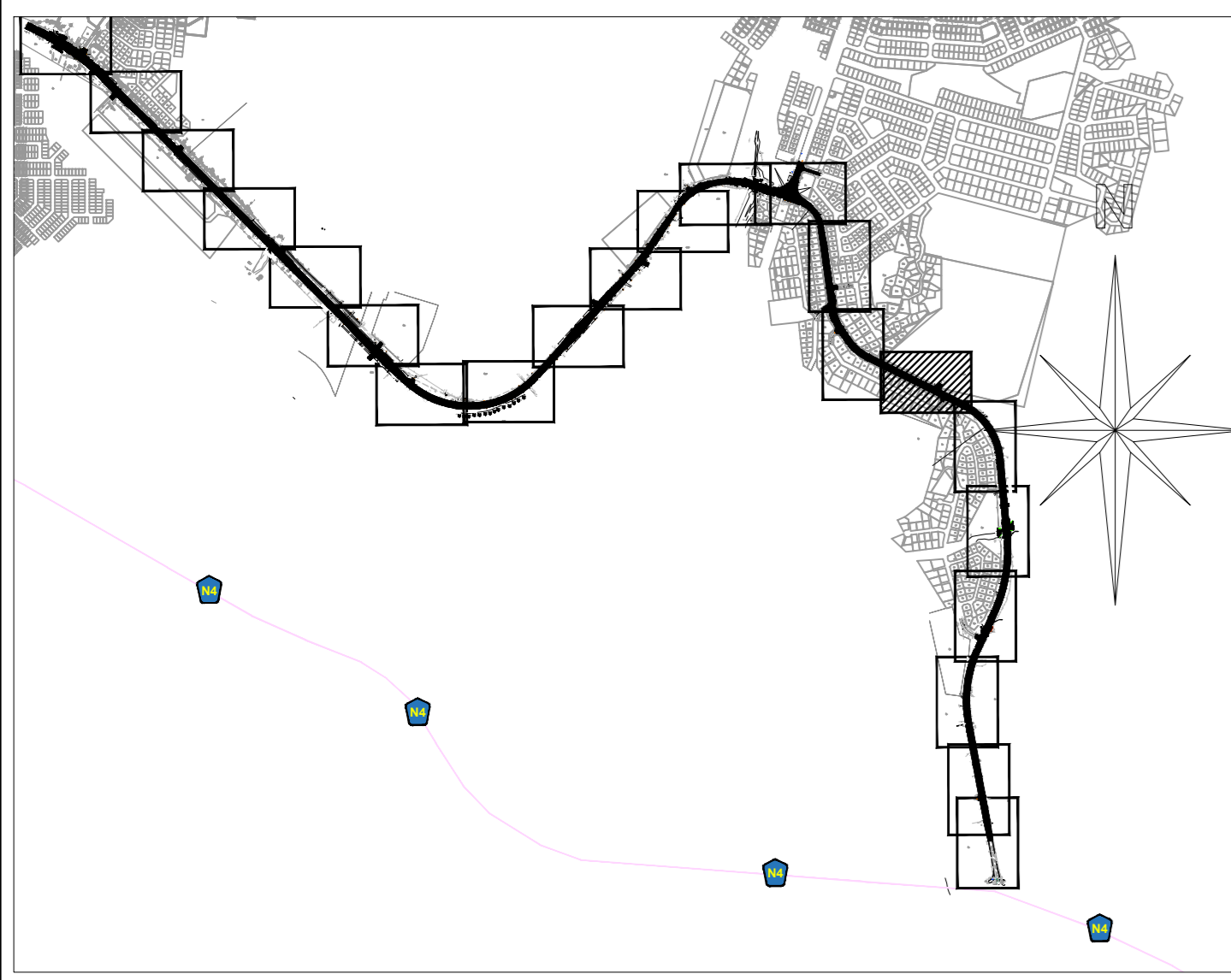
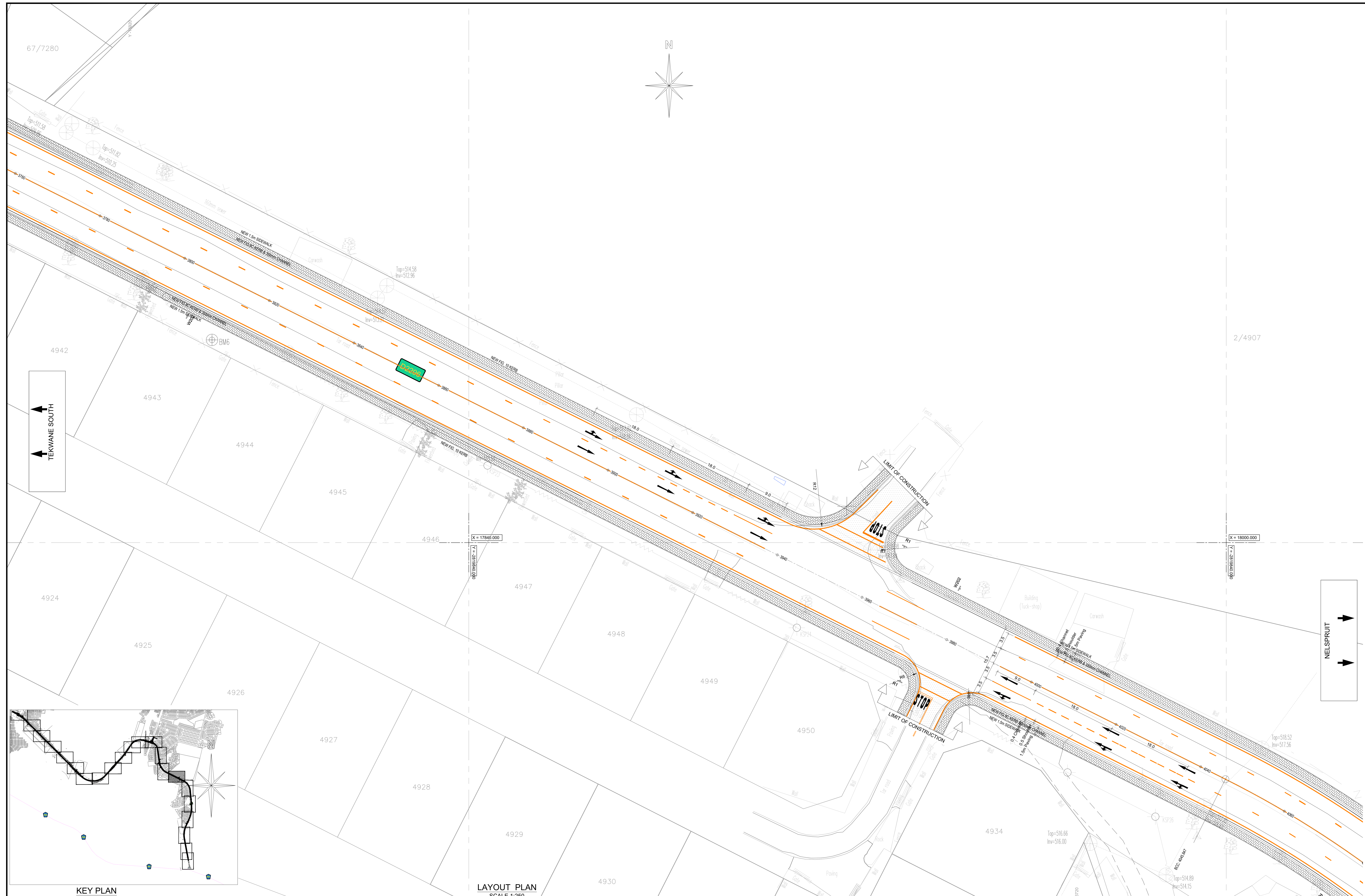

LAYOUT PLAN
SCALE 1:250

DEPARTMENT: ROADS & TRANSPORT CITY OF MBOMBELA		DEPARTMENT: ROADS & TRANSPORT CITY OF MBOMBELA		DEPARTMENT: ROADS & TRANSPORT CITY OF MBOMBELA		DEPARTMENT: ROADS & TRANSPORT CITY OF MBOMBELA		DEPARTMENT: ROADS & TRANSPORT CITY OF MBOMBELA		DEPARTMENT: ROADS & TRANSPORT CITY OF MBOMBELA		DEPARTMENT: ROADS & TRANSPORT CITY OF MBOMBELA		DEPARTMENT: ROADS & TRANSPORT CITY OF MBOMBELA															
UPGRADE OF D2296 ROAD FROM TEKWANE SOUTH TO KANYAMAZANE (6km)		UPGRADE OF D2296 ROAD FROM TEKWANE SOUTH TO KANYAMAZANE (6km)		UPGRADE OF D2296 ROAD FROM TEKWANE SOUTH TO KANYAMAZANE (6km)		UPGRADE OF D2296 ROAD FROM TEKWANE SOUTH TO KANYAMAZANE (6km)		UPGRADE OF D2296 ROAD FROM TEKWANE SOUTH TO KANYAMAZANE (6km)		UPGRADE OF D2296 ROAD FROM TEKWANE SOUTH TO KANYAMAZANE (6km)		UPGRADE OF D2296 ROAD FROM TEKWANE SOUTH TO KANYAMAZANE (6km)		UPGRADE OF D2296 ROAD FROM TEKWANE SOUTH TO KANYAMAZANE (6km)															
ROAD & STRUCTURES LAYOUT SHEET 16 OF 22		ROAD & STRUCTURES LAYOUT SHEET 16 OF 22		ROAD & STRUCTURES LAYOUT SHEET 16 OF 22		ROAD & STRUCTURES LAYOUT SHEET 16 OF 22		ROAD & STRUCTURES LAYOUT SHEET 16 OF 22		ROAD & STRUCTURES LAYOUT SHEET 16 OF 22		ROAD & STRUCTURES LAYOUT SHEET 16 OF 22		ROAD & STRUCTURES LAYOUT SHEET 16 OF 22															
SCALE / SKAAL 1:250 (AO)		LEER Nr. / FILE No. DISTRIKT / DISTRICT ENHLANZENI		TYPPE ONTWERP / TYPE OF PLANNING DETAIL		DOOREENKOMS Nr. / AGREEMENT No.		PAD Nr. / ROAD No. D2296		PLAN Nr. / PLAN No. RC-2296-RDS-LY-016		CITY OF MBOMBELA LOCAL MUNICIPALITY MANCIPA BULIDING 1 NEL STREET MBOMBELA CIVIC CENTER MBOMBELA 3200 TEL: (013) 759-2198		RASK CONSULTING (Pty) Ltd OFFICE No. 18 ROSEBURY STREET MBOMBELA 3200 TEL: (013) 755-3230 E-MAIL: info@raskconsulting.co.za		B.MALEMONA ONTWERP / DESIGNED F.MURAVHA GETEKEN / DRAWN S. KGOMO NAGESIEN / CHECKED		GOEDGEKEUR / APPROVED Pr. Eng. No. 202202328 ins RAADGEWENDE INGENIEUR for CONSULTING ENGINEER ins HOOF VAN DEPARTEMENT for HEAD OF DEPARTMENT DATE/DATUM 22/05/26 DATE/DATUM		OPGEMET DEUR / SURVEYED BY ONTWERP / DESIGNED F.MURAVHA GETEKEN / DRAWN S. KGOMO NAGESIEN / CHECKED DATE/DATUM 22/05/26 DATE/DATUM		ADJ. DIR. TEG-DIENSTE DEP. DIR. TECH. SERVICES OPMETING / SURVEY DATE/DATUM 22/05/26 DATE/DATUM		AMENDMENTS - WYSIGINGS APPROVED GOEDGEKEUR DATE/DATUM ins HOOF VAN DEPT. for HEAD OF DEPT. DATE/DATUM		ISSUED FOR APPROVAL BM DATE/DATUM 22/05/26 DATE/DATUM		67/7280 2/4907 4942 4943 4944 4945 4946 4947 4948 4949 4950 4934 4930	



KEY PLAN
SCALE 1:20 000

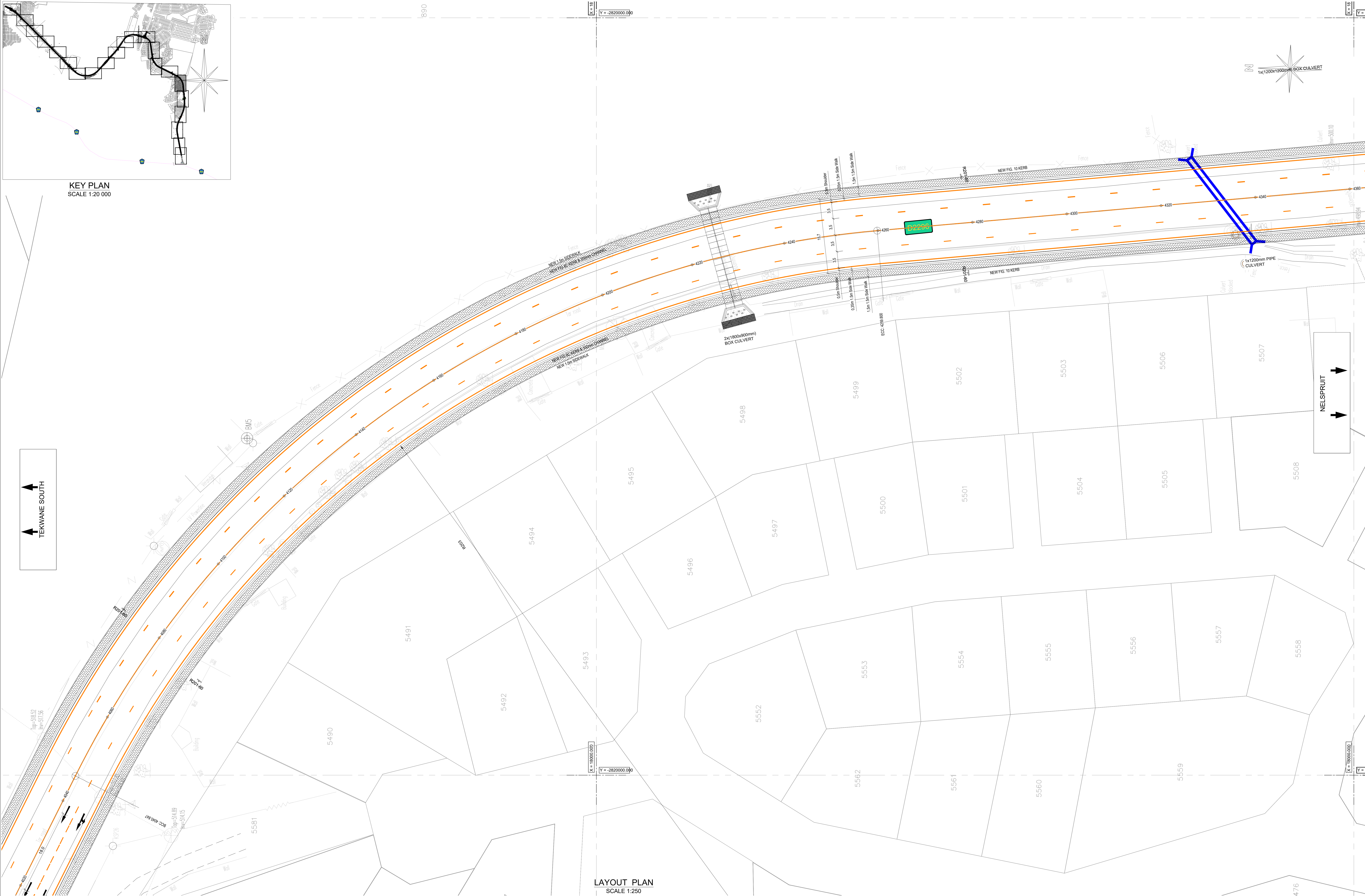

LAYOUT PLAN
SCALE 1:250

TEKWANE SOUTH

NELSPRUIT

OPGEMET DEUR / SURVEYED BY	ADJ. DIR. TEG. DIENSTE DEP. DIR. TECH. SERVICES OPMETING / SURVEY	DATE/DATUM	DATE/DATUM
ISSUED FOR APPROVAL	APPROVED GOEDGEKEUR	22/05/26	
AMENDMENTS - WYSIGINGS	DATE/DATUM	DATE/DATUM	DATE/DATUM

CONSULTING ENGINEERS - RAADGEWENDE INGENIEURS	B.MALEMONA ONTWERP / DESIGNED	GOEDGEKEUR / APPROVED
RASK CONSULTING (PTY) LTD OFFICE NO. 19 ROSEBERRY STREET MBOMBELA 1200 TEL: (013) 755-3230 E-MAIL: info@raskconsulting.co.za	F.MURAVHA GETEKEN / DRAWN	Pr. Eng. No. 202202328 ins RAADGEWENDE INGENIEUR for CONSULTING ENGINEER
	S. KGOMO NAGESIEN / CHECKED	ins HOOF VAN DEPARTEMENT for HEAD OF DEPARTMENT
		DATE/DATUM 22/05/26 DATE/DATUM

DEPARTMENT: ROADS & TRANSPORT
CITY OF MBOMBELA
UPGRADING OF D2296 ROAD FROM TEKWANE SOUTH TO KANYAMAZANE (6km)
ROAD & STRUCTURES LAYOUT SHEET 17 OF 22



SCALE / SKAAL	LEER Nr. / FILE No.	DISTRIKT / DISTRICT	TIPPE ONTWERP / TYPE OF PLANNING
1:250 (AO)		ENHLANZENI	DETAIL
DOOREENKOMS Nr. / AGREEMENT No.	PAD Nr. / ROAD No.	D2296	PLAN Nr. / PLAN No. RC-2296-RDS-LY-017

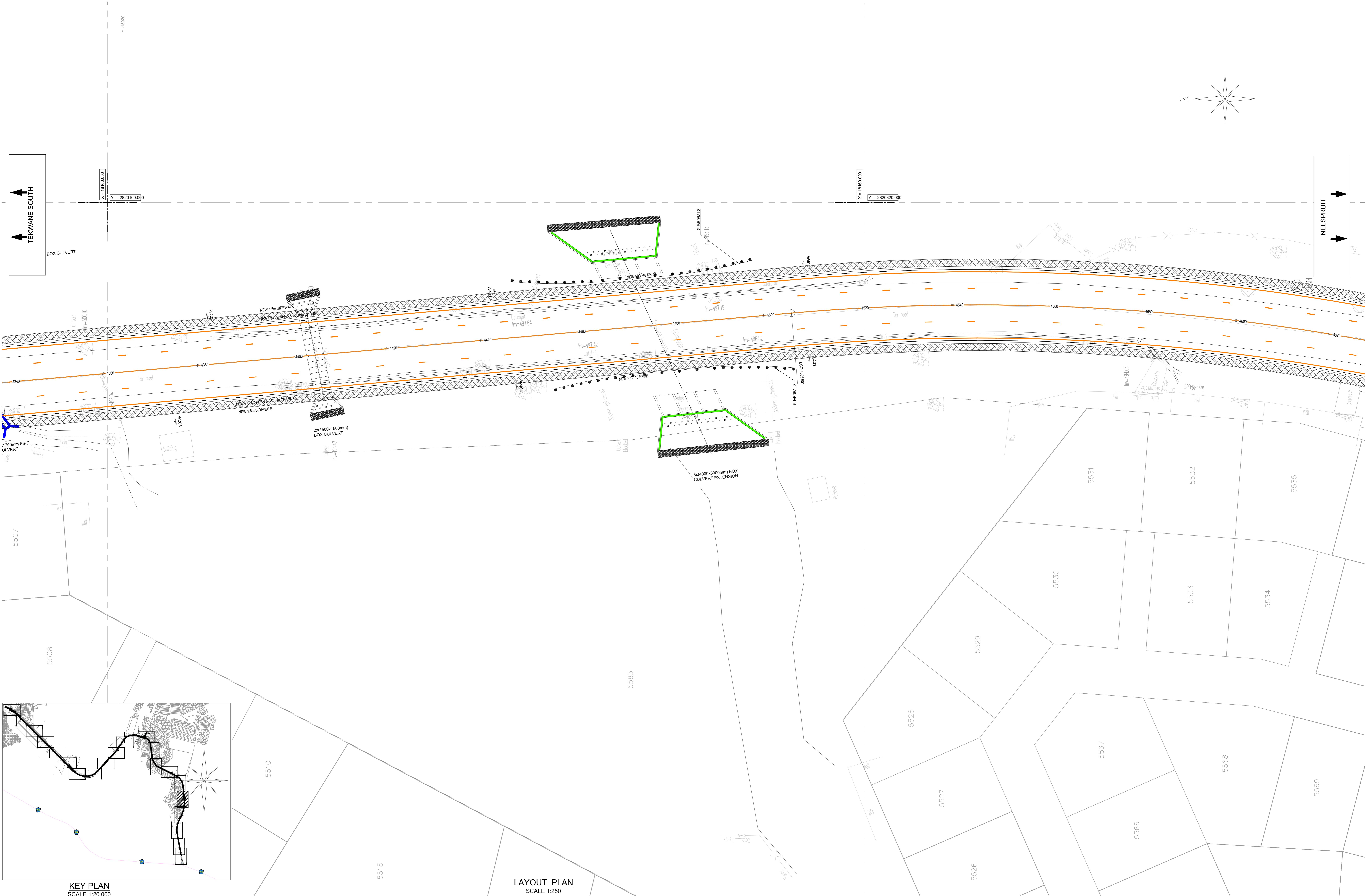
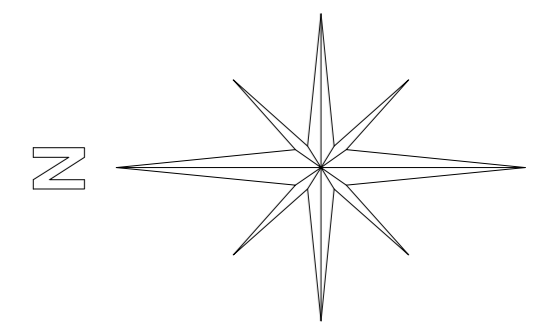

TERKWANE SOUTH

NELSPRUIT

KEY PLAN
SCALE 1:20 000

LAYOUT PLAN
SCALE 1:250

OPGEHEET DEUR / SURVEYED BY _____ DATE/DATUM _____		CONSULTING ENGINEERS - RAADGEWENDE INGENIEURS RASK CONSULTING <small>RASK CONSULTING (Pty) Ltd OFFICE No. 19 ROSEBURY STREET MBOMBELA 1200 TEL: (013) 755-3230 E-MAIL: info@raskconsulting.co.za</small>		B.MALEMONA ONTWERP / DESIGNED F.MURAVHA GETEKEN / DRAWN S. KGOMO NAGESIEN / CHECKED		GOEDGEKEUR / APPROVED Pr. Eng. No. 202202328 ins RAADGEWENDE INGENIEUR for CONSULTING ENGINEER ins HOOF VAN DEPARTEMENT for HEAD OF DEPARTMENT DATE/DATUM 22/05/26		DEPARTMENT: ROADS & TRANSPORT CITY OF MBOMBELA UPGRADING OF D2296 ROAD FROM TERKWANE SOUTH TO KANYAMAZANE (6km)		CITY OF MBOMBELA LOCAL MUNICIPALITY MUNICIPAL BUILDING 1 NEL STREET MBOMBELA CIVIC CENTER MBOMBELA 1200 TEL: (013) 759-2198		SCALE / SKAAL 1:250 (A0)	LEER Nr. / FILE No. _____ DOOREENKOMS Nr. / AGREEMENT No.	DISTRIKT / DISTRICT ENHLANZENI PAD Nr. / ROAD No. D2296	TIEP ONTWERP / TYPE OF PLANNING DETAIL PLAN Nr. / PLAN No. RC-2296-RDS-LY-018
A ISSUED FOR APPROVAL APPROVED GOEDGEKEUR DATE/DATUM 22/05/26		ins HOOF VAN DEPT. for HEAD OF DEPT. DATE/DATUM _____		HANDTEK./SIGNTR. DATE/DATUM _____		DATE/DATUM _____		ROAD & STRUCTURES LAYOUT SHEET 18 OF 22		D2296		RC-2296-RDS-LY-018			

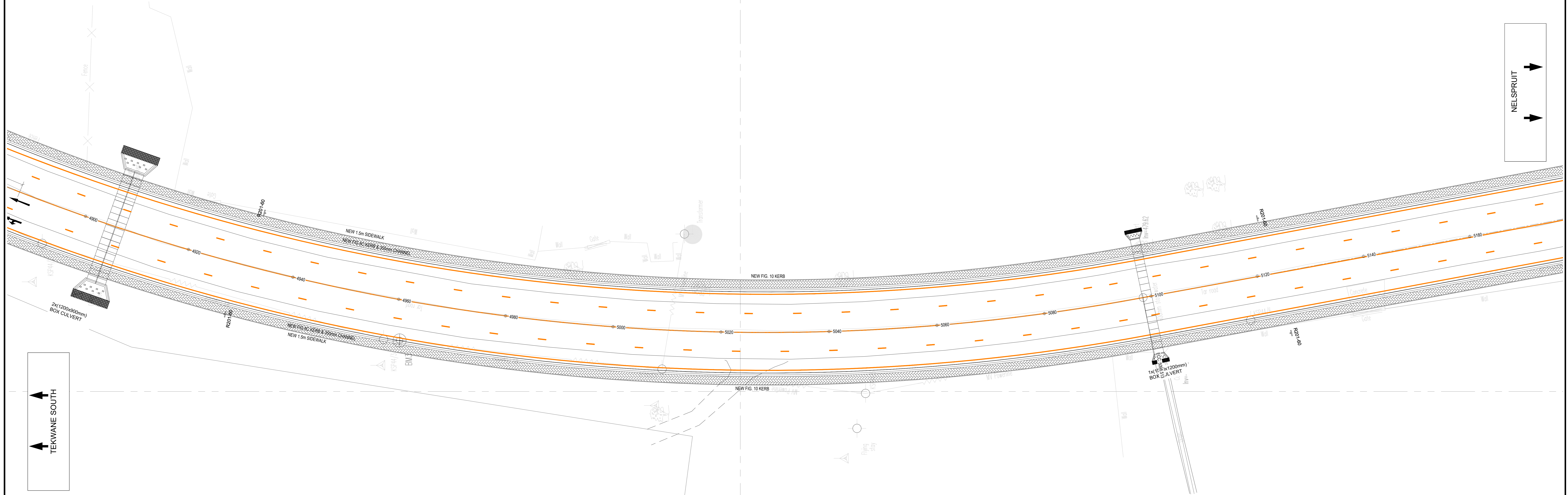
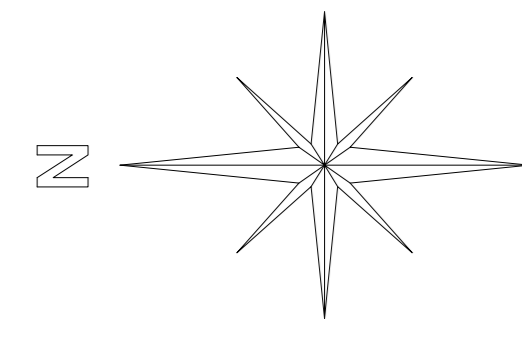

TEKWANE SOUTH

NELSPRUIT

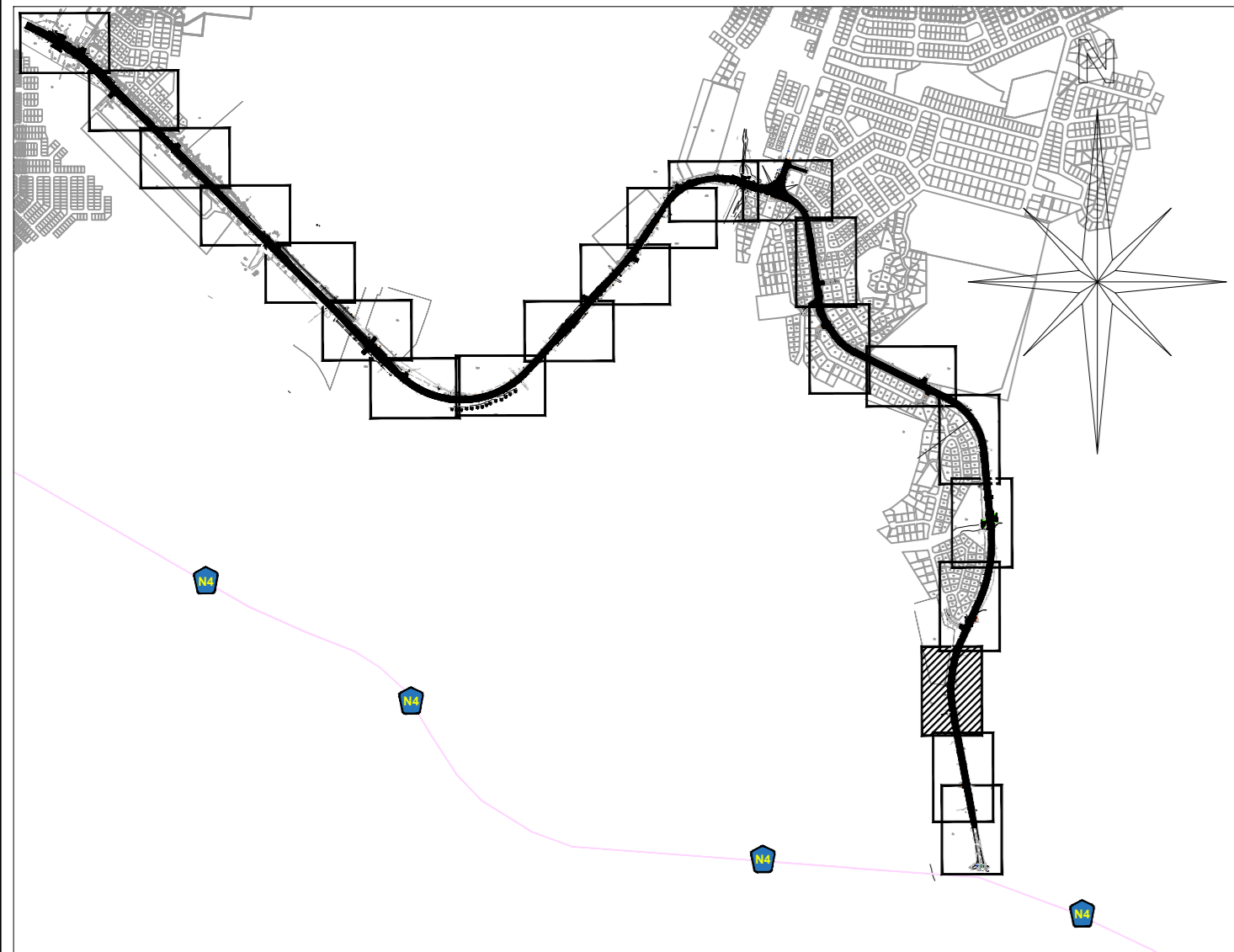

KEY PLAN
SCALE 1:20 000

LAYOUT PLAN
SCALE 1:250

OPGEMET DEUR / SURVEYED BY ADJ. DIR. TEG. DIENSTE DEPT. DIR. TECH. SERVICES OPMETING / SURVEY		CONSULTING ENGINEERS - RAADGEWENDE INGENIEURS RASK CONSULTING RASK CONSULTING (Pty) Ltd OFFICE No. 19 ROSEBURY STREET MBOMBELA 1200 TEL: (013) 755-3230 E-MAIL: info@raskconsulting.co.za		B.MALEMONA ONTWERP / DESIGNED F.MURAVHA GETEKEN / DRAWN S. KGOMO NAGESIEN / CHECKED		GOEDGEKEUR / APPROVED Pr. Eng. No. 202202328 ins RAADGEWENDE INGENIEUR for CONSULTING ENGINEER ins HOOF VAN DEPARTEMENT for HEAD OF DEPARTMENT DATE/DATUM 22/05/26		DEPARTMENT: ROADS & TRANSPORT CITY OF MBOMBELA UPGRADING OF D2296 ROAD FROM TEKWANE SOUTH TO KANYAMAZANE (6km)		CITY OF MBOMBELA LOCAL MUNICIPALITY MUNICIPAL BUILDING 1 NEL STREET MBOMBELA CIVIC CENTER MBOMBELA 1200 TEL: (013) 759-2198		SCALE / SKAAL 1:250 (A0)	LEER Nr. / FILE No. DOOREENKOMS Nr. / AGREEMENT No.	DISTRIKT / DISTRICT ENHLANZENI PAD Nr. / ROAD No. D2296	TYPPE ONTWERP / TYPE OF PLANNING DETAIL PLAN Nr. / PLAN No. RC-2296-RDS-LY-020
A ISSUED FOR APPROVAL REV AMENDMENTS - WYSIGINGS	BM APPROVED GOEDGEKEUR DATE/DATUM	22/05/26 DATE/DATUM	ins HOOF VAN DEPT. for HEAD OF DEPT. DATE/DATUM	DATE/DATUM	HANDTEK./SIGNTR. DATE/DATUM	DATE/DATUM	ROAD & STRUCTURES LAYOUT SHEET 20 OF 22		CITY OF MBOMBELA LOCAL MUNICIPALITY MUNICIPAL BUILDING 1 NEL STREET MBOMBELA CIVIC CENTER MBOMBELA 1200 TEL: (013) 759-2198		SCALE / SKAAL 1:250 (A0)	LEER Nr. / FILE No. DOOREENKOMS Nr. / AGREEMENT No.	DISTRIKT / DISTRICT ENHLANZENI PAD Nr. / ROAD No. D2296	TYPPE ONTWERP / TYPE OF PLANNING DETAIL PLAN Nr. / PLAN No. RC-2296-RDS-LY-020	

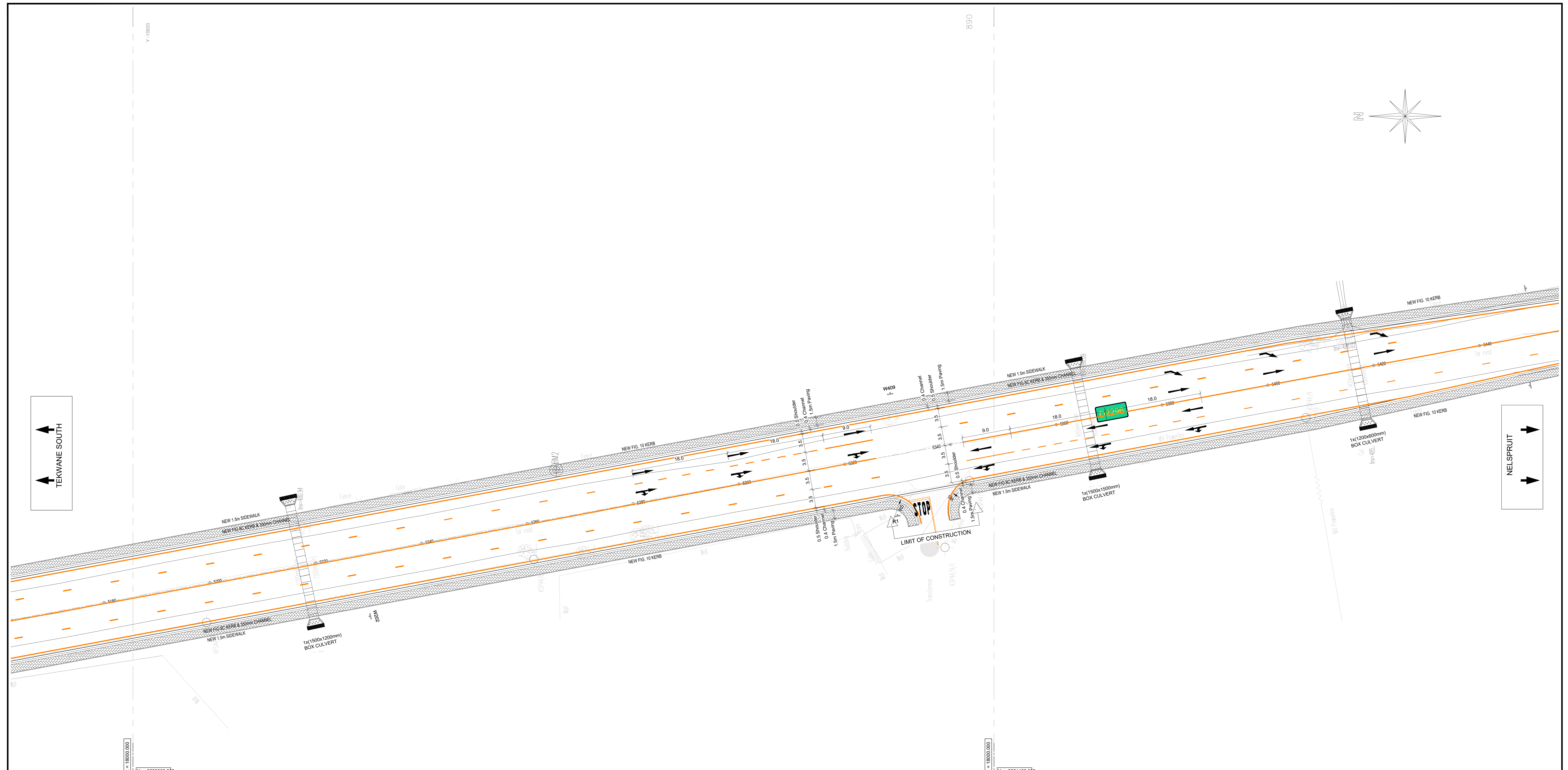
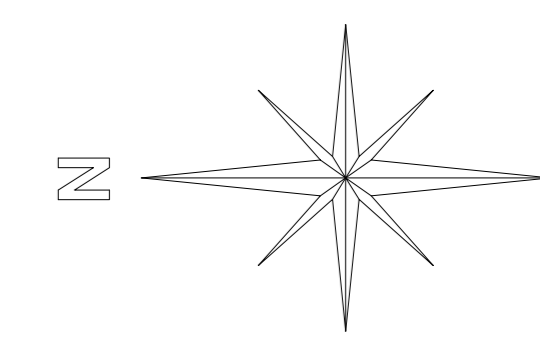

↑
TEKWANE SOUTH

↑
NELSPRUIT

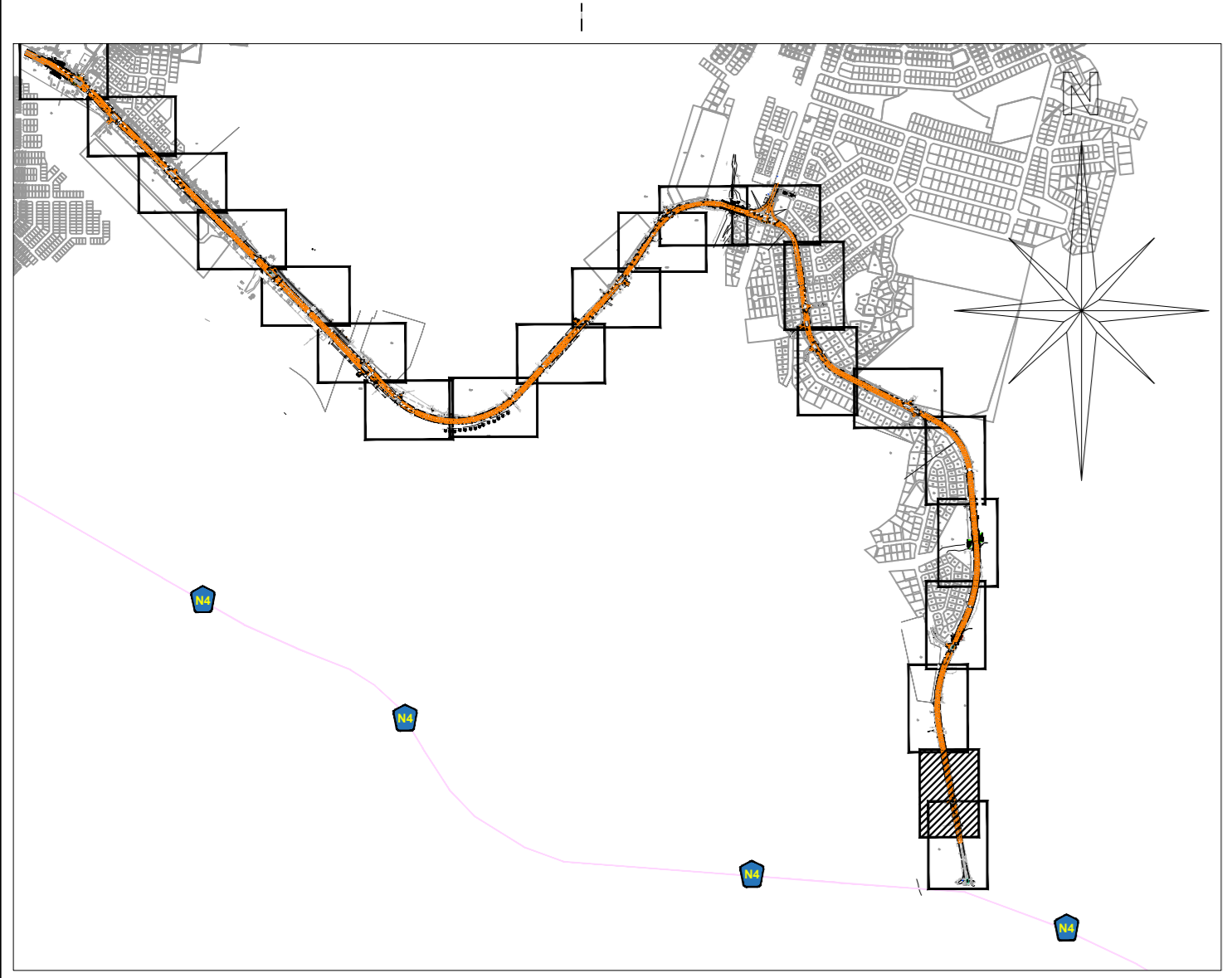

KEY PLAN
SCALE 1:20 000

LAYOUT PLAN
SCALE 1:250

OPGEMET DEUR / SURVEYED BY _____ DATE/DATUM _____		CONSULTING ENGINEERS - RAADGEWENDE INGENIEURS RASK CONSULTING RASK CONSULTING (Pty) LTD OFFICE No. 19 ROSEBURY STREET MBOMBELA 1200 TEL: (013) 755-3230 E-MAIL: info@raskconsulting.co.za		B.MALEMONA ONTWERP / DESIGNED F.MURAVHA GETEKEN / DRAWN S. KGOMO NAGESIEN / CHECKED		GOEDGEKEUR / APPROVED Pr. Eng. No. 202202328 ins RAADGEWENDE INGENIEUR for CONSULTING ENGINEER ins HOOF VAN DEPARTEMENT for HEAD OF DEPARTMENT DATE/DATUM 22/05/26 DATE/DATUM _____		DEPARTMENT: ROADS & TRANSPORT CITY OF MBOMBELA UPGRADING OF D2296 ROAD FROM TEKWANE SOUTH TO KANYAMAZANE (6km)		CITY OF MBOMBELA LOCAL MUNICIPALITY MANCIPAL BULIDING 1 NEL STREET MBOMBELA CIVIC CENTER MBOMBELA 1200 TEL: (013) 759-2198		SCALE / SKAAL 1:250 (AO)		LEER Nr. / FILE No. _____ DOOREENKOMS Nr. / AGREEMENT No. _____		DISTRIKT / DISTRICT ENHLANZENI PAD Nr. / ROAD No. D2296		TIEP ONTWERP / TYPE OF PLANNING DETAIL PLAN Nr. / PLAN No. RC-2296-RDS-LY-021	
A ISSUED FOR APPROVAL BM 22/05/26		APPROVED GOEDGEKEUR DATE/DATUM 22/05/26		ins HOOF VAN DEPT. for HEAD OF DEPT. DATE/DATUM _____		HANDTEK./SIGNTR. DATE/DATUM _____		DATE/DATUM _____		CITY OF MBOMBELA THE ULTIMATE DESTINATION		DISTRIKT / DISTRICT ENHLANZENI		TIEP ONTWERP / TYPE OF PLANNING DETAIL					

