



public works  
& infrastructure

Department:  
Public Works and Infrastructure  
**REPUBLIC OF SOUTH AFRICA**

DEPARTMENT OF PUBLIC WORKS AND INFRASTRUCTURE  
DURBAN REGIONAL OFFICE

**REFERENCE NUMBER – DBN26/07/01**

**SERVICE DESCRIPTION: NDPWI DURBAN: SUPPLY AND DELIVERY(INCLUDING INSTALLATION) OF OFFICE FURNITURE- NO:05 KESINGTON BOULEVARD KINGSMEAD- DURBAN REGIONAL OFFICE**

**SUBMITTED BY:**

Company Name : .....

CSD / CIDB registration number: ...../.....

Physical Address: \_\_\_\_\_  
\_\_\_\_\_  
\_\_\_\_\_  
\_\_\_\_\_

Postal Address: \_\_\_\_\_  
\_\_\_\_\_  
\_\_\_\_\_  
\_\_\_\_\_

Contact No. \_\_\_\_\_

Email \_\_\_\_\_

**CLOSING DATE: 28 July 2026**

**TENDER BOX LOCATION: National Department of Public Works, 157 Monty Naicker, Durban, 4001 and / box number: tender number will be labelled to the box DBN26/07/01**

**Enquiries:** For technical enquiries contact Mr. Anele Madyantyi Mobile number: 0313147139/ 0828148681, e-mail [Anele.madyantyi@dpw.gov.za](mailto:Anele.madyantyi@dpw.gov.za) and for other enquiries contact Ms. Nobuhle Gwala Telephone number – 0313147021/0713808247 or e-mail [Nobuhle.Gwala@dpw.gov.za](mailto:Nobuhle.Gwala@dpw.gov.za)

**YOU ARE HEREBY INVITED TO BID TO THE GOVERNMENT OF THE REPUBLIC OF SOUTH AFRICA**

**PLEASE TAKE NOTE:**

**BID NUMBER: DBN26/07/01  
ADVERT DATE: 03 JULY 2026  
CLOSING DATE: 28 JULY 2026**

**CLOSING TIME: 11:00**

**SITE MEETING DATE: 15 JULY 2026 @ 11:00 am (NO:05 KESINGTON BOULEVARD KINGSMEAD DURBAN)**

**CLIENT: NDPWI DURBAN: SUPPLY AND DELIVERY (INCLUDING INSTALLATION) OF OFFICE FURNITURE: 05 KESINGTON BOULEVARD KINGSMEAD DURBAN REGIONAL OFFICE**

***BIDS RECEIVED AFTER THE CLOSING TIME AND DATE ARE LATE AND WILL, AS A RULE NOT BE ACCEPTED FOR CONSIDERATION***

The Tax Clearance Certificate for Bid Purposes from the Receiver of Revenue and the NDPWI GS SBD3.1 Pricing Schedule- firm prices must be completed and signed in the original that is in ink. Forms with photocopied signatures or other such reproduction of signatures may be rejected.

**BID DOCUMENTS MAY BE DELIVERED TO**

DEPARTMENT OF PUBLIC WORKS AND INFRASTRUCTURE  
157 MONTY NAICKER  
DURBAN  
4001

Bid documents that are posted must reach the Department of Public Works before 11:00 on the closing date of the bid/quote.

**OR**

THE BID DOCUMENTS MAY BE DEPOSITED IN AN ALLOCATED BID BOX BY ENTRANCE, CNR PINE STREET (MONTY NAICKER) AND ALIWAL (SAMORA MACHEL) STREET, DURBAN

	S A M O R A	
	M A C H E L	NATIONAL DEPARTMENT OF PUBLIC WORKS & INFRASTRUCTURE
MONTY		NAICKER

**Project Leader: Mr. Anele Madyantyi (031 314 7139/082 814 861)**

**Administrative Enquiries: Ms Nobuhle Gwala (031 314 7021/ 071 380 8247)**

The Durban Regional Office of the Department of Public Works is open **Mondays to Fridays: 07:30 – 12:45 / 13:30 – 16:00.**

**NB.: Late Bids/Quotes will, as a rule will NOT be accepted for consideration.**

*Bidders should ensure that bids are delivered timeously to the correct address.*

**SUBMIT ALL BIDS ON THE OFFICIAL FORMS - DO NOT RETYPE.**

*Bids by telegram, facsimile or other similar apparatus will not be accepted for consideration.*

**SUBMIT EACH BID IN A SEPARATE SEALED ENVELOPE WITH BID/QUOTE NUMBER & CLOSING DATE CLEARLY MARKED.**

The Tender Document is available on the following web sites:

1. <http://www.publicworks.gov.za>
2. <http://www.etenders.gov.za>



## PART A PA 32: INVITATION TO BID

<b>YOU ARE HEREBY INVITED TO BID FOR REQUIREMENTS OF THE DEPARTMENT OF PUBLIC WORKS AND INFRASTRUCTURE</b>				
BID NUMBER:	DBN26/07/01	CLOSING DATE:	28 JULY 2026	CLOSING TIME: 11h00am
DESCRIPTION	NDPWI DURBAN: SUPPLY AND DELIVERY (INCLUDING INSTALLATION) OF OFFICE FURNITURE - NO: 05 KESINGTON BOULEVARD KINGSMEAD - DURBAN REGIONAL OFFICE			
<b>BID RESPONSE DOCUMENTS MAY BE DEPOSITED IN THE BID BOX SITUATED AT (STREET ADDRESS)</b>				
<b>NDPWI DURBAN REGIONAL OFFICE, DEPOSITED TO TENDER BOX LABELLED DBN26/02/02</b>				
<b>157 Monty Naicker Road, by Securities. (bidders to note that entrance in Dr Pixley Ka Seme is temporarily closed)</b>				

<b>BIDDING PROCEDURE ENQUIRIES MAY BE DIRECTED TO:</b>		<b>TECHNICAL ENQUIRIES MAY BE DIRECTED TO:</b>	
CONTACT PERSON	NOBUHLE GWALA	CONTACT PERSON	ANELE MADYANTYI
TELEPHONE NUMBER	071 380 8247	TELEPHONE NUMBER	082 814 8681
FACSIMILE NUMBER		FACSIMILE NUMBER	
E-MAIL ADDRESS	Nobuhle.Gwala@dpw.gov.za	E-MAIL ADDRESS	Anele.Madyantyi@dpw.gov.za

<b>SUPPLIER INFORMATION</b>					
NAME OF BIDDER					
POSTAL ADDRESS					
STREET ADDRESS					
TELEPHONE NUMBER	CODE		NUMBER		
CELLPHONE NUMBER					
FACSIMILE NUMBER	CODE		NUMBER		
E-MAIL ADDRESS					
VAT REGISTRATION NUMBER					
SUPPLIER COMPLIANCE STATUS	TAX COMPLIANCE SYSTEM PIN:		OR	CENTRAL SUPPLIER DATABASE No:	MAAA
ARE YOU THE ACCREDITED REPRESENTATIVE IN SOUTH AFRICA FOR THE GOODS /SERVICES OFFERED?	<input type="checkbox"/> Yes <input type="checkbox"/> No [IF YES ENCLOSE PROOF]		ARE YOU A FOREIGN BASED SUPPLIER FOR THE GOODS /SERVICES OFFERED?	<input type="checkbox"/> Yes <input type="checkbox"/> No [IF YES, ANSWER THE QUESTIONNAIRE BELOW]	

<b>QUESTIONNAIRE TO BIDDING FOREIGN SUPPLIERS</b>	
IS THE ENTITY A RESIDENT OF THE REPUBLIC OF SOUTH AFRICA (RSA)?	<input type="checkbox"/> YES <input type="checkbox"/> NO
DOES THE ENTITY HAVE A BRANCH IN THE RSA?	<input type="checkbox"/> YES <input type="checkbox"/> NO
DOES THE ENTITY HAVE A PERMANENT ESTABLISHMENT IN THE RSA?	<input type="checkbox"/> YES <input type="checkbox"/> NO
DOES THE ENTITY HAVE ANY SOURCE OF INCOME IN THE RSA?	<input type="checkbox"/> YES <input type="checkbox"/> NO
IS THE ENTITY LIABLE IN THE RSA FOR ANY FORM OF TAXATION?	<input type="checkbox"/> YES <input type="checkbox"/> NO
IF THE ANSWER IS "NO" TO ALL OF THE ABOVE, THEN IT IS NOT A REQUIREMENT TO REGISTER FOR A TAX COMPLIANCE STATUS SYSTEM PIN CODE FROM THE SOUTH AFRICAN REVENUE SERVICE (SARS) AND IF NOT REGISTER AS PER 2.3 BELOW.	



## PART B TERMS AND CONDITIONS FOR BIDDING

### 1. BID SUBMISSION:

- 1.1. BIDS MUST BE DELIVERED BY THE STIPULATED TIME TO THE CORRECT ADDRESS. LATE BIDS WILL NOT BE ACCEPTED FOR CONSIDERATION.
- 1.2. **ALL BIDS MUST BE SUBMITTED ON THE OFFICIAL FORMS PROVIDED (NOT TO BE RE-TYPED) OR IN THE MANNER PRESCRIBED IN THE BID DOCUMENT.**
- 1.3. THIS BID IS SUBJECT TO THE PREFERENTIAL PROCUREMENT POLICY FRAMEWORK ACT, 2000 AND THE PREFERENTIAL PROCUREMENT REGULATIONS, THE GENERAL CONDITIONS OF CONTRACT (GCC) AND, IF APPLICABLE, ANY OTHER SPECIAL CONDITIONS OF CONTRACT.
- 1.4. **THE SUCCESSFUL BIDDER WILL BE REQUIRED TO FILL IN AND SIGN A WRITTEN CONTRACT FORM (SBD7).**

### 2. TAX COMPLIANCE REQUIREMENTS

- 2.1 BIDDERS MUST ENSURE COMPLIANCE WITH THEIR TAX OBLIGATIONS.
- 2.2 BIDDERS ARE REQUIRED TO SUBMIT THEIR UNIQUE PERSONAL IDENTIFICATION NUMBER (PIN) ISSUED BY SARS TO ENABLE THE ORGAN OF STATE TO VERIFY THE TAXPAYER'S PROFILE AND TAX STATUS.
- 2.3 APPLICATION FOR TAX COMPLIANCE STATUS (TCS) PIN MAY BE MADE VIA E-FILING THROUGH THE SARS WEBSITE WWW.SARS.GOV.ZA.
- 2.4 BIDDERS MAY ALSO SUBMIT A PRINTED TCS CERTIFICATE TOGETHER WITH THE BID.
- 2.5 IN BIDS WHERE CONSORTIA / JOINT VENTURES / SUB-CONTRACTORS ARE INVOLVED; EACH PARTY MUST SUBMIT A SEPARATE TCS CERTIFICATE / PIN / CSD NUMBER.
- 2.6 WHERE NO TCS PIN IS AVAILABLE BUT THE BIDDER IS REGISTERED ON THE CENTRAL SUPPLIER DATABASE (CSD), A CSD NUMBER MUST BE PROVIDED.
- 2.7 NO BIDS WILL BE CONSIDERED FROM PERSONS IN THE SERVICE OF THE STATE, COMPANIES WITH DIRECTORS WHO ARE PERSONS IN THE SERVICE OF THE STATE, OR CLOSE CORPORATIONS WITH MEMBERS PERSONS IN THE SERVICE OF THE STATE."

**NB: FAILURE TO PROVIDE / OR COMPLY WITH ANY OF THE ABOVE PARTICULARS MAY RENDER THE BID INVALID.**

SIGNATURE OF BIDDER: .....

CAPACITY UNDER WHICH THIS BID IS SIGNED: .....  
(Proof of authority must be submitted e.g. company resolution)

DATE: .....







## PA-04 (GS): NOTICE AND INVITATION TO BID

THE DEPARTMENT OF PUBLIC WORKS INVITES BIDDERS FOR THE PROVISION OF SUPPLY AND DELIVERY (INCLUDING INSTALLATION) OF OFFICE FURNITURE

<b>Project title:</b>	NDPWI DURBAN: SUPPLY AND DELIVERY (INCLUDING INSTALLATION) OF OFFICE FURNITURE - NO: 05 KESINGTON BOULEVARD KINGSMEAD - DURBAN REGIONAL OFFICE
-----------------------	--

<b>Bid no:</b>	DBN26/07/01		
<b>Advertising date:</b>	03 JULY 2026	<b>Closing date:</b>	28 JULY 2026
<b>Closing time:</b>	11h00am	<b>Validity period:</b>	84 days

1. FUNCTIONALITY CRITERIA APPLICABLE YES  NO

**Note 1:** Failure to meet minimum functionality score will result in the tenderer being disqualified.

Functionality criteria: <sup>1</sup>	Weighting factor:												
<p>Completed Successful Project : Experience</p> <p>NB: Bidder to submit the following copies for evaluation:</p> <p>a) Signed award letter or Appointment letter or Order with start date and end date, tender number or work reference number, type of service rendered, area/site of rendered service and contract value all with traceable reference (Projects within the last 5 years from closing date of tender)</p> <p>And</p> <p>b) A completion certificate, it must be aligned with above bullet (a) stating completion date, type of service rendered signed by the clients delegated authority or project manager with traceable references. (Projects within the last 5 years from the closing date of tender)</p> <p>Successful supply and delivery (including installation) of office furniture projects within the following value:</p> <table> <tr> <td>(i) R 4 500 000,01 and above</td> <td>=</td> <td>5/5 ( 50 points)</td> </tr> <tr> <td>(ii) R 3 500 000,01 - R 4 500 000,00</td> <td>=</td> <td>4/5 (40 points)</td> </tr> <tr> <td>(iii) R 2 500 000,01 - R 3 500 000,00</td> <td>=</td> <td>3/5 (30 points)</td> </tr> <tr> <td>(iv) R 2 500 000,00 and below</td> <td>=</td> <td>0/5 (0 points)</td> </tr> </table> <p>The above will be evaluated on EACH successful project completed.</p> <p>Highest project that meets above requirements will be considered for evaluation.</p> <p>NB: The submitted information will be subjected to verification during the evaluation process.</p>	(i) R 4 500 000,01 and above	=	5/5 ( 50 points)	(ii) R 3 500 000,01 - R 4 500 000,00	=	4/5 (40 points)	(iii) R 2 500 000,01 - R 3 500 000,00	=	3/5 (30 points)	(iv) R 2 500 000,00 and below	=	0/5 (0 points)	50
(i) R 4 500 000,01 and above	=	5/5 ( 50 points)											
(ii) R 3 500 000,01 - R 4 500 000,00	=	4/5 (40 points)											
(iii) R 2 500 000,01 - R 3 500 000,00	=	3/5 (30 points)											
(iv) R 2 500 000,00 and below	=	0/5 (0 points)											

<sup>1</sup>The points allocated to each functionality criterion should not be generic but should be determined separately for each tender on a case by case basis.

<p>Financial Standing (Company Bank Statement/ Credit) from Financial Institutions</p> <p>Submission of Stamped Company bank statement or Credit not older than (3) month from the closing date reflecting available balance.</p> <p>Company bank statement / Credit or Company bank statement and Credit @ R 3 000 000.00 and above = 5/5 (50 points)</p> <p>Company bank statement / Credit or Company bank statement and Credit @ R 2500 000.00 up to less than R 3000 000.00 = 4/5 (40 points)</p> <p>Company bank statement / Credit or Company bank statement and Credit @ R 2000 000.00 up to less than R 2500 000.00 = 3/5 (30 points)</p> <p>NB: The submitted information will be subjected to verification during the evaluation process</p>	50
<b>Total</b>	<b>100 Points</b>

*(Weightings will be multiplied by the scores allocated during the evaluation process to arrive at the total functionality points)*

<b>Minimum functionality score to qualify for further evaluation:</b>	70
---	----

*(Total minimum qualifying score for functionality is 50 percent, any deviation below or above the 50 percent, provide motivation below).*

Competent service provider is required to ensure timous delivery of the required service.

**2. THE FOLLOWING EVALUATION METHOD FOR RESPONSIVE BIDS WILL BE APPLICABLE:**

<input type="checkbox"/> Method 1 (Financial offer)	<input checked="" type="checkbox"/> Method 2 (Financial and Preference offer)
---	---

**2.1. Indicate which preference points scoring system is applicable for this bid:**

<input checked="" type="checkbox"/> <b>80/20</b> Preference points scoring system	<input type="checkbox"/> <b>90/10</b> Preference points scoring system	<input type="checkbox"/> <b>Either 80/20 or 90/10</b> Preference points scoring system
---	--	--

### 3. RESPONSIVENESS CRITERIA

**3.1. Indicate substantive responsiveness criteria applicable for this tender. Failure to comply with the criteria stated hereunder shall result in the tender offer being disqualified from further consideration:**

1	<input checked="" type="checkbox"/>	Only those tenderers who satisfy the eligibility criteria stated in the Tender Data may submit tenders.
2	<input checked="" type="checkbox"/>	Tender offer must be properly received on the tender closing date and time specified on the invitation, fully completed either electronically (if issued in electronic format), or by writing legibly in non-erasable ink. (All as per Standard Conditions of Tender).
3	<input checked="" type="checkbox"/>	All parts of tender documents submitted must be fully completed in ink and signed where required
4	<input checked="" type="checkbox"/>	Use of correction fluid is prohibited.
5	<input type="checkbox"/>	Submission of PA-32: Invitation to Bid
6	<input checked="" type="checkbox"/>	Submission of record of attending compulsory briefing session. To physically inspect where the office furniture will be supplied and installed and to explain the furniture specifications and functionality requirements
7	<input checked="" type="checkbox"/>	Submission of fully completed (SBD 3.1) pricing schedule firm prices (Purchases)
8	<input checked="" type="checkbox"/>	Bidders must comply with the communication for addendum from the tender document if applicable.
9	<input checked="" type="checkbox"/>	Bidders are required to provide a sample for the Cherry Laminate / Veneer or Similar. (samples must be in 180mm:120mm in size)
10	<input type="checkbox"/>	<b><i>Specify other responsiveness criteria</i></b>
11	<input type="checkbox"/>	<b><i>Specify other responsiveness criteria</i></b>

**3.2. Indicate administrative requirements applicable for this tender. Tenderers may be required to submit the below documents where applicable.**

The Employer reserves the right to request further information regarding the undermentioned criteria. Failing to submit further clarification and/or documentation within seven (7) calendar days from request or as specifically indicated, will disqualify the tender offer from further consideration.

1	<input checked="" type="checkbox"/>	Any correction to be initialled by the person authorised to sign the tender documentation as per PA 15.1 or PA 15.2 resolution of board/s of directors / or PA15.3 Special Resolution of Consortia or JV's .
2	<input checked="" type="checkbox"/>	Submission of applicable (PA-15.1, PA-15.2, PA-15.3): Resolution by the legal entity, or consortium / joint venture, authorising a dedicated person(s) to sign documents on behalf of the firm / consortium / joint venture.
3	<input checked="" type="checkbox"/>	Submission of (PA-11): Bidder's disclosure.
4	<input checked="" type="checkbox"/>	Submission of (PA 40): Declaration of Designated Groups for Preferential Procurement.
5	<input checked="" type="checkbox"/>	Submission of proof of Registration on National Treasury's Central Supplier Database (CSD) or insert the Supplier Registration Number on the form of offer
6	<input type="checkbox"/>	Upon request, submission of a fully completed security clearance application form with supporting documentation and information as required. The security clearance form will be provided by the Employer for projects requiring a security clearance.
7	<input checked="" type="checkbox"/>	Submission of PA-32: Invitation to Bid
8	<input type="checkbox"/>	<b><i>Specify other responsiveness criteria</i></b>
9	<input type="checkbox"/>	<b><i>Specify other responsiveness criteria</i></b>
10	<input type="checkbox"/>	<b><i>Specify other responsiveness criteria</i></b>

**3.3. Indicate administrative requirements applicable for specific goals, Tenderers will not be required to submit the below document if not provided in the original tender proposals, Failure to comply with the criteria stated hereunder shall result in the tenderer not allocated points for specific goals:**

1	<input checked="" type="checkbox"/>	Submission of (PA-16): Preference Points Claim Form in terms of the Preferential Procurement Regulations 2022
2	<input checked="" type="checkbox"/>	A trust, consortium or joint venture (including unincorporated consortia and joint ventures) must submit a consolidated B-BBEE Certificate issued by a SANAS accredited service provider

**4. METHOD TO BE USED TO CALCULATE POINTS FOR SPECIFIC GOALS**

<input checked="" type="checkbox"/>	<p><b><u>4.1. For procurement transaction with rand value greater than R1 Million and up to R50 Million (Inclusive of all applicable taxes) the specific goals listed in table 1 below are applicable.</u></b></p> <p><b><u>Table 1</u></b></p> <table border="1"> <thead> <tr> <th>Serial No</th> <th>Specific Goals</th> <th>Preference Points Allocated out of 20</th> <th>Documentation to be submitted by bidders to validate their claim</th> </tr> </thead> <tbody> <tr> <td style="text-align: center;">1.</td> <td>An EME or QSE or any entity which is at least 51% owned by black people (Mandatory)</td> <td style="text-align: center;">10</td> <td> <ul style="list-style-type: none"> <li>• SANAS Accredited BBBEE Certificate or Sworn Affidavit where applicable.</li> </ul> </td> </tr> <tr> <td style="text-align: center;">2.</td> <td>Located in a specific Local Municipality or District Municipality or Metro or Province area for work to be done or services to be rendered in that area (Mandatory)</td> <td style="text-align: center;">2</td> <td> <ul style="list-style-type: none"> <li>• Official Municipal Rates Statement which is in the name of the bidder.</li> </ul> <p>Or</p> <ul style="list-style-type: none"> <li>• Any account or statement which is in the name of the bidder.</li> </ul> <p>Or</p> <ul style="list-style-type: none"> <li>• Permission to Occupy from local chief in case of rural areas (PTO) which is in the name of the bidder.</li> </ul> <p>Or</p> <ul style="list-style-type: none"> <li>• Lease Agreement which is in the name of the bidder.</li> </ul> </td> </tr> <tr> <td style="text-align: center;">3.</td> <td>An EME or QSE or any entity which is at least 51% owned by black women (Mandatory)</td> <td style="text-align: center;">4</td> <td> <ul style="list-style-type: none"> <li>• SANAS Accredited BBBEE Certificate or Sworn Affidavit where applicable.</li> </ul> </td> </tr> <tr> <td style="text-align: center;">4.</td> <td>An EME or QSE or any entity which is at least 51% owned by black people with disability (Mandatory)</td> <td style="text-align: center;">2</td> <td> <ul style="list-style-type: none"> <li>• SANAS Accredited BBBEE Certificate or Sworn Affidavit where applicable.</li> </ul> <p>and</p> <ul style="list-style-type: none"> <li>• Medical Certificate indicating that the disability is permanent.</li> </ul> <p>Or</p> </td> </tr> </tbody> </table>			Serial No	Specific Goals	Preference Points Allocated out of 20	Documentation to be submitted by bidders to validate their claim	1.	An EME or QSE or any entity which is at least 51% owned by black people (Mandatory)	10	<ul style="list-style-type: none"> <li>• SANAS Accredited BBBEE Certificate or Sworn Affidavit where applicable.</li> </ul>	2.	Located in a specific Local Municipality or District Municipality or Metro or Province area for work to be done or services to be rendered in that area (Mandatory)	2	<ul style="list-style-type: none"> <li>• Official Municipal Rates Statement which is in the name of the bidder.</li> </ul> <p>Or</p> <ul style="list-style-type: none"> <li>• Any account or statement which is in the name of the bidder.</li> </ul> <p>Or</p> <ul style="list-style-type: none"> <li>• Permission to Occupy from local chief in case of rural areas (PTO) which is in the name of the bidder.</li> </ul> <p>Or</p> <ul style="list-style-type: none"> <li>• Lease Agreement which is in the name of the bidder.</li> </ul>	3.	An EME or QSE or any entity which is at least 51% owned by black women (Mandatory)	4	<ul style="list-style-type: none"> <li>• SANAS Accredited BBBEE Certificate or Sworn Affidavit where applicable.</li> </ul>	4.	An EME or QSE or any entity which is at least 51% owned by black people with disability (Mandatory)	2	<ul style="list-style-type: none"> <li>• SANAS Accredited BBBEE Certificate or Sworn Affidavit where applicable.</li> </ul> <p>and</p> <ul style="list-style-type: none"> <li>• Medical Certificate indicating that the disability is permanent.</li> </ul> <p>Or</p>
Serial No	Specific Goals	Preference Points Allocated out of 20	Documentation to be submitted by bidders to validate their claim																				
1.	An EME or QSE or any entity which is at least 51% owned by black people (Mandatory)	10	<ul style="list-style-type: none"> <li>• SANAS Accredited BBBEE Certificate or Sworn Affidavit where applicable.</li> </ul>																				
2.	Located in a specific Local Municipality or District Municipality or Metro or Province area for work to be done or services to be rendered in that area (Mandatory)	2	<ul style="list-style-type: none"> <li>• Official Municipal Rates Statement which is in the name of the bidder.</li> </ul> <p>Or</p> <ul style="list-style-type: none"> <li>• Any account or statement which is in the name of the bidder.</li> </ul> <p>Or</p> <ul style="list-style-type: none"> <li>• Permission to Occupy from local chief in case of rural areas (PTO) which is in the name of the bidder.</li> </ul> <p>Or</p> <ul style="list-style-type: none"> <li>• Lease Agreement which is in the name of the bidder.</li> </ul>																				
3.	An EME or QSE or any entity which is at least 51% owned by black women (Mandatory)	4	<ul style="list-style-type: none"> <li>• SANAS Accredited BBBEE Certificate or Sworn Affidavit where applicable.</li> </ul>																				
4.	An EME or QSE or any entity which is at least 51% owned by black people with disability (Mandatory)	2	<ul style="list-style-type: none"> <li>• SANAS Accredited BBBEE Certificate or Sworn Affidavit where applicable.</li> </ul> <p>and</p> <ul style="list-style-type: none"> <li>• Medical Certificate indicating that the disability is permanent.</li> </ul> <p>Or</p>																				

			<ul style="list-style-type: none"> <li>South African Social Security Agency (SASSA) Registration indicating that the disability is permanent.</li> </ul> <p>Or</p> <p>National Council for Persons with Physical Disability in South Africa registration (NCPDPSA).</p>
5.	An EME or QSE or any entity which is at least 51% owned by black youth (Mandatory)	2	<ul style="list-style-type: none"> <li>ID copy and SANAS Accredited BBBEE Certificate or Sworn Affidavit where applicable.</li> </ul>



**4.2. For procurement transaction with rand value greater than R50 Million (Inclusive of all applicable taxes) the specific goals listed in table 2 below are applicable.**

**NB. The use of one of goal numbers' 4 or 5 is mandatory. The BSC must select either one of the two, but not both.**

**Table 2**

Serial No	Specific Goals	Preference Points Allocated out of 10	Documentation to be submitted by bidders to validate their claim
1.	An EME or QSE or any entity which is at least 51% owned by black people (Mandatory)	4	<ul style="list-style-type: none"> <li>SANAS Accredited BBBEE Certificate or Sworn Affidavit where applicable.</li> </ul>
2.	Located in a specific Local Municipality or District Municipality or Metro or Province area for work to be done or services to be rendered in that area (Mandatory)	2	<ul style="list-style-type: none"> <li>Official Municipal Rates Statement which is in the name of the bidder.</li> </ul> <p>Or</p> <ul style="list-style-type: none"> <li>Any account or statement which is in the name of the bidder.</li> </ul> <p>Or</p> <ul style="list-style-type: none"> <li>Permission to Occupy from local chief in case of rural areas (PTO) which is in the name of the bidder.</li> </ul> <p>Or</p> <ul style="list-style-type: none"> <li>Lease Agreement which is in the name of the bidder.</li> </ul>
3.	An EME or QSE or any entity which is at least 51% owned by black women (mandatory)	2	<ul style="list-style-type: none"> <li>SANAS Accredited BBBEE Certificate or Sworn Affidavit where applicable.</li> </ul>

<b>OR</b>	4. <input type="checkbox"/>	An EME or QSE or any entity which is at least 51% owned by black people with disability (Mandatory)	2	<ul style="list-style-type: none"> <li>• SANAS Accredited BBBEE Certificate or Sworn Affidavit where applicable.</li> </ul> <p>and</p> <ul style="list-style-type: none"> <li>• Medical Certificate indicating that the disability is permanent.</li> </ul> <p>Or</p> <ul style="list-style-type: none"> <li>• South African Social Security Agency (SASSA) Registration indicating that the disability is permanent.</li> </ul> <p>Or</p> <p>National Council for Persons with Physical Disability in South Africa registration (NCPDPSA).</p>
	5. <input type="checkbox"/>	An EME or QSE or any entity which is at least 51% owned by black youth (Mandatory)	2	<ul style="list-style-type: none"> <li>• ID Copy and SANAS Accredited BBBEE Certificate or Sworn Affidavit where applicable</li> </ul>

**5. COLLECTION OF BID DOCUMENTS:**

- Bid documents are available for free download on e-Tender portal [www.etenders.gov.za](http://www.etenders.gov.za)
- Alternatively; Bid documents may be collected during working hours at the following address . A non-refundable bid deposit of R 0 is payable, (Cash only) is required on collection of the bid documents.
- A **compulsory** pre bid meeting with representatives of the Department of Public Works will take place at NO: 05 KESINGTON BOULEVARD KINGSMEAD DURBAN on 15 JULY 2026 starting at 11h00am. Venue GROUND FLOOR PARKING AREA; NO: 05 KESINGTON BOULEVARD KINGSMEAD DURBAN. (if applicable)

**6. ENQUIRIES**

6.1. Technical enquiries may be addressed to:

<b>DPWI Project Manager</b>	Mr AS Madyantyi	<b>Telephone no:</b>	031 314 7139
<b>Cellular phone no</b>	082 814 8681	<b>Fax no:</b>	
<b>E-mail</b>	Anele.Madyantyi@dpw.gov.za		

6.2. SCM enquiries may be addressed to:

<b>SCM Official</b>	Ms Nobuhle Gwala	<b>Telephone no:</b>	031 314 7021
<b>Cellular phone no</b>	071 380 8247	<b>Fax no:</b>	
<b>E-mail</b>	Nobuhle.Gwala@dpw.gov.za		

**7. DEPOSIT / RETURN OF BID DOCUMENTS:**

Telegraphic, telephonic, telex, facsimile, electronic and / or late tenders will not be accepted.

Requirements for sealing, addressing, delivery, opening and assessment of tenders are stated in the bid document.

All tenders must be submitted on the official forms

<p><b>BID DOCUMENTS MAY BE POSTED TO:</b></p> <p>THE DIRECTOR -GENERAL DEPARTMENT OF PUBLIC WORKS PRIVATE BAG X 157 MONTY NAICKER ROAD DURBAN</p> <p>4001 ATTENTION: <b>PROCUREMENT SECTION: ROOM</b></p> <p><i>POSTED TENDERS MUST BE RECEIVED PRIOR CLOSING DATE AND TIME AT 11H00 BY THE DEPARTMENT</i></p>	<p>OR</p>	<p><b>DEPOSITED IN THE TENDER BOX AT:</b></p> <p>LABELLED - DBN DBN26/07/01 Department of Department of Public Works and Infrastructure 157 Monty Naicker Road, by Securities. (bidders to note that entrance in Dr Pixley Ka Seme is temporarily closed)</p>
--	-----------	---



public works  
& infrastructure

Department:  
Public Works and Infrastructure  
**REPUBLIC OF SOUTH AFRICA**

Project title:	NDPWI DURBAN: SUPPLY AND DELIVERY (INCLUDING INSTALLATION) OF OFFICE FURNITURE - NO: 05 KESINGTON BOULEVARD KINGSMEAD - DURBAN REGIONAL OFFICE		
Reference no:	26/2/1/4/7/19/6301/6		

Quotation No:	DBN26/07/01		
Advertising date:	03 / 07 /2026	Closing date:	28 /07 /2026
Closing time:	11:00am	Validity period:	84 Days

### BIDDERS TO TAKE NOTE OF THE FOLLOWING

- Any change due will be confirmed by the Project Manager.
- Quoted rates must be inclusive of all related costs.
- Price Schedule must fully be completed by the Bidder.
- Bidders may quote for a similar product of the same quality or better.
- Department reserves the right to make final decisions on the final colors.
- Bidders to quote on all items.
- Upon request, submission of a fully completed security clearance application form with supporting documentation and information will be required. The security clearance form will be provided by the Department for projects requiring security clearance.
- Successful bidder to provide a warranty of 5 years for the office furniture supplied.
- As part of the risk assessment, submitted documents are subjected to verification by the Department prior to final recommendation of the highest point scorer.
- Highest point scorer may be required to re-submit stamped company bank statements prior to the award for confirmation of available funds/credit.

Project Leader: AS Madyantyi

  
Signature & Date 1/07/2026



**PRICING SCHEDULE – FIRM PRICES  
(PURCHASES)**

**NOTE: ONLY FIRM PRICES WILL BE ACCEPTED. NON-FIRM PRICES (INCLUDING PRICES SUBJECT TO RATES OF EXCHANGE VARIATIONS) WILL NOT BE CONSIDERED**

**IN CASES WHERE DIFFERENT DELIVERY POINTS INFLUENCE THE PRICING, A SEPARATE PRICING SCHEDULE MUST BE SUBMITTED FOR EACH DELIVERY POINT**

Name of bidder.....

Bid number: **DBN26/07/01**

Closing Time **11:00am**

Closing date: **28 JULY 2026 @ 11h00am**

OFFER TO BE VALID FOR **84** DAYS FROM THE CLOSING DATE OF BID.

<b>ITEM NO.</b>	<b>QUANTITY</b>	<b>DESCRIPTION</b>	<b>BID PRICE IN RSA CURRENCY</b> ** (ALL APPLICABLE TAXES INCLUDED)
.....	.....	.....	.....

*The price that appears on this form is the one that will be considered for acceptance as **a firm and final offer.***

**OFFICE FURNITURE SPECIFICATIONS – KINGSMEAD PROJECT**

Reference No: 26/2/1/4/7/19/6301/6

NDPWI: NO.05 KESINGTON BOULEVARD KINGSMEAD

**Description: NDPWI DURBAN: SUPPLY AND DELIVERY (INCLUDING INSTALLATION) OF OFFICE FURNITURE**

<b>PRODUCT</b>	<b>DESCRIPTION</b>	<b>QTY</b>	<b>UNIT PRICE</b>	<b>TOTAL</b>
GLOBAL TOP-SILVER STORAGE (GROUND FLOOR)	CHERRY LAMINATE / VENEER OR SIMILAR	4		
URBN LITE LOOP LEG (GROUND FLOOR)	INCL 2 CONNECTORS - BLACK	2		
CABLE TRAY (GROUND FLOOR)	900X90X90H BLACK	4		
URBN LITE DH PED (GROUND, FIRST, SECOND, THIRD FLOOR)	CHERRY LAMINATE / VENEER OR SIMILAR	88		
HANDLE VOGUE BLACK (GROUND FLOOR)		15		
GLOBAL SIDE STITCH SCREEN+BRCK (GROUND, FIRST, SECOND, THIRD FLOOR)	1500WX365HX26MM COM	49		
VULCAN COL 36 (GROUND, FIRST, SECOND, THIRD FLOOR)	STONE - SCREEN FABRIC	98		



G TASK CHAIR (GROUND, FIRST, SECOND, THIRD FLOOR)	SIMPLE MECH BLACK	87		
XP RECTANGULAR DESK (GROUND, FIRST, SECOND, THIRD FLOOR)	1800X750X725H CHERRY LAMINATE / VENEER OR SIMILAR	1		
CABLE OUTLET ACCESS COVER (GROUND FLOOR)	ROUND - BLACK	2		
EXTENSION TOP (GROUND, FIRST, SECOND, THIRD FLOOR)	800X600X25MM CHERRY LAMINATE / VENEER OR SIMILAR	84		
JOINING PLATE (GROUND, FIRST, SECOND, THIRD FLOOR)		168		
LITE DH PED (GROUND FLOOR)	400X550X700H CHERRY LAMINATE / VENEER OR SIMILAR	5		
L TASK CHAIR (GROUND, FIRST, SECOND, THIRD FLOOR)	BLACK	88		
L HEADREST (GROUND, FIRST, SECOND, THIRD FLOOR)	BLACK	88		
SLEIGH FRAME CHAIR (GROUND)	BLACK	2		
STATIONERY CUPBOARD (GROUND)	900X450X1800H BLACK	1		
RECT. DESK+1LEG LHS (GROUND, FIRST, SECOND, THIRD FLOOR)	1800X750X725H CHERRY LAMINATE / VENEER	72		
DROPPED L-EXT LHS (GROUND, FIRST, SECOND, THIRD FLOOR)	1500X550X675H CHERRY LAMINATE / VENEER	72		
CABLE TRAY (GROUND, FIRST, SECOND, THIRD FLOOR)	WHITE	170		
CABLE OUTLET ACCESS COVER (GROUND, FIRST, SECOND, THIRD FLOOR)	ROUND - SILVER	427		
HANDLE VOGUE 128P SILVER (GROUND, FIRST, SECOND, THIRD FLOOR)		768		
4-LEGGED VIS CHAIR (GROUND, FIRST, SECOND, THIRD FLOOR)	AMBER PU UPHOLSTERY	58		
ECOCENTRIC FILING CABINET (GROUND, FIRST, SECOND, THIRD FLOOR)	900X400X1500H CHERRY LAMINATE / VENEER OR SIMILAR	42		
XP RECTANGULAR DESK (GROUND, FIRST, SECOND, THIRD FLOOR)	1600X750X725H CHERRY LAMINATE / VENEER OR SIMILAR	83		
XP DROPPED L-EXT RHS	1500X550X675H CHERRY LAMINATE / VENEER OR SIMILAR	15		
URBAN LITE DH PED 1FPT2SD1FD (GROUND, FIRST, SECOND, THIRD FLOOR)	400X550X700H CHERRY LAMINATE / VENEER OR SIMILAR	83		
XP ME RECT. DESK+1LEG RHS	1800X750X725H CHERRY LAMINATE / VENEER OR SIMILAR	15		



LEG DESK L-EXT LHS-ALU PVC (FIRST FLOOR)	1900X2000X738H CHERRY LAMINATE / VENEER OR SIMILAR	1		
LEG DESK L-EXT RHS-ALU PVC (GROUND, SECOND, THIRD FLOOR)	1900X2000X738H CHERRY LAMINATE / VENEER OR SIMILAR	3		
TASK CHAIR 3D ADJ ARMS (GROUND, FIRST, SECOND, THIRD FLOOR)	GREY MESH BACK GREY FAB SEAT	7		
HEADREST (GROUND, FIRST, SECOND, THIRD FLOOR)	GREY MESH	7		
C-VISITORS CHAIR BLACK FRAME (GROUND, FIRST, SECOND, THIRD FLOOR)	TAN BONDED LEATHER	10		
DIAMOND RECT. BENCH TOP (GROUND FLOOR)	1600X800X16MM CHERRY LAMINATE / VENEER OR SIMILAR	2		
DIAMOND OPEN SGL DSK STRUCTURE (GROUND FLOOR)	1600X800X722H BLACK LEGS	2		
CLASSICAL M/B CHR BLACK ARMS (GROUND FLOOR, SECOND FLOOR)	TAN BONDED LEATHER	14		
MUTE S/DOOR SERVER UNIT (GROUND, SECOND FLOOR)	1800X450X900H BLACK/SLATE GREY	2		
FLOAT LOUNGE CHAIR (GROUND FLOOR)	720WX725DX710H OLIVE GREEN	2		
SIDE TABLE (GROUND, FIRST, THIRD FLOOR)	500DX450H BLACK	3		
ARMCHAIR (GROUND FLOOR)	675WX790DX750H FOREST GREEN	2		
ROUND COFFEE TABLE (GROUND FLOOR)	750 DIA X 350H NAT OAK	1		
BREEZE TRIPLE SEATER (FIRST FLOOR)	1960WX770DX780H GREY 35	1		
TRAY COFFEE TABLE (FIRST FLOOR)	800DX435H BLACK	2		
OBLONG LAPTOP TABLE (FIRST FLOOR)	393WX500DX650H BLACK	1		
DMND RECTANGULAR TOP (SECOND FLOOR)	1800X800X16MM CHERRY LAMINATE / VENEER OR SIMILAR	1		
DMND OPEN MAN.DSK STRUCTURE (SECOND FLOOR)	1800X800X722H BLACK LEGS	1		
DMND 2PC BOARDROOM TOP (SECOND FLOOR)	4800X1200X16MM CHERRY LAMINATE / VENEER OR SIMILAR	1		
DMND OPEN BOARDROOM FRAME (SECOND FLOOR)	4800X1200X722H BLACK	1		
CLASSICAL H/B CHAIR BLACK ARMS (SECOND FLOOR)	TAN BONDED LEATHER	12		
FRANKLIN RECEP. UNIT LHS+EXT (THIRD FLOOR)	2700X1800X1080H CHERRY LAMINATE / VENEER	1		
BENCH/Framework MOB PED 2SD1DF (THIRD FLOOR)	400WX500DX600H WHITE	1		



COSMOS SINGLE SEATER (THIRD FLOOR)	BLUE FABRIC - FC3502	2		
HERA OCCASSIONAL CHAIR (THIRD FLOOR)	EMERALD GREEN - FC3813	2		
ALLURE EXEC DSK+2DRW L-EXT RHS (THIRD FLOOR)	2200X2150X738H D/EUCALYPT/BLK	1		
ACCORD HIGH BACK CHAIR (THIRD FLOOR)	AMBER PU0901	1		
CHICO SWIVEL CHAIR 4-STAR (THIRD FLOOR)	STONE GREY - FC3821	2		
ALLURE HINGE DOOR CABINET (THIRD FLOOR)	1000X450X1100H D/EUCALYPT/BLK	1		
SCANDI SINGLE SEATER (THIRD FLOOR)	BLACK LEGS COM - 6M	1		
ARAGON COL 12 (THIRD FLOOR)	SANDLEWOOD-COUCH FABRIC	6		

**END OF SPECIFICATION**

<b>A</b>		Sub Total	R
<b>B</b>		Add 15% VAT	R
<b>C</b>	<b>BID PRICE IN RSA CURRENCY: ALL APPLICABLE TAXES INCLUDED (A+B=C) : Final Total SBD 3.1</b>		R
	<b>Final Total written in Words:</b>		

- Required by: .....
- At: .....
- Brand and model .....
- Country of origin .....
- Does the offer comply with the specification(s)? \*YES / NO
- If not to specification, indicate deviation(s) .....
- Period required for delivery .....  
\*Delivery: Firm / not firm
- Delivery basis .....

Note: All delivery costs must be included in the bid price, for delivery at the prescribed destination.

\*\* "all applicable taxes" includes value-added tax, pay as you earn, income tax, unemployment insurance fund contributions and skills development levies.



public works  
& infrastructure  
Department:  
Public Works and Infrastructure  
REPUBLIC OF SOUTH AFRICA

\*Delete if not applicable

\_\_\_\_\_  
**Signature of Bidder**

\_\_\_\_\_  
**Date**

## PA-10: GENERAL CONDITIONS OF CONTRACT (GCC)

### NOTES:

The purpose of this document is to:

- (i) Draw special attention to certain general conditions applicable to government bids, contracts and orders; and
- (ii) To ensure that clients be familiar with regard to the rights and obligations of all parties involved in doing business with government.

In this document words in the singular also mean in the plural and vice versa and words in the masculine also mean in the feminine and neuter.

- The General Conditions of Contract will form part of all bid documents and may not be amended.
- Special Conditions of Contract (SCC) relevant to a specific bid should be compiled separately for every bid (if applicable) and will supplement the General Conditions of Contract. Whenever there is a conflict, the provisions in the SCC shall prevail.

### TABLE OF CLAUSES

1. **Definitions**
2. **Application**
3. **General**
4. **Standards**
5. **Use of contract documents and information; inspection**
6. **Patent rights**
7. **Performance security**
8. **Inspections, tests and analysis**
9. **Packing**
10. **Delivery and documents**
11. **Insurance**
12. **Transportation**
13. **Incidental services**
14. **Spare parts**
15. **Warranty**
16. **Payment**
17. **Prices**
18. **Contract amendments**
19. **Assignment**
20. **Subcontracts**
21. **Delays in the supplier's performance**
22. **Penalties**
23. **Termination for default**
24. **Dumping and countervailing duties**
25. **Force Majeure**
26. **Termination for insolvency**
27. **Settlement of disputes**
28. **Limitation of liability**
29. **Governing language**
30. **Applicable law**
31. **Notices**
32. **Taxes and duties**
33. **National Industrial Participation Programme (NIPP)**
34. **Prohibition of restrictive practices**

## PA-10: General Conditions of Contract (GCC)

### General Conditions of Contract

#### 1. Definitions

1. The following terms shall be interpreted as indicated:

- 1.1. **"Closing time"** means the date and hour specified in the bidding documents for the receipt of bids.
- 1.2. **"Contract"** means the written agreement entered into between the purchaser and the supplier, as recorded in the contract form signed by the parties, including all attachments and appendices thereto and all documents incorporated by reference therein.
- 1.3. **"Contract price"** means the price payable to the supplier under the contract for the full and proper performance of his contractual obligations.
- 1.4. **"Corrupt practice"** means the offering, giving, receiving, or soliciting of any thing of value to influence the action of a public official in the procurement process or in contract execution.
- 1.5. **"Countervailing duties"** are imposed in cases where an enterprise abroad is subsidized by its government and encouraged to market its products internationally.
- 1.6. **"Country of origin"** means the place where the goods were mined, grown or produced or from which the services are supplied. Goods are produced when, through manufacturing, processing or substantial and major assembly of components, a commercially recognized new product results that is substantially different in basic characteristics or in purpose or utility from its components.
- 1.7. **"Day"** means calendar day.
- 1.8. **"Delivery"** means delivery in compliance of the conditions of the contract or order.
- 1.9. **"Delivery ex stock"** means immediate delivery directly from stock actually on hand.
- 1.10. **"Delivery into consignees store or to his site"** means delivered and unloaded in the specified store or depot or on the specified site in compliance with the conditions of the contract or order, the supplier bearing all risks and charges involved until the supplies are so delivered and a valid receipt is obtained.
- 1.11. **"Dumping"** occurs when a private enterprise abroad market its goods on own initiative in the RSA at lower prices than that of the country of origin and which have the potential to harm the local industries in the RSA.
- 1.12. **"Force majeure"** means an event beyond the control of the supplier and not involving the supplier's fault or negligence and not foreseeable. Such events may include, but is not restricted to, acts of the purchaser in its sovereign capacity, wars or revolutions, fires, floods, epidemics, quarantine restrictions and freight embargoes.
- 1.13. **"Fraudulent practice"** means a misrepresentation of facts in order to influence a procurement process or the execution of a contract to the detriment of any bidder, and includes collusive practice among bidders (prior to or after bid submission) designed to establish bid prices at artificial non-competitive levels and to deprive the bidder of the benefits of free and open competition.
- 1.14. **"GCC"** means the General Conditions of Contract.
- 1.15. **"Goods"** means all of the equipment, machinery, and/or other materials that the supplier is required to supply to the purchaser under the contract.

## PA-10: General Conditions of Contract (GCC)

- 1.16. **“Imported content”** means that portion of the bidding price represented by the cost of components, parts or materials which have been or are still to be imported (whether by the supplier or his subcontractors) and which costs are inclusive of the costs abroad, plus freight and other direct importation costs such as landing costs, dock dues, import duty, sales duty or other similar tax or duty at the South African place of entry as well as transportation and handling charges to the factory in the Republic where the supplies covered by the bid will be manufactured.
- 1.17. **“Local content”** means that portion of the bidding price which is not included in the imported content provided that local manufacture does take place.
- 1.18. **“Manufacture”** means the production of products in a factory using labour, materials, components and machinery and includes other related value-adding activities.
- 1.19. **“Order”** means an official written order issued for the supply of goods or works or the rendering of a service.
- 1.20. **“Project site”** where applicable, means the place indicated in bidding documents.
- 1.21. **“Purchaser”** means the organization purchasing the goods.
- 1.22. **“Republic”** means the Republic of South Africa.
- 1.23. **“SCC”** means the Special Conditions of Contract.
- 1.24. **“Services”** means those functional services ancillary to the supply of the goods, such as transportation and any other incidental services, such as installation, commissioning, provision of technical assistance, training, catering, gardening, security, maintenance and other such obligations of the supplier covered under the contract.
- 1.25. **“Written” or “in writing”** means handwritten in ink or any form of electronic or mechanical writing.

### 2. Application

- 2.1. These general conditions are applicable to all bids, contracts and orders including bids for functional and professional services, sales, hiring, letting and the granting or acquiring of rights, but excluding immovable property, unless otherwise indicated in the bidding documents.
- 2.2. Where applicable, special conditions of contract are also laid down to cover specific supplies, services or works.
- 2.3. Where such special conditions of contract are in conflict with these general conditions, the special conditions shall apply.

### 3. General

- 3.1. Unless otherwise indicated in the bidding documents, the purchaser shall not be liable for any expense incurred in the preparation and submission of a bid. Where applicable a non-refundable fee for documents may be charged.
- 3.2. With certain exceptions, invitations to bid are only published in the Government Tender Bulletin. The Government Tender Bulletin may be obtained directly from the Government Printer, Private Bag X85, Pretoria 0001, or accessed electronically from [www.treasury.gov.za](http://www.treasury.gov.za)

### 4. Standards

- 4.1. The goods supplied shall conform to the standards mentioned in the bidding documents and specifications.

### 5. Use of contract documents and information; inspection.

- 5.1. The supplier shall not, without the purchaser's prior written consent, disclose the contract, or any provision thereof, or any specification, plan, drawing, pattern, sample, or information furnished by or on behalf of the purchaser in connection therewith, to any person other than a person employed by the supplier in the performance of the contract. Disclosure to any such employed person shall be

## PA-10: General Conditions of Contract (GCC)

made in confidence and shall extend only so far as may be necessary for purposes of such performance.

- 5.2. The supplier shall not, without the purchaser's prior written consent, make use of any document or information mentioned in GCC clause 5.1 except for purposes of performing the contract.
- 5.3. Any document, other than the contract itself mentioned in GCC clause 5.1 shall remain the property of the purchaser and shall be returned (all copies) to the purchaser on completion of the supplier's performance under the contract if so required by the purchaser.
- 5.4. The supplier shall permit the purchaser to inspect the supplier's records relating to the performance of the supplier and to have them audited by auditors appointed by the purchaser, if so required by the purchaser.

### 6. Patent rights

- 6.1. The supplier shall indemnify the purchaser against all third-party claims of infringement of patent, trademark, or industrial design rights arising from use of the goods or any part thereof by the purchaser.

### 7. Performance security

- 7.1. Within thirty (30) days of receipt of the notification of contract award, the successful bidder shall furnish to the purchaser the performance security of the amount specified in SCC.
- 7.2. The proceeds of the performance security shall be payable to the purchaser as compensation for any loss resulting from the supplier's failure to complete his obligations under the contract.
- 7.3. The performance security shall be denominated in the currency of the contract, or in a freely convertible currency acceptable to the purchaser and shall be in one of the following forms:
  - (a) a bank guarantee or an irrevocable letter of credit issued by a reputable bank located in the purchaser's country or abroad, acceptable to the purchaser, in the form provided in the bidding documents or another form acceptable to the purchaser; or
  - (b) a cashier's or certified cheque
- 7.4. The performance security will be discharged by the purchaser and returned to the supplier not later than thirty (30) days following the date of completion of the supplier's performance obligations under the contract, including any warranty obligations, unless otherwise specified in SCC.

### 8. Inspections, tests and analyses

- 8.1. All pre-bidding testing will be for the account of the bidder.
- 8.2. If it is a bid condition that supplies to be produced or services to be rendered should at any stage during production or execution or on completion be subject to inspection, the premises of the bidder or contractor shall be open, at all reasonable hours, for inspection by a representative of the Department or an organization acting on behalf of the Department.
- 8.3. If there are no inspection requirements indicated in the bidding documents and no mention is made in the contract, but during the contract period it is decided that inspections shall be carried out, the purchaser shall itself make the necessary arrangements, including payment arrangements with the testing authority concerned.
- 8.4. If the inspections, tests and analyses referred to in clauses 8.2 and 8.3 show the supplies to be in accordance with the contract requirements, the cost of the inspections, tests and analyses shall be defrayed by the purchaser.
- 8.5. Where the supplies or services referred to in clauses 8.2 and 8.3 do not comply with the contract requirements, irrespective of whether such supplies or services are accepted or not, the cost in connection with these inspections, tests or analyses shall be defrayed by the supplier.

## PA-10: General Conditions of Contract (GCC)

- 8.6. Supplies and services which are referred to in clauses 8.2 and 8.3 and which do not comply with the contract requirements may be rejected.
- 8.7. Any contract supplies may on or after delivery be inspected, tested or analyzed and may be rejected if found not to comply with the requirements of the contract. Such rejected supplies shall be held at the cost and risk of the supplier who shall, when called upon, remove them immediately at his own cost and forthwith substitute them with supplies which do comply with the requirements of the contract. Failing such removal the rejected supplies shall be returned at the suppliers cost and risk. Should the supplier fail to provide the substitute supplies forthwith, the purchaser may, without giving the supplier further opportunity to substitute the rejected supplies, purchase such supplies as may be necessary at the expense of the supplier.
- 8.8. The provisions of clauses 8.4 to 8.7 shall not prejudice the right of the purchaser to cancel the contract on account of a breach of the conditions thereof, or to act in terms of Clause 23 of GCC.

### 9. Packing

- 9.1. The supplier shall provide such packing of the goods as is required to prevent their damage or deterioration during transit to their final destination, as indicated in the contract. The packing shall be sufficient to withstand, without limitation, rough handling during transit and exposure to extreme temperatures, salt and precipitation during transit, and open storage. Packing, case size and weights shall take into consideration, where appropriate, the remoteness of the goods' final destination and the absence of heavy handling facilities at all points in transit.
- 9.2. The packing, marking, and documentation within and outside the packages shall comply strictly with such special requirements as shall be expressly provided for in the contract, including additional requirements, if any, specified in SCC, and in any subsequent instructions ordered by the purchaser.

### 10. Delivery and documents

- 10.1. Delivery of the goods shall be made by the supplier in accordance with the terms specified in the contract. The details of shipping and/or other documents to be furnished by the supplier are specified in SCC.
- 10.2. Documents to be submitted by the supplier are specified in SCC.

### 11. Insurance

- 11.1. The goods supplied under the contract shall be fully insured in a freely convertible currency against loss or damage incidental to manufacture or acquisition, transportation, storage and delivery in the manner specified in the SCC.

### 12. Transportation

- 12.1. Should a price other than an all-inclusive delivered price be required, this shall be specified in the SCC.

### 13. Incidental services

- 13.1. The supplier may be required to provide any or all of the following services, including additional services, if any, specified in SCC:
- (a) performance or supervision of on-site assembly and/or commissioning of the supplied goods;
  - (b) furnishing of tools required for assembly and/or maintenance of the supplied goods;
  - (c) furnishing of a detailed operations and maintenance manual for each appropriate unit of the supplied goods;
  - (d) performance or supervision or maintenance and/or repair of the supplied goods, for a period of time agreed by the parties, provided that this service shall not relieve the supplier of any warranty obligations under this contract; and

## PA-10: General Conditions of Contract (GCC)

(e) training of the purchaser's personnel, at the supplier's plant and/or on-site, in assembly, start-up, operation, maintenance, and/or repair of the supplied goods.

13.2. Prices charged by the supplier for incidental services, if not included in the contract price for the goods, shall be agreed upon in advance by the parties and shall not exceed the prevailing rates charged to other parties by the supplier for similar services.

### 14. Spare parts

14.1. As specified in SCC, the supplier may be required to provide any or all of the following materials, notifications, and information pertaining to spare parts manufactured or distributed by the supplier:

(a) such spare parts as the purchaser may elect to purchase from the supplier, provided that this election shall not relieve the supplier of any warranty obligations under the contract; and

(b) in the event of termination of production of the spare parts:

(i) Advance notification to the purchaser of the pending termination, in sufficient time to permit the purchaser to procure needed requirements; and

(ii) following such termination, furnishing at no cost to the purchaser, the blueprints, drawings, and specifications of the spare parts, if requested.

### 15. Warranty

15.1. The supplier warrants that the goods supplied under the contract are new, unused, of the most recent or current models, and that they incorporate all recent improvements in design and materials unless provided otherwise in the contract. The supplier further warrants that all goods supplied under this contract shall have no defect, arising from design, materials, or workmanship (except when the design and/or material is required by the purchaser's specifications) or from any act or omission of the supplier, that may develop under normal use of the supplied goods in the conditions prevailing in the country of final destination.

15.2. This warranty shall remain valid for twelve (12) months after the goods, or any portion thereof as the case may be, have been delivered to and accepted at the final destination indicated in the contract, or for eighteen (18) months after the date of shipment from the port or place of loading in the source country, whichever period concludes earlier, unless specified otherwise in SCC.

15.3. The purchaser shall promptly notify the supplier in writing of any claims arising under this warranty.

15.4. Upon receipt of such notice, the supplier shall, within the period specified in SCC and with all reasonable speed, repair or replace the defective goods or parts thereof, without costs to the purchaser.

15.5. If the supplier, having been notified, fails to remedy the defect(s) within the period specified in SCC, the purchaser may proceed to take such remedial action as may be necessary, at the supplier's risk and expense and without prejudice to any other rights which the purchaser may have against the supplier under the contract.

### 16. Payment

16.1. The method and conditions of payment to be made to the supplier under this contract shall be specified in SCC.

16.2. The supplier shall furnish the purchaser with an invoice accompanied by a copy of the delivery note and upon fulfilment of other obligations stipulated in the contract.

16.3. Payments shall be made promptly by the purchaser, but in no case later than thirty (30) days after submission of an invoice or claim by the supplier.

16.4. Payment will be made in Rand unless otherwise stipulated in SCC.

### 17. Prices

## PA-10: General Conditions of Contract (GCC)

- 17.1. Prices charged by the supplier for goods delivered and services performed under the contract shall not vary from the prices quoted by the supplier in his bid, with the exception of any price adjustments authorized in SCC or in the purchaser's request for bid validity extension, as the case may be.

### 18. Contract amendments

- 18.1. No variation in or modification of the terms of the contract shall be made except by written amendment signed by the parties concerned.

### 19. Assignment

- 19.1. The supplier shall not assign, in whole or in part, its obligations to perform under the contract, except with the purchaser's prior written consent.

### 20. Subcontracts

- 20.1. The supplier shall notify the purchaser in writing of all subcontracts awarded under this contracts if not already specified in the bid. Such notification, in the original bid or later, shall not relieve the supplier from any liability or obligation under the contract.

### 21. Delays in the supplier's performance

- 21.1. Delivery of the goods and performance of services shall be made by the supplier in accordance with the time schedule prescribed by the purchaser in the contract.
- 21.2. If at any time during performance of the contract, the supplier or its subcontractor(s) should encounter conditions impeding timely delivery of the goods and performance of services, the supplier shall promptly notify the purchaser in writing of the fact of the delay, its likely duration and its cause(s). As soon as practicable after receipt of the supplier's notice, the purchaser shall evaluate the situation and may at his discretion extend the supplier's time for performance, with or without the imposition of penalties, in which case the extension shall be ratified by the parties by amendment of contract.
- 21.3. No provision in a contract shall be deemed to prohibit the obtaining of supplies or services from a national department, provincial department, or a local authority.
- 21.4. The right is reserved to procure outside of the contract small quantities or to have minor essential services executed if an emergency arises, the supplier's point of supply is not situated at or near the place where the supplies are required, or the supplier's services are not readily available.
- 21.5. Except as provided under GCC Clause 25, a delay by the supplier in the performance of its delivery obligations shall render the supplier liable to the imposition of penalties, pursuant to GCC Clause 22, unless an extension of time is agreed upon pursuant to GCC Clause 21.2 without the application of penalties.
- 21.6. Upon any delay beyond the delivery period in the case of a supplies contract, the purchaser shall, without cancelling the contract, be entitled to purchase supplies of a similar quality and up to the same quantity in substitution of the goods not supplied in conformity with the contract and to return any goods delivered later at the supplier's expense and risk, or to cancel the contract and buy such goods as may be required to complete the contract and without prejudice to his other rights, be entitled to claim damages from the supplier.

### 22. Penalties

- 22.1. Subject to GCC Clause 25, if the supplier fails to deliver any or all of the goods or to perform the services within the period(s) specified in the contract, the purchaser shall, without prejudice to its other remedies under the contract, deduct from the contract price, as a penalty, a sum calculated on the delivered price of the delayed goods or unperformed services using the current prime interest rate calculated for each day of the delay until actual delivery or performance. The purchaser may also consider termination of the contract pursuant to GCC Clause 23.

### 23. Termination for default

- 23.1. The purchaser, without prejudice to any other remedy for breach of contract, by written notice of default sent to the supplier, may terminate this contract in whole or in part:

## PA-10: General Conditions of Contract (GCC)

- (a) if the supplier fails to deliver any or all of the goods within the period(s) specified in the contract, or within any extension thereof granted by the purchaser pursuant to GCC Clause 21.2;
- (b) if the Supplier fails to perform any other obligation(s) under the contract; or
- (c) if the supplier, in the judgment of the purchaser, has engaged in corrupt or fraudulent practices in competing for or in executing the contract.

23.2. In the event the purchaser terminates the contract in whole or in part, the purchaser may procure, upon such terms and in such manner as it deems appropriate, goods, works or services similar to those undelivered, and the supplier shall be liable to the purchaser for any excess costs for such similar goods, works or services. However, the supplier shall continue performance of the contract to the extent not terminated.

23.3 Where the purchaser terminates the contract in whole or in part, the purchaser may decide to impose a restriction penalty on the supplier by prohibiting such supplier from doing business with the public sector for a period of not exceeding 10 years.

23.4 If a purchaser intends imposing a restriction on a supplier or any person with the supplier, the supplier will be allowed a time period of not more than fourteen (14) days to provide why the envisaged restriction should not be imposed. Should the supplier fail to respond within the stipulated fourteen (14) days the purchaser may regard the intended penalty as not objected against and may impose it on the supplier.

23.5 Any restriction on any person by the Accounting Officer/ Authority will, at the discretion of the Accounting Officer/ Authority, also be applicable to any enterprise or any partner, manager, director or other person who wholly or partly exercises or exercised or may exercise control over the enterprise of the first-mentioned person, and with which the first-mentioned person, is or was in the opinion of the Accounting Officer/ Authority actively associated.

23.6 If a restriction is imposed, the purchaser must, within five (5) working days of such imposition, furnish The National Treasury, with the following information:

- i) The name and address of the supplier and/or person restricted by the purchaser;
- ii) The date of commencement of the restriction
- iii) The period of the restriction; and
- iv) The reasons for the restriction.

These details will be loaded in the National Treasury's central database of suppliers or persons prohibited from doing business with the public sector.

23.7 If a court of law convicts a person of an offence as contemplated in sections 12 or 13 of the Prevention and Combating of Corrupt Activities Act No. 12 of 2004, the court may also rule that such person's name be endorsed on the Register for Tender Defaulters. When a person's name has been endorsed on the Register, the person will be prohibited from doing business with the public sector for a period not less than five years and not more than ten years. The National Treasury is empowered to determine the period of restriction and each case will be dealt with on its merits. According to section 32 of the Act the Register must be open to the public. The Register can be perused on the National Treasury website.

### **24. Anti-dumping and countervailing duties and rights**

24.1. When, after the date of bid, provisional payments are required, or antidumping or countervailing duties are imposed, or the amount of a provisional payment or anti-dumping or countervailing right is increased in respect of any dumped or subsidized import, the State is not liable for any amount so required or imposed, or for the amount of any such increase. When, after the said date, such a provisional payment is no longer required or any such anti-dumping or countervailing right is abolished, or where the amount of such provisional payment or any such right is reduced, any such favourable difference shall on demand be paid forthwith by the contractor to the State or the State may deduct such amounts from moneys (if any) which may otherwise be due to the contractor in regard to supplies or services which he delivered or rendered, or is to deliver or render in terms of the contract or any other contract or any other amount which may be due to him.

## PA-10: General Conditions of Contract (GCC)

### 25. Force Majeure

- 25.1. Notwithstanding the provisions of GCC Clauses 22 and 23, the supplier shall not be liable for forfeiture of its performance security, damages, or termination for default if and to the extent that his delay in performance or other failure to perform his obligations under the contract is the result of an event of force majeure.
- 25.2. If a force majeure situation arises, the supplier shall promptly notify the purchaser in writing of such condition and the cause thereof. Unless otherwise directed by the purchaser in writing, the supplier shall continue to perform its obligations under the contract as far as is reasonably practical, and shall seek all reasonable alternative means for performance not prevented by the force majeure event.

### 26. Termination for insolvency

- 26.1. The purchaser may at any time terminate the contract by giving written notice to the supplier if the supplier becomes bankrupt or otherwise insolvent. In this event, termination will be without compensation to the supplier, provided that such termination will not prejudice or affect any right of action or remedy which has accrued or will accrue thereafter to the purchaser.

### 27. Settlement of Disputes

- 27.1 If any dispute or difference of any kind whatsoever arises between the purchaser and the supplier in Connection with or arising out of the contract, the parties shall make every effort to resolve amicably such dispute or difference by mutual consultation.
- 27.2 If, after thirty (30) days, the parties have failed to resolve their dispute or difference by such mutual consultation, then either the purchaser or the supplier may give notice to the other party of his intention to commence with mediation. No mediation in respect of this matter may be commenced unless such notice is given to the other party.
- 27.3 Should it not be possible to settle a dispute by means of mediation, it may be settled in a South African court of law.
- 27.4 Mediation proceedings shall be conducted in accordance with the rules of the procedure specified in the SCC.
- 27.5 Notwithstanding any reference to mediation and/or court proceedings herein,
- (a) the parties shall continue to perform their respective obligations under contract unless they Otherwise agree; and
  - (b) the purchaser shall pay the supplier any monies due the supplier.

### 28. Limitation of Liability

- 28.1 Except in cases of criminal negligence or willful misconduct, and in the case of infringement pursuant to Clause 6;
- (a) the supplier shall not be liable to the purchaser, whether in contract, tort, or otherwise, for any indirect or consequential loss or damage, loss of use, loss of production, or loss of profits or interest costs, provided that this exclusion shall not apply to any obligation of the supplier to pay penalties and/or damages to the purchaser; and
  - (b) the aggregate liability of the supplier to the purchaser, whether under the contract, in tort or otherwise, shall not exceed the total contract price, provided that this limitation shall not apply to the cost of repairing or replacing defective equipment.

PA-10: General Conditions of Contract (GCC)

**29. Governing language**

29.1. The contract shall be written in English. All correspondence and other documents pertaining to the contract that is exchanged by the parties shall also be written in English.

**30. Applicable law**

30.1. The contract shall be interpreted in accordance with South African laws, unless otherwise specified in SCC.

**31. Notices**

31.1. Every written acceptance of a bid shall be posted to the supplier concerned by registered or certified mail and any other notice to him shall be posted by ordinary mail to the address furnished in his bid or to the address notified later by him in writing and such posting shall be deemed to be proper service of such notice

31.2. The time mentioned in the contract documents for performing any act after such aforesaid notice has been given, shall be reckoned from the date of posting of such notice.

**32. Taxes and duties**

32.1. A foreign supplier shall be entirely responsible for all taxes, stamp duties, license fees, and other such levies imposed outside the purchaser's country.

32.2. A local supplier shall be entirely responsible for all taxes, duties, license fees, etc., incurred until delivery of the contracted goods to the purchaser.

32.3. No contract shall be concluded with any bidder whose tax matters are not in order. Prior to the award of a bid the Department must be in possession of a tax clearance certificate, submitted by the bidder. This certificate must be an original issued by the South African

**33. National Industrial Participation Programme (NIPP)**

33.1. The NIP Programme administered by the Department of Trade and Industry shall be applicable to all contracts that are subject to the NIP obligation.

**34. Prohibition of Restrictive Practices**

34.1. In terms of section 4 (1) (b) (iii) of the Competition Act No. 89 of 1998, as amended, an agreement between, or concerted practice by, firms, or a decision by an association of firms, is prohibited if it is between parties in a horizontal relationship and if a bidder (s) is / are or a contractor(s) was / were involved in collusive bidding (or bid rigging).

34.2. If a bidder(s) or contractor(s), based on reasonable grounds or evidence obtained by the purchaser, has / have engaged in the restrictive practice referred to above, the purchaser may refer the matter to the Competition Commission for investigation and possible imposition of administrative penalties as contemplated in the Competition Act No. 89 of 1998.

34.3. If a bidder(s) or contractor(s), has / have been found guilty by the Competition Commission of the restrictive practice referred to above, the purchaser may, in addition and without prejudice to any other remedy provided for, invalidate the bid(s) for such item(s) offered, and / or terminate the contract in whole or part, and / or restrict the bidder(s) or contractor(s) from conducting business with the public sector for a period not exceeding ten (10) years and / or claim damages from the bidder(s) or contractor(s) concerned.

Name of Bidder	Signature	Date

## CONTRACT FORM - PURCHASE OF GOODS/WORKS

**THIS FORM MUST BE FILLED IN DUPLICATE BY BOTH THE SUCCESSFUL BIDDER (PART 1) AND THE PURCHASER (PART 2). BOTH FORMS MUST BE SIGNED IN THE ORIGINAL SO THAT THE SUCCESSFUL BIDDER AND THE PURCHASER WOULD BE IN POSSESSION OF ORIGINALLY SIGNED CONTRACTS FOR THEIR RESPECTIVE RECORDS.**

### PART 1 (TO BE FILLED IN BY THE BIDDER)

1. I hereby undertake to supply all or any of the goods and/or works described in the attached bidding documents to (name of institution)..... in accordance with the requirements and specifications stipulated in bid number..... at the price/s quoted. My offer/s remain binding upon me and open for acceptance by the purchaser during the validity period indicated and calculated from the closing time of bid.
2. The following documents shall be deemed to form and be read and construed as part of this agreement:
  - (i) Bidding documents, viz
    - Invitation to bid;
    - Proof of tax compliance status;
    - Pricing schedule(s);
    - Technical Specification(s);
    - Preference claim form for Preferential Procurement in terms of the Preferential Procurement Regulations;
    - Bidder's Disclosure form;
    - Special Conditions of Contract;
  - (ii) General Conditions of Contract; and
  - (iii) Other (specify)
3. I confirm that I have satisfied myself as to the correctness and validity of my bid; that the price(s) and rate(s) quoted cover all the goods and/or works specified in the bidding documents; that the price(s) and rate(s) cover all my obligations and I accept that any mistakes regarding price(s) and rate(s) and calculations will be at my own risk.
4. I accept full responsibility for the proper execution and fulfilment of all obligations and conditions devolving on me under this agreement as the principal liable for the due fulfilment of this contract.
5. I declare that I have no participation in any collusive practices with any bidder or any other person regarding this or any other bid.
6. I confirm that I am duly authorised to sign this contract.

NAME (PRINT) .....

CAPACITY .....

SIGNATURE .....

NAME OF FIRM .....

DATE .....

<b>WITNESSES</b>	
1	.....
2.	.....
DATE:	.....

**PART 2 (TO BE FILLED IN BY THE PURCHASER)**

1. I..... in my capacity as..... accept your bid under reference number .....dated.....for the supply of goods/works indicated hereunder and/or further specified in the annexure(s).
2. An official order indicating delivery instructions is forthcoming.
3. I undertake to make payment for the goods/works delivered in accordance with the terms and conditions of the contract, within 30 (thirty) days after receipt of an invoice accompanied by the delivery note.

ITEM NO.	PRICE (ALL APPLICABLE TAXES INCLUDED)	BRAND	DELIVERY PERIOD	TOTAL PREFERENCE POINTS CLAIMED	POINTS CLAIMED FOR EACH SPECIFIC GOAL

4. I confirm that I am duly authorised to sign this contract.

SIGNED AT .....ON.....

NAME (PRINT) .....

SIGNATURE .....

OFFICIAL STAMP

**WITNESSES**

1. ....

2. ....

DATE .....



2.2 Do you, or any person connected with the bidder, have a relationship with any person who is employed by the procuring institution?

YES / NO

2.2.1 If so, furnish particulars:

.....  
.....

2.3 Does the bidder or any of its directors / trustees / shareholders / members / partners or any person having a controlling interest in the enterprise have any interest in any other related enterprise whether or not they are bidding for this contract?

YES / NO

2.3.1 If so, furnish particulars:

.....  
.....

### 3 DECLARATION

I, the undersigned, (name).....  
in submitting the accompanying bid, do hereby make the following statements that I certify to be true and complete in every respect:

- 3.1 I have read and I understand the contents of this disclosure;
- 3.2 I understand that the accompanying bid will be disqualified if this disclosure is found not to be true and complete in every respect;
- 3.3 The bidder has arrived at the accompanying bid independently from, and without consultation, communication, agreement or arrangement with any competitor. However, communication between partners in a joint venture or consortium<sup>2</sup> will not be construed as collusive bidding.
- 3.4 In addition, there have been no consultations, communications, agreements or arrangements with any competitor regarding the quality, quantity, specifications, prices, including methods, factors or formulas used to calculate prices, market allocation, the intention or decision to submit or not to submit the bid, bidding with the intention not to win the bid and conditions or delivery particulars of the products or services to which this bid invitation relates.
- 3.5 The terms of the accompanying bid have not been, and will not be, disclosed by the bidder, directly or indirectly, to any competitor, prior to the date and time of the official bid opening or of the awarding of the contract.
- 3.6 There have been no consultations, communications, agreements or arrangements made by the bidder with any official of the procuring institution in relation to this procurement process prior to and during the bidding process except to provide clarification on the bid submitted where so required by the institution; and the bidder was not involved in the drafting of the specifications or terms of reference for this bid.

<sup>2</sup> Joint venture or Consortium means an association of persons for the purpose of combining their expertise, property, capital, efforts, skill and knowledge in an activity for the execution of a contract.

3.7 I am aware that, in addition and without prejudice to any other remedy provided to combat any restrictive practices related to bids and contracts, bids that are suspicious will be reported to the Competition Commission for investigation and possible imposition of administrative penalties in terms of section 59 of the Competition Act No 89 of 1998 and or may be reported to the National Prosecuting Authority (NPA) for criminal investigation and or may be restricted from conducting business with the public sector for a period not exceeding ten (10) years in terms of the Prevention and Combating of Corrupt Activities Act No 12 of 2004 or any other applicable legislation.

I CERTIFY THAT THE INFORMATION FURNISHED IN PARAGRAPHS 1, 2 and 3 ABOVE IS CORRECT.

I ACCEPT THAT THE STATE MAY REJECT THE BID OR ACT AGAINST ME IN TERMS OF PARAGRAPH 6 OF PFMA SCM INSTRUCTION 03 OF 2021/22 ON PREVENTING AND COMBATING ABUSE IN THE SUPPLY CHAIN MANAGEMENT SYSTEM SHOULD THIS DECLARATION PROVE TO BE FALSE.

.....  
Signature

.....  
Date

.....  
Position

.....  
Name of bidder

This form has been aligned with SBD4

## PA-15.1: RESOLUTION OF BOARD OF DIRECTORS

**RESOLUTION** of a meeting of the Board of \*Directors / Members / Partners of:

\_\_\_\_\_ (Legally correct full name and registration number, if applicable, of the Enterprise)

Held at \_\_\_\_\_ (place)

on \_\_\_\_\_ (date)

**RESOLVED that:**

1. The Enterprise submits a Bid / Tender to the Department of Public Works in respect of the following project:

\_\_\_\_\_ (Project description as per Bid / Tender Document)

Bid / Tender Number: \_\_\_\_\_ (Bid / Tender Number as per Bid / Tender Document)

2. \*Mr/Mrs/Ms: \_\_\_\_\_

in \*his/her Capacity as: \_\_\_\_\_ (Position in the Enterprise)

and who will sign as follows: \_\_\_\_\_

be, and is hereby, authorised to sign the Bid / Tender, and any and all other documents and/or correspondence in connection with and relating to the Bid / Tender, as well as to sign any Contract, and any and all documentation, resulting from the award of the Bid / Tender to the Enterprise mentioned above.

	Name	Capacity	Signature
1			
2			
3			
4			
5			
6			
7			
8			
9			
10			
11			
12			
13			
14			
15			
16			

17			
18			
19			
20			

The bidding enterprise hereby absolves the Department of Public Works from any liability whatsoever that may arise as a result of this document being signed.

**Note:**

1. \* Delete which is not applicable.
2. **NB:** This resolution must, where possible, be signed by all the Directors / Members / Partners of the Bidding Enterprise.
3. In the event that paragraph 2 cannot be complied with, the resolution must be signed by Directors / Members / Partners holding a majority of the shares / ownership of the Bidding Enterprise (attach proof of shareholding / ownership hereto).
4. Directors / Members / Partners of the Bidding Enterprise may alternatively appoint a person to sign this document on behalf of the Bidding Enterprise, which person must be so authorized by way of a duly completed power of attorney, signed by the Directors / Members / Partners holding a majority of the shares / ownership of the Bidding Enterprise (proof of shareholding / ownership and power of attorney are to be attached hereto).
5. Should the number of Directors / Members / Partners exceed the space available above, additional names and signatures must be supplied on a separate page.

**ENTERPRISE STAMP**

## PA-15.2: RESOLUTION OF BOARD OF DIRECTORS TO ENTER INTO CONSORTIA OR JOINT VENTURES

RESOLUTION of a meeting of the Board of \*Directors / Members / Partners of:

\_\_\_\_\_  
\_\_\_\_\_  
(Legally correct full name and registration number, if applicable, of the Enterprise)

Held at \_\_\_\_\_ (place)

on \_\_\_\_\_ (date)

### RESOLVED that:

1. The Enterprise submits a Bid /Tender, in consortium/Joint Venture with the following Enterprises:

\_\_\_\_\_  
\_\_\_\_\_  
(List all the legally correct full names and registration numbers, if applicable, of the Enterprises forming the Consortium/Joint Venture)

to the Department of Public Works in respect of the following project:

\_\_\_\_\_  
\_\_\_\_\_  
(Project description as per Bid /Tender Document)

Bid / Tender Number: \_\_\_\_\_ (Bid / Tender Number as per Bid / Tender Document)

2. \*Mr/Mrs/Ms: \_\_\_\_\_

in \*his/her Capacity as: \_\_\_\_\_ (Position in the Enterprise)

and who will sign as follows: \_\_\_\_\_

be, and is hereby, authorised to sign a consortium/joint venture agreement with the parties listed under item 1 above, and any and all other documents and/or correspondence in connection with and relating to the consortium/joint venture, in respect of the project described under item 1 above.

3. The Enterprise accepts joint and several liability with the parties listed under item 1 above for the due fulfilment of the obligations of the joint venture deriving from, and in any way connected with, the Contract to be entered into with the Department in respect of the project described under item 1 above.
4. The Enterprise chooses as its *domicilium citandi et executandi* for all purposes arising from this joint venture agreement and the Contract with the Department in respect of the project under item 1 above:

Physical address: \_\_\_\_\_

\_\_\_\_\_

\_\_\_\_\_

\_\_\_\_\_ (code)

Postal Address: \_\_\_\_\_  
 \_\_\_\_\_  
 \_\_\_\_\_  
 \_\_\_\_\_ (code)

Telephone number: \_\_\_\_\_

Fax number: \_\_\_\_\_

	Name	Capacity	Signature
1			
2			
3			
4			
5			
6			
7			
8			
9			
10			
11			
12			
13			
14			
15			

The bidding enterprise hereby absolves the Department of Public Works from any liability whatsoever that may arise as a result of this document being signed

**Note:**

1. \* Delete which is not applicable.
2. **NB:** This resolution must, where possible, be signed by all the Directors / Members / Partners of the Bidding Enterprise.
3. In the event that paragraph 2 cannot be complied with, the resolution must be signed by Directors / Members / Partners holding a majority of the shares / ownership of the Bidding Enterprise (attach proof of shareholding / ownership hereto).
4. Directors / Members / Partners of the Bidding Enterprise may alternatively appoint a person to sign this document on behalf of the Bidding Enterprise, which person must be so authorized by way of a duly completed power of attorney, signed by the Directors / Members / Partners holding a majority of the shares / ownership of the Bidding Enterprise (proof of shareholding / ownership and power of attorney are to be attached hereto).
5. Should the number of Directors / Members / Partners exceed the space available above, additional names and signatures must be supplied on a separate page.

**ENTERPRISE STAMP**

## PA-15.3: SPECIAL RESOLUTION OF CONSORTIA OR JOINT VENTURES

**RESOLUTION** of a meeting of the duly authorised representatives of the following legal entities who have entered into a consortium/joint venture to jointly bid for the project mentioned below: *(legally correct full names and registration numbers, if applicable, of the Enterprises forming a Consortium/Joint Venture)*

1. \_\_\_\_\_  
\_\_\_\_\_
2. \_\_\_\_\_  
\_\_\_\_\_
3. \_\_\_\_\_  
\_\_\_\_\_
4. \_\_\_\_\_  
\_\_\_\_\_
5. \_\_\_\_\_  
\_\_\_\_\_
6. \_\_\_\_\_  
\_\_\_\_\_
7. \_\_\_\_\_  
\_\_\_\_\_
8. \_\_\_\_\_  
\_\_\_\_\_

Held at \_\_\_\_\_ (place)

on \_\_\_\_\_ (date)

### RESOLVED that:

#### RESOLVED that:

- A. The above-mentioned Enterprises submit a Bid in Consortium/Joint Venture to the Department of Public Works in respect of the following project:

\_\_\_\_\_  
\_\_\_\_\_

*(Project description as per Bid /Tender Document)*

Bid / Tender Number: \_\_\_\_\_ *(Bid / Tender Number as per Bid /Tender Document)*

PA-15.3: Special Resolution of Consortia or Joint Ventures

B. \*Mr/Mrs/Ms: \_\_\_\_\_

in \*his/her Capacity as: \_\_\_\_\_ (Position in the Enterprise)

and who will sign as follows: \_\_\_\_\_

be, and is hereby, authorised to sign the Bid, and any and all other documents and/or correspondence in connection with and relating to the Bid, as well as to sign any Contract, and any and all documentation, resulting from the award of the Bid to the Enterprises in Consortium/Joint Venture mentioned above.

C. The Enterprises constituting the Consortium/Joint Venture, notwithstanding its composition, shall conduct all business under the name and style of:

\_\_\_\_\_

D. The Enterprises to the Consortium/Joint Venture accept joint and several liability for the due fulfilment of the obligations of the Consortium/Joint Venture deriving from, and in any way connected with, the Contract entered into with the Department in respect of the project described under item A above.

E. Any of the Enterprises to the Consortium/Joint Venture intending to terminate the consortium/joint venture agreement, for whatever reason, shall give the Department 30 days written notice of such intention. Notwithstanding such decision to terminate, the Enterprises shall remain jointly and severally liable to the Department for the due fulfilment of the obligations of the Consortium/Joint Venture as mentioned under item D above.

F. No Enterprise to the Consortium/Joint Venture shall, without the prior written consent of the other Enterprises to the Consortium/Joint Venture and of the Department, cede any of its rights or assign any of its obligations under the consortium/joint venture agreement in relation to the Contract with the Department referred to herein.

G. The Enterprises choose as the *domicilium citandi et executandi* of the Consortium/Joint Venture for all purposes arising from the consortium/joint venture agreement and the Contract with the Department in respect of the project under item A above:

Physical address: \_\_\_\_\_

\_\_\_\_\_

\_\_\_\_\_

\_\_\_\_\_ (Postal code) \_\_\_\_\_

Postal Address: \_\_\_\_\_

\_\_\_\_\_

\_\_\_\_\_

\_\_\_\_\_ (Postal code) \_\_\_\_\_

Telephone number: \_\_\_\_\_

Fax number: \_\_\_\_\_

PA-15.3: Special Resolution of Consortia or Joint Ventures

	Name	Capacity	Signature
6			
7			
8			
9			
10			
11			
12			
13			
14			
15			
1			
2			
3			
4			
5			

The bidding enterprise hereby absolves the Department of Public Works & Infrastructure from any liability whatsoever that may arise as a result of this document being signed.

**Note:**

1. \* Delete which is not applicable.
2. **NB:** This resolution must be signed by all the Duly Authorised Representatives of the Legal Entities to the consortium/joint venture submitting this tender, as named in item 2 of Resolution PA-15.2.
3. Should the number of the Duly Authorised Representatives of the Legal Entities joining forces in this tender exceed the space available above, additional names, capacity and signatures must be supplied on a separate page.
4. Resolution PA-15.2, duly completed and signed, from the separate Enterprises who participate in this consortium/joint venture, must be attached to this Special Resolution (PA-15.3).



## DPW-16 (EC): SITE INSPECTION MEETING CERTIFICATE

<b>Project title:</b>	<b>NDPWI DURBAN: SUPPLY AND DELIVERY (INCLUDING INSTALLATION) OF OFFICE FURNITURE - NO: 05 KESINGTON BOULEVARD KINGSMEAD - DURBAN REGIONAL OFFICE</b>		
<b>Tender / Quotation no:</b>	<i>DBN26/07/01</i>	<b>Reference no:</b>	<i>26/2/1/4/7/19/6301/6</i>
<b>Closing date:</b>	<i>28/07/2026 @ 11h00am</i>		

This is to certify that I, \_\_\_\_\_ representing

\_\_\_\_\_ in the capacity of

\_\_\_\_\_ visited the site on:

I have made myself familiar with all local conditions likely to influence the work and the cost thereof. I further certify that I am satisfied with the description of the work and explanations given at the site inspection meeting and that I understand perfectly the work to be done, as specified and implied, in the execution of this contract.

Name of Tenderer	Signature	Date

Name of DPW Representative	Signature	Date



## PA-16: PREFERENCE POINTS CLAIM FORM IN TERMS OF THE PREFERENTIAL PROCUREMENT REGULATIONS 2022

This preference form must form part of all tenders invited. It contains general information and serves as a claim form for preference points for specific goals.

**NB: BEFORE COMPLETING THIS FORM, TENDERERS MUST STUDY THE GENERAL CONDITIONS, DEFINITIONS AND DIRECTIVES APPLICABLE IN RESPECT OF THE TENDER AND PREFERENTIAL PROCUREMENT REGULATIONS, 2022**

### 1. GENERAL CONDITIONS

1.1 The following preference point systems are applicable to invitations to tender:

- the 80/20 system for requirements with a Rand value of up to R50 000 000 (all applicable taxes included); and
- the 90/10 system for requirements with a Rand value above R50 000 000 (all applicable taxes included).

### 1.2 Preference Points System to be applied

*(tick whichever is applicable).*

- The applicable preference point system for this tender is the **80/20** preference point system.
- The applicable preference point system for this tender is the **90/10** preference point system.
- Either the **90/10** or **80/20** preference point system will be applicable in this tender. The lowest/ highest acceptable tender will be used to determine the accurate system once tenders are received.

### 1.3 Points for this tender shall be awarded for:

1.3.1 Price; and

1.3.2 Specific Goals

### 1.4 The maximum points for this tender are allocated as follows:

CHOOSE APPLICABLE PREFERENCE POINT SCORING SYSTEM	<input checked="" type="checkbox"/> 80/20	<input type="checkbox"/> 90/10
PRICE	80	90
SPECIFIC GOALS	20	10
<b>Total points for Price and Specific Goals</b>	<b>100</b>	<b>100</b>

1.5 Breakdown Allocation of Specific Goals Points

**1.5.1. For procurement transaction with rand value greater than R2 000, 00 and up to R1 Million (Inclusive of all applicable taxes) the specific goals listed in table 1 below are applicable.**

**Table 1**

Serial No	Specific Goals	Preference Points Allocated out of 20	Documentation to be submitted by bidders to validate their claim
1.	An EME or QSE which is at least 51% owned by black people (Mandatory)	10	<ul style="list-style-type: none"> <li>SANAS Accredited BBBEE Certificate or Sworn Affidavit where applicable.</li> </ul>
2.	Located in a specific Local Municipality or District Municipality or Metro or Province area for work to be done or services to be rendered in that area (Mandatory)	2	<ul style="list-style-type: none"> <li>Official Municipal Rates Statement which is in the name of the bidder.</li> </ul> <p>Or</p> <ul style="list-style-type: none"> <li>Any account or statement which is in the name of the bidder.</li> </ul> <p>Or</p> <ul style="list-style-type: none"> <li>Permission to Occupy from local chief in case of rural areas (PTO) which is in the name of the bidder.</li> </ul> <p>Or</p> <ul style="list-style-type: none"> <li>Lease Agreement which is in the name of the bidder.</li> </ul>
3.	An EME or QSE which is at least 51% owned by black women (Mandatory)	4	<ul style="list-style-type: none"> <li>SANAS Accredited BBBEE Certificate or Sworn Affidavit where applicable.</li> </ul>
4.	An EME or QSE which is at least 51% owned by black	2	<ul style="list-style-type: none"> <li>SANAS Accredited BBBEE Certificate or Sworn Affidavit where applicable.</li> </ul>

	people with disability (Mandatory)		and <ul style="list-style-type: none"> <li>• Medical Certificate indicating that the disability is permanent.</li> </ul> Or <ul style="list-style-type: none"> <li>• South African Social Security Agency (SASSA) Registration indicating that the disability is permanent.</li> </ul> Or <ul style="list-style-type: none"> <li>• National Council for Persons with Physical Disability in South Africa registration (NCPDPSA).</li> </ul>
5.	An EME or QSE which is at least 51% owned by black youth (Mandatory)	2	<ul style="list-style-type: none"> <li>• ID Copy and SANAS Accredited BBBEE Certificate or Sworn Affidavit where applicable.</li> </ul>



**1.5.2. For procurement transaction with rand value greater than R1 Million and up to R50 Million (Inclusive of all applicable taxes) the specific goals listed in table 2 below are applicable.**

**Table 2**

Serial No	Specific Goals	Preference Points Allocated out of 20	Documentation to be submitted by bidders to validate their claim
1.	An EME or QSE or any entity which is at least 51% owned by black people (Mandatory)	10	<ul style="list-style-type: none"> <li>• SANAS Accredited BBBEE Certificate or Sworn Affidavit where applicable.</li> </ul>
2.	Located in a specific Local Municipality or District Municipality or Metro or Province area for work to be done or services to be rendered in that area (Mandatory)	2	<ul style="list-style-type: none"> <li>• Official Municipal Rates Statement which is in the name of the bidder.</li> </ul> Or

			<ul style="list-style-type: none"> <li>Any account or statement which is in the name of the bidder.</li> </ul> <p>Or</p> <ul style="list-style-type: none"> <li>Permission to Occupy from local chief in case of rural areas (PTO) which is in the name of the bidder.</li> </ul> <p>Or</p> <ul style="list-style-type: none"> <li>Lease Agreement which is in the name of the bidder.</li> </ul>
3.	An EME or QSE or any entity which is at least 51% owned by black women (Mandatory)	4	<ul style="list-style-type: none"> <li>SANAS Accredited BBBEE Certificate or Sworn Affidavit where applicable.</li> </ul>
4.	An EME or QSE or any entity which is at least 51% owned by black people with disability (Mandatory)	2	<ul style="list-style-type: none"> <li>SANAS Accredited BBBEE Certificate or Sworn Affidavit where applicable.</li> </ul> <p>and</p> <ul style="list-style-type: none"> <li>Medical Certificate indicating that the disability is permanent.</li> </ul> <p>Or</p> <ul style="list-style-type: none"> <li>South African Social Security Agency (SASSA) Registration indicating that the disability is permanent.</li> </ul> <p>Or</p> <p>National Council for Persons with Physical Disability in South Africa registration (NCPDSA).</p>

5.	An EME or QSE or any entity which is at least 51% owned by black youth (Mandatory)	2	<ul style="list-style-type: none"> <li>ID Copy and SANAS Accredited BBBEE Certificate or Sworn Affidavit where applicable.</li> </ul>
----	--	---	---

**1.5.3. For procurement transaction with rand value greater than R50 Million (Inclusive of all applicable taxes) the specific goals listed in table 3 below are applicable.**



**NB. The use of one of goal numbers' 4 or 5 is mandatory. The BSC must select either one of the two, but not both.**

**Table 3**

Serial No	Specific Goals	Preference Points Allocated out of 10	Documentation to be submitted by bidders to validate their claim
1.	An EME or QSE or any entity which is at least 51% owned by black people (Mandatory)	4	<ul style="list-style-type: none"> <li>SANAS Accredited BBBEE Certificate or Sworn Affidavit where applicable.</li> </ul>
2.	Located in a specific Local Municipality or District Municipality or Metro or Province area for work to be done or services to be rendered in that area (Mandatory)	2	<ul style="list-style-type: none"> <li>Official Municipal Rates Statement which is in the name of the bidder.</li> </ul> <p>Or</p> <ul style="list-style-type: none"> <li>Any account or statement which is in the name of the bidder.</li> </ul> <p>Or</p> <ul style="list-style-type: none"> <li>Permission to Occupy from local chief in case of rural areas (PTO) which is in the name of the bidder.</li> </ul> <p>Or</p> <ul style="list-style-type: none"> <li>Lease Agreement which is in the name of the bidder.</li> </ul>

	3.	An EME or QSE or any entity which is at least 51% owned by black women (mandatory)	2	<ul style="list-style-type: none"> <li>• SANAS Accredited BBEE Certificate or Sworn Affidavit where applicable.</li> </ul>
	4. <input type="checkbox"/>	An EME or QSE or any entity which is at least 51% owned by black people with disability (Mandatory)	2	<ul style="list-style-type: none"> <li>• SANAS Accredited BBEE Certificate or Sworn Affidavit where applicable.</li> </ul> <p>and</p> <ul style="list-style-type: none"> <li>• Medical Certificate indicating that the disability is permanent.</li> </ul> <p>Or</p> <ul style="list-style-type: none"> <li>• South African Social Security Agency (SASSA) Registration indicating that the disability is permanent.</li> </ul> <p>Or</p> <p>National Council for Persons with Physical Disability in South Africa registration (NCPDPSA).</p>
	<b>OR</b>			
	5. <input type="checkbox"/>	An EME or QSE or any entity which is at least 51% owned by black youth (Mandatory)	2	<ul style="list-style-type: none"> <li>• ID Copy and SANAS Accredited BBEE Certificate or Sworn Affidavit where applicable</li> </ul>

**Black people** mean Africans, Coloureds and Indians, who - (a) are citizens of the Republic of South Africa by birth or descent; or (b) became citizens of the Republic of South Africa by naturalisation - (i) before 27 April 1994; or (ii) on or after 27 April 1994 and who would have been entitled to acquire citizenship by naturalisation prior to that date. (BROAD-BASED BLACK ECONOMIC EMPOWERMENT ACT No 25899, 2003 of 9 JANUARY 2004).

- 1.6 Failure on the part of the tenderer to submit proof or documentation required in terms of this tender to claim points for specific goals, if the service provider/ tenderer did not submit proof or documentation required to claim for specific goals will be interpreted to mean that preference points for specific goals are not claimed.
- 1.7 The organ of state reserves the right to require of a service provider/tenderer, either before a tender is adjudicated or at any time subsequently, to substantiate any claim in regard to preferences, in any manner required by the organ of state.

## 2. DEFINITIONS

- (a) “**tender**” means a written offer in the form determined by an organ of state in response to an invitation to provide goods or services through price quotations, competitive tendering process or any other method envisaged in legislation;
- (b) “**price**” means an amount of money tendered for goods or services, and includes all applicable taxes less all unconditional discounts;
- (c) “**rand value**” means the total estimated value of a contract in Rand, calculated at the time of bid invitation, and includes all applicable taxes;
- (d) “**tender for income-generating contracts**” means a written offer in the form determined by an organ of state in response to an invitation for the origination of income-generating contracts through any method envisaged in legislation that will result in a legal agreement between the organ of state and a third party that produces revenue for the organ of state, and includes, but is not limited to, leasing and disposal of assets and concession contracts, excluding direct sales and disposal of assets through public auctions; and
- (e) “**the Act**” means the Preferential Procurement Policy Framework Act, 2000 (Act No. 5 of 2000).

### 3. FORMULAE FOR PROCUREMENT OF GOODS AND SERVICES

#### 3.1. POINTS AWARDED FOR PRICE

##### 3.1.1. THE 80/20 OR 90/10 PREFERENCE POINT SYSTEMS

A maximum of 80 or 90 points is allocated for price on the following basis:

$$\begin{array}{ccc}
 \mathbf{80/20} & \mathbf{or} & \mathbf{90/10} \\
 \\
 \mathbf{Ps} = \mathbf{80} \left( \mathbf{1} - \frac{\mathbf{Pt} - \mathbf{P min}}{\mathbf{P min}} \right) & \mathbf{or} & \mathbf{Ps} = \mathbf{90} \left( \mathbf{1} - \frac{\mathbf{Pt} - \mathbf{P min}}{\mathbf{P min}} \right)
 \end{array}$$

Where

Ps = Points scored for price of tender under consideration

Pt = Price of tender under consideration

Pmin = Price of lowest acceptable tender

#### 3.2. FORMULAE FOR DISPOSAL OR LEASING OF STATE ASSETS AND INCOME GENERATING PROCUREMENT

##### 3.2.1. POINTS AWARDED FOR PRICE

A maximum of 80 or 90 points is allocated for price on the following basis:

$$\begin{array}{ccc}
 \mathbf{80/20} & \mathbf{or} & \mathbf{90/10} \\
 \\
 \mathbf{Ps} = \mathbf{80} \left( \mathbf{1} + \frac{\mathbf{Pt} - \mathbf{P max}}{\mathbf{P max}} \right) & \mathbf{or} & \mathbf{Ps} = \mathbf{90} \left( \mathbf{1} + \frac{\mathbf{Pt} - \mathbf{P max}}{\mathbf{P max}} \right)
 \end{array}$$

Where

Ps = Points scored for price of tender under consideration

Pt = Price of tender under consideration

Pmax = Price of highest acceptable tender

#### 4. POINTS AWARDED FOR SPECIFIC GOALS

4.1. In terms of Regulation 4(2); 5(2); 6(2) and 7(2) of the Preferential Procurement Regulations, preference points must be awarded for specific goals stated in the tender. For the purposes of this tender the tenderer will be allocated points based on the goals stated in table 1,2 and 3 above as may be supported by proof/ documentation stated in the conditions of this tender:

4.2. In cases where organs of state intend to use Regulation 3(2) of the Regulations, which states that, if it is unclear whether the 80/20 or 90/10 preference point system applies, an organ of state must, in the tender documents, stipulate in the case of—

(a) an invitation for tender for income-generating contracts, that either the 80/20 or 90/10 preference point system will apply and that the highest acceptable tender will be used to determine the applicable preference point system; or

(b) any other invitation for tender, that either the 80/20 or 90/10 preference point system will apply and that the lowest acceptable tender will be used to determine the applicable preference point system,

then the organ of state must indicate the points allocated for specific goals for both the 90/10 and 80/20 preference point system.

**Table 4: Specific goals for the tender and points claimed are indicated per the table below.**

*(Note to organs of state: Where either the 90/10 or 80/20 preference point system is applicable, corresponding points must also be indicated as such.)*

*Note to tenderers: The tenderer must indicate how they claim points for each preference point system.)*

The specific goals allocated points in terms of this tender	Number of points allocated (90/10 system) (To be completed by the organ of state)	Number of points allocated (80/20 system) (To be completed by the organ of state)	Number of points claimed (90/10 system) (To be completed by the tenderer)	Number of points claimed (80/20 system) (To be completed by the tenderer)
1. An EME or QSE (or any entity for procurement transaction with rand value greater than R1 Million)	4	10		

The specific goals allocated points in terms of this tender	Number of points allocated (90/10 system) (To be completed by the organ of state)	Number of points allocated (80/20 system) (To be completed by the organ of state)	Number of points claimed (90/10 system) (To be completed by the tenderer)	Number of points claimed (80/20 system) (To be completed by the tenderer)
which is at least 51% owned by black people				
2. Located in a specific Local Municipality or District Municipality or Metro or Province area for work to be done or services to be rendered in that area	2	2		
3. An EME or QSE (or any entity for procurement transaction with rand value greater than R1 Million) which is at least 51% owned by black women	2	4		
4. An EME or QSE (or any entity for procurement transaction with rand value greater than R1 Million) which is at least 51% owned by black people with disability	2	2		
5. An EME or QSE (or any entity for procurement transaction with rand value greater than R1 Million) which is at least 51% owned by black youth.*	2	2		

**DECLARATION WITH REGARD TO COMPANY/FIRM**

4.3. Name of company/firm.....

4.4. Company registration number: .....

4.5. TYPE OF COMPANY/ FIRM

Partnership/Joint Venture / Consortium

- One-person business/sole propriety
- Close corporation
- Public Company
- Personal Liability Company
- (Pty) Limited
- Non-Profit Company
- State Owned Company

[TICK APPLICABLE BOX]

4.6. I, the undersigned, who is duly authorised to do so on behalf of the company/firm, certify that the points claimed, based on the specific goals as advised in the tender, qualifies the company/ firm for the preference(s) shown and I acknowledge that:

- i) The information furnished is true and correct;
- ii) The preference points claimed are in accordance with the General Conditions as indicated in paragraph 1 of this form;
- iii) In the event of a contract being awarded as a result of points claimed as shown in paragraphs 1.4 and 4.2, the contractor may be required to furnish documentary proof to the satisfaction of the organ of state that the claims are correct;
- iv) If the specific goals have been claimed or obtained on a fraudulent basis or any of the conditions of contract have not been fulfilled, the organ of state may, in addition to any other remedy it may have –
  - (a) disqualify the person from the tendering process;
  - (b) recover costs, losses or damages it has incurred or suffered as a result of that person's conduct;
  - (c) cancel the contract and claim any damages which it has suffered as a result of having to make less favourable arrangements due to such cancellation;
  - (d) recommend that the tenderer or contractor, its shareholders and directors, or only the shareholders and directors who acted on a fraudulent basis, be restricted from obtaining business from any organ of state for a period not exceeding 10 years, after the *audi alteram partem* (hear the other side) rule has been applied; and
  - (e) forward the matter for criminal prosecution, if deemed necessary.

.....

**SIGNATURE(S) OF TENDERER(S)**

**SURNAME AND NAME:** .....

**DATE:** .....

**ADDRESS:** .....

.....

.....

.....

# PA- 40: DECLARATION OF DESIGNATED GROUPS

Tender no: **DBN26/07/01**

Name of Tenderer .....

EME<sup>1</sup>  QSE<sup>2</sup>  Non EME/QSE (tick applicable box)

**1. LIST ALL PROPRIETORS, MEMBERS OR SHAREHOLDERS BY NAME, IDENTITY NUMBER, CITIZENSHIP AND DESIGNATED GROUPS.**

Name and Surname #	Identity/ Passport number and Citizenship##	Percentage owned	Black	Indicate if youth	Indicate if woman	Indicate if person with disability	Indicate if living in Rural (R) / Under Developed Area (UD) / Township (T) / Urban (U).	Indicate if military veteran
1.		%	<input type="checkbox"/> Yes <input type="checkbox"/> No	<input type="checkbox"/> Yes <input type="checkbox"/> No	<input type="checkbox"/> Yes <input type="checkbox"/> No	<input type="checkbox"/> Yes <input type="checkbox"/> No	<input type="checkbox"/> R <input type="checkbox"/> UD <input type="checkbox"/> T <input type="checkbox"/> U	<input type="checkbox"/> Yes <input type="checkbox"/> No
2.		%	<input type="checkbox"/> Yes <input type="checkbox"/> No	<input type="checkbox"/> Yes <input type="checkbox"/> No	<input type="checkbox"/> Yes <input type="checkbox"/> No	<input type="checkbox"/> Yes <input type="checkbox"/> No	<input type="checkbox"/> R <input type="checkbox"/> UD <input type="checkbox"/> T <input type="checkbox"/> U	<input type="checkbox"/> Yes <input type="checkbox"/> No
3.		%	<input type="checkbox"/> Yes <input type="checkbox"/> No	<input type="checkbox"/> Yes <input type="checkbox"/> No	<input type="checkbox"/> Yes <input type="checkbox"/> No	<input type="checkbox"/> Yes <input type="checkbox"/> No	<input type="checkbox"/> R <input type="checkbox"/> UD <input type="checkbox"/> T <input type="checkbox"/> U	<input type="checkbox"/> Yes <input type="checkbox"/> No
4.		%	<input type="checkbox"/> Yes <input type="checkbox"/> No	<input type="checkbox"/> Yes <input type="checkbox"/> No	<input type="checkbox"/> Yes <input type="checkbox"/> No	<input type="checkbox"/> Yes <input type="checkbox"/> No	<input type="checkbox"/> R <input type="checkbox"/> UD <input type="checkbox"/> T <input type="checkbox"/> U	<input type="checkbox"/> Yes <input type="checkbox"/> No
5.		%	<input type="checkbox"/> Yes <input type="checkbox"/> No	<input type="checkbox"/> Yes <input type="checkbox"/> No	<input type="checkbox"/> Yes <input type="checkbox"/> No	<input type="checkbox"/> Yes <input type="checkbox"/> No	<input type="checkbox"/> R <input type="checkbox"/> UD <input type="checkbox"/> T <input type="checkbox"/> U	<input type="checkbox"/> Yes <input type="checkbox"/> No
6.		%	<input type="checkbox"/> Yes <input type="checkbox"/> No	<input type="checkbox"/> Yes <input type="checkbox"/> No	<input type="checkbox"/> Yes <input type="checkbox"/> No	<input type="checkbox"/> Yes <input type="checkbox"/> No	<input type="checkbox"/> R <input type="checkbox"/> UD <input type="checkbox"/> T <input type="checkbox"/> U	<input type="checkbox"/> Yes <input type="checkbox"/> No
7.		%	<input type="checkbox"/> Yes <input type="checkbox"/> No	<input type="checkbox"/> Yes <input type="checkbox"/> No	<input type="checkbox"/> Yes <input type="checkbox"/> No	<input type="checkbox"/> Yes <input type="checkbox"/> No	<input type="checkbox"/> R <input type="checkbox"/> UD <input type="checkbox"/> T <input type="checkbox"/> U	<input type="checkbox"/> Yes <input type="checkbox"/> No
8.		%	<input type="checkbox"/> Yes <input type="checkbox"/> No	<input type="checkbox"/> Yes <input type="checkbox"/> No	<input type="checkbox"/> Yes <input type="checkbox"/> No	<input type="checkbox"/> Yes <input type="checkbox"/> No	<input type="checkbox"/> R <input type="checkbox"/> UD <input type="checkbox"/> T <input type="checkbox"/> U	<input type="checkbox"/> Yes <input type="checkbox"/> No
9.		%	<input type="checkbox"/> Yes <input type="checkbox"/> No	<input type="checkbox"/> Yes <input type="checkbox"/> No	<input type="checkbox"/> Yes <input type="checkbox"/> No	<input type="checkbox"/> Yes <input type="checkbox"/> No	<input type="checkbox"/> R <input type="checkbox"/> UD <input type="checkbox"/> T <input type="checkbox"/> U	<input type="checkbox"/> Yes <input type="checkbox"/> No
10.		%	<input type="checkbox"/> Yes <input type="checkbox"/> No	<input type="checkbox"/> Yes <input type="checkbox"/> No	<input type="checkbox"/> Yes <input type="checkbox"/> No	<input type="checkbox"/> Yes <input type="checkbox"/> No	<input type="checkbox"/> R <input type="checkbox"/> UD <input type="checkbox"/> T <input type="checkbox"/> U	<input type="checkbox"/> Yes <input type="checkbox"/> No
11.		%	<input type="checkbox"/> Yes <input type="checkbox"/> No	<input type="checkbox"/> Yes <input type="checkbox"/> No	<input type="checkbox"/> Yes <input type="checkbox"/> No	<input type="checkbox"/> Yes <input type="checkbox"/> No	<input type="checkbox"/> R <input type="checkbox"/> UD <input type="checkbox"/> T <input type="checkbox"/> U	<input type="checkbox"/> Yes <input type="checkbox"/> No
12.		%	<input type="checkbox"/> Yes <input type="checkbox"/> No	<input type="checkbox"/> Yes <input type="checkbox"/> No	<input type="checkbox"/> Yes <input type="checkbox"/> No	<input type="checkbox"/> Yes <input type="checkbox"/> No	<input type="checkbox"/> R <input type="checkbox"/> UD <input type="checkbox"/> T <input type="checkbox"/> U	<input type="checkbox"/> Yes <input type="checkbox"/> No

1 EME: Exempted Micro Enterprise

2 QSE: Qualifying Small Business Enterprise

## PA- 40: DECLARATION OF DESIGNATED GROUPS

# Where Owners are themselves a Company, Close Corporation, Partnership etc, identify the ownership of the Holding Company, together with Registration number  
## State date of South African citizenship obtained (not applicable to persons born in South Africa)

Tender no: **DBN26/07/01**

### 2. DECLARATION:

The undersigned, who warrants that he/she is duly authorized to do so on behalf of the Tenderer, hereby confirms that:

- 1 The information and particulars contained in this Affidavit are true and correct in all respects;
- 2 The Broad-based Black Economic Empowerment Act, 2003 (Act 53 of 2003), Preferential Procurement Policy Framework Act, 2000 (Act 5 of 2000), National Small Business Act 102 of 1996 as amended and all documents pertaining to this Tender were studied and understood and that the above form was completed according to the definitions and information contained in said documents;
- 3 The Tenderer understands that any intentional misrepresentation or fraudulent information provided herein shall disqualify the Tenderer's offer herein, as well as any other tender offer(s) of the Tenderer simultaneously being evaluated, or will entitle the Employer to cancel any Contract resulting from the Tenderer's offer herein;
- 4 The Tenderer accepts that the Employer may exercise any other remedy it may have in law and in the Contract, including a claim for damages for having to accept a less favourable tender as a result of any such disqualification due to misrepresentation or fraudulent information provided herein;
- 5 Any further documentary proof required by the Employer regarding the information provided herein, will be submitted to the Employer within the time period as may be set by the latter;

**Signed by the Tenderer**

Name of representative	Signature	Date

MANAGER OFFICE + OPEN PLAN CLUSTER • WOOD FINISHES

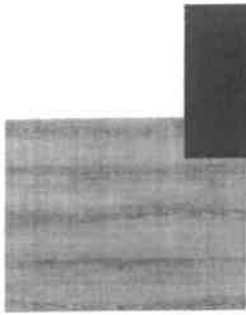

—FAIRMING—ASH—  
*Cherry*  
1 X MANAGER  
OFFICE +  
1 X OPEN PLAN  
CLUSTER

BLACK

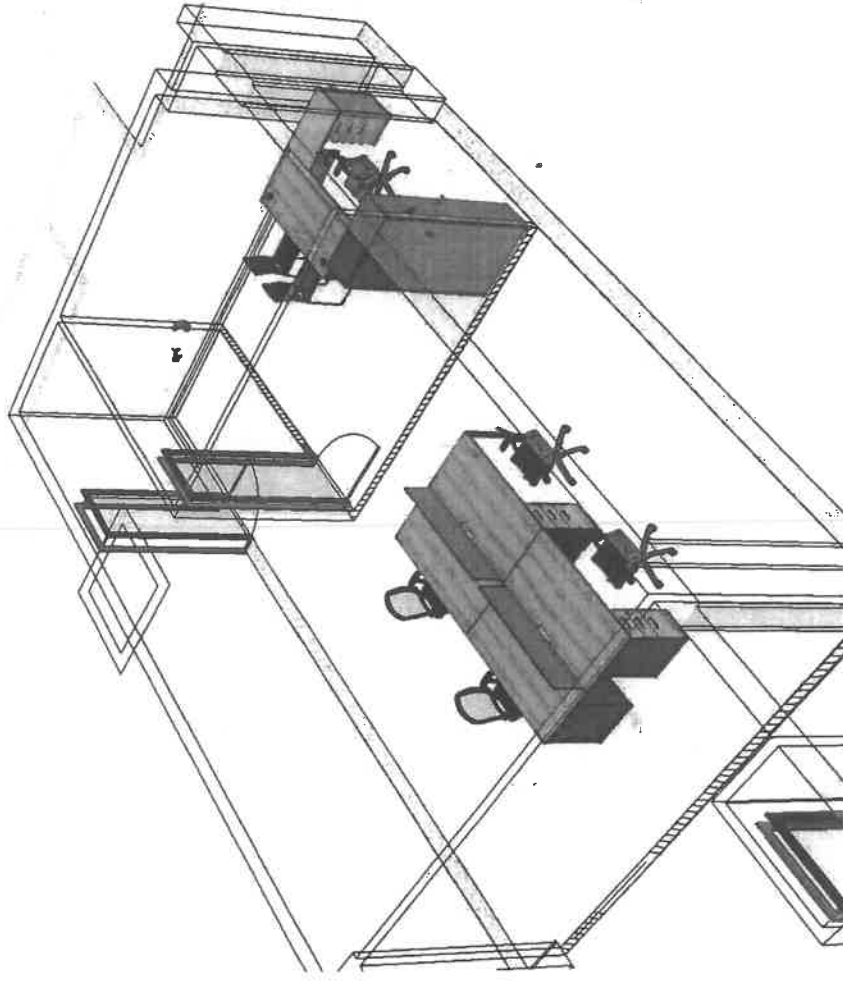

GROUND FLOOR SECURITY PERSPECTIVE

**SECURITY OPEN PLAN**

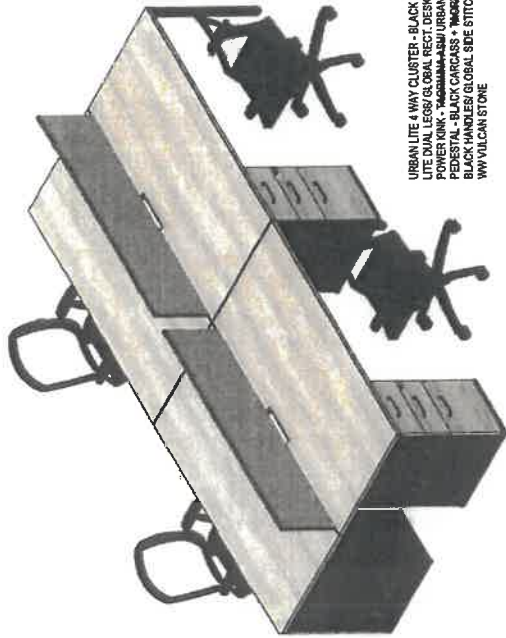

URBAN LITE 4 WAY CLUSTER - BLACK URBAN LITE DIAL LEGS/ GLOBAL RECT. DESK TOP WITH POWER KINK - BLACK CARCASS - URBAN LITE DESK HEIGHT PEDESTAL - BLACK HANDLES/ GLOBAL SIDE STITCH DESK BASED SCREENS - W/VULCAN STONE



GRID TASK CHAIR WITH SIMPLE MECHANISM

**D.D SECURITY OFFICE**

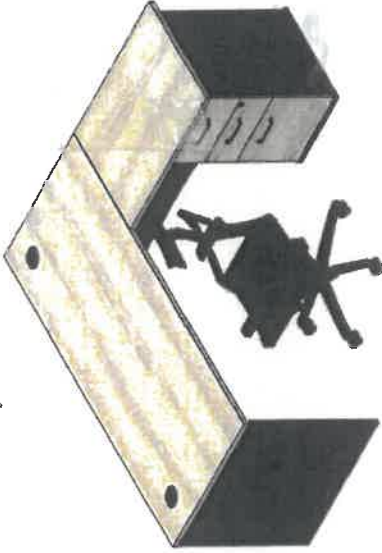

XPRESS RECT. DESK (180 X 750mm) - URBAN LITE DESK HEIGHT PEDESTAL AND URBAN LITE DESK HEIGHT PEDESTAL



LINK TASK CHAIR WITH HEADREST



LIBRA SLEIGH BASE VISITOR CHAIR - BLACK



METAL STATIONARY CABINET - BLACK

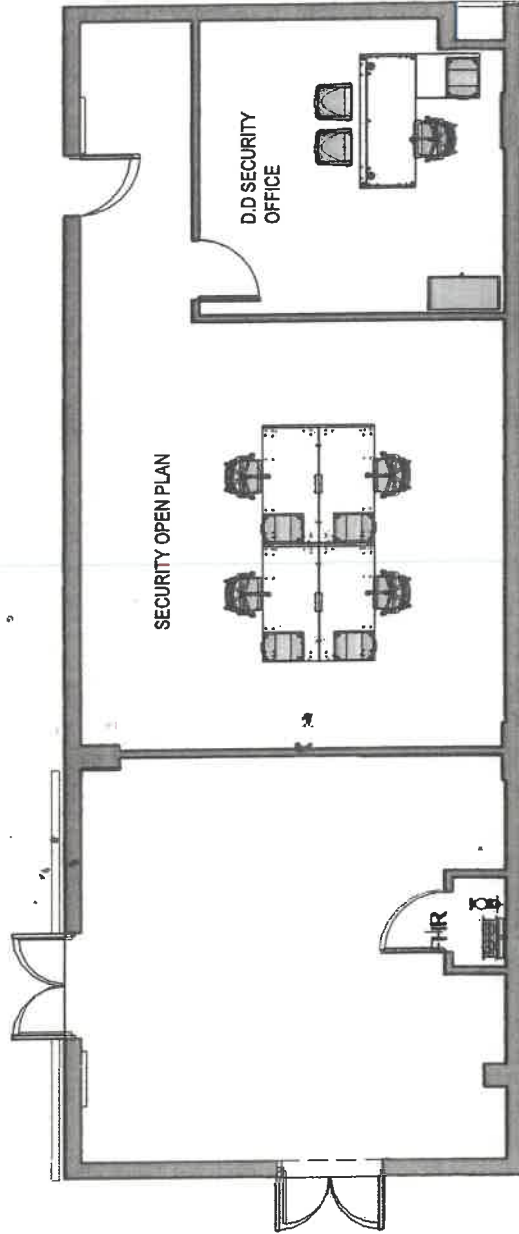

**GROUND FLOOR SECURITY PLAN**

**DEPUTY DIRECTOR OFFICE**



LEGACY EXEC DESK WITH DROPPED SIDE - EXTENSION STORAGE UNIT -  
 1800MM WIDE PAIRED WITH ANTRACITE



ARCO TASK CHAIR WITH HEADREST



CJUSTORS CHAIR - TAN

**SCM BOARDROOM**

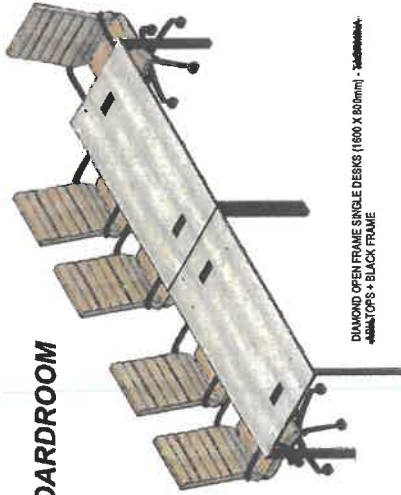

DIAMOND OPEN FRAME SINGLE DESKS (1600 X 800mm) -  
 4MM TOPS + BLACK FRAME



CLASSICAL MB CHAIRS - TAN



UNIQ MUTE SERVER UNIT - BLACK WITH  
 SLATE GREY PET SLIDING DOOR

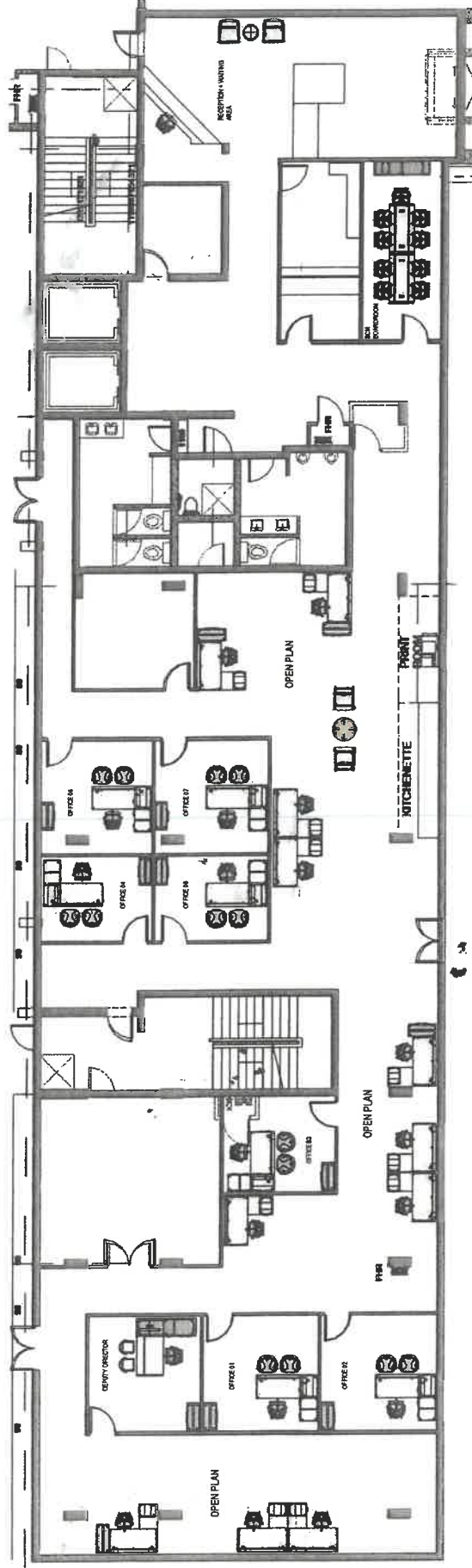

**OPEN PLAN COLAB TABLE**



WAY2RICHARDS - MAY COFFEE TABLE (750mm DIA)

**RECEPTION WAITING AREA**

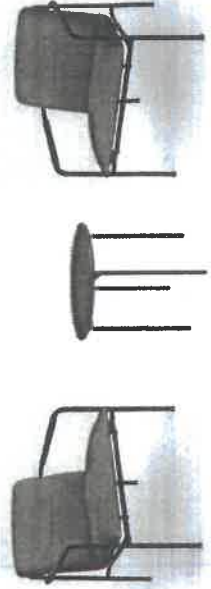

FLAT ARMCHAIR - GREEN FABRIC

SELENA SIDE TABLE

**GROUND-FLOOR PLAN**

**THUTHUKA OFFICE - WOOD FINISHES**

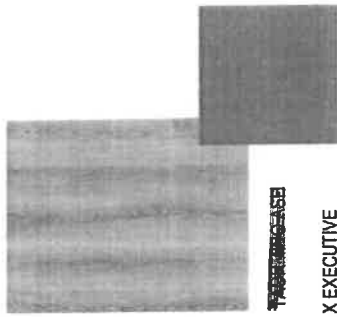

**FORMAL OFFICE**

**1 X EXECUTIVE OFFICE**

**ANTHRACITE**

**OFFICES + OPEN PLAN - WOOD FINISHES**

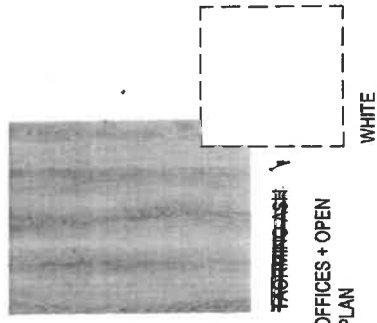

**FORMAL OFFICE**

**OFFICES + OPEN PLAN**

**WHITE**

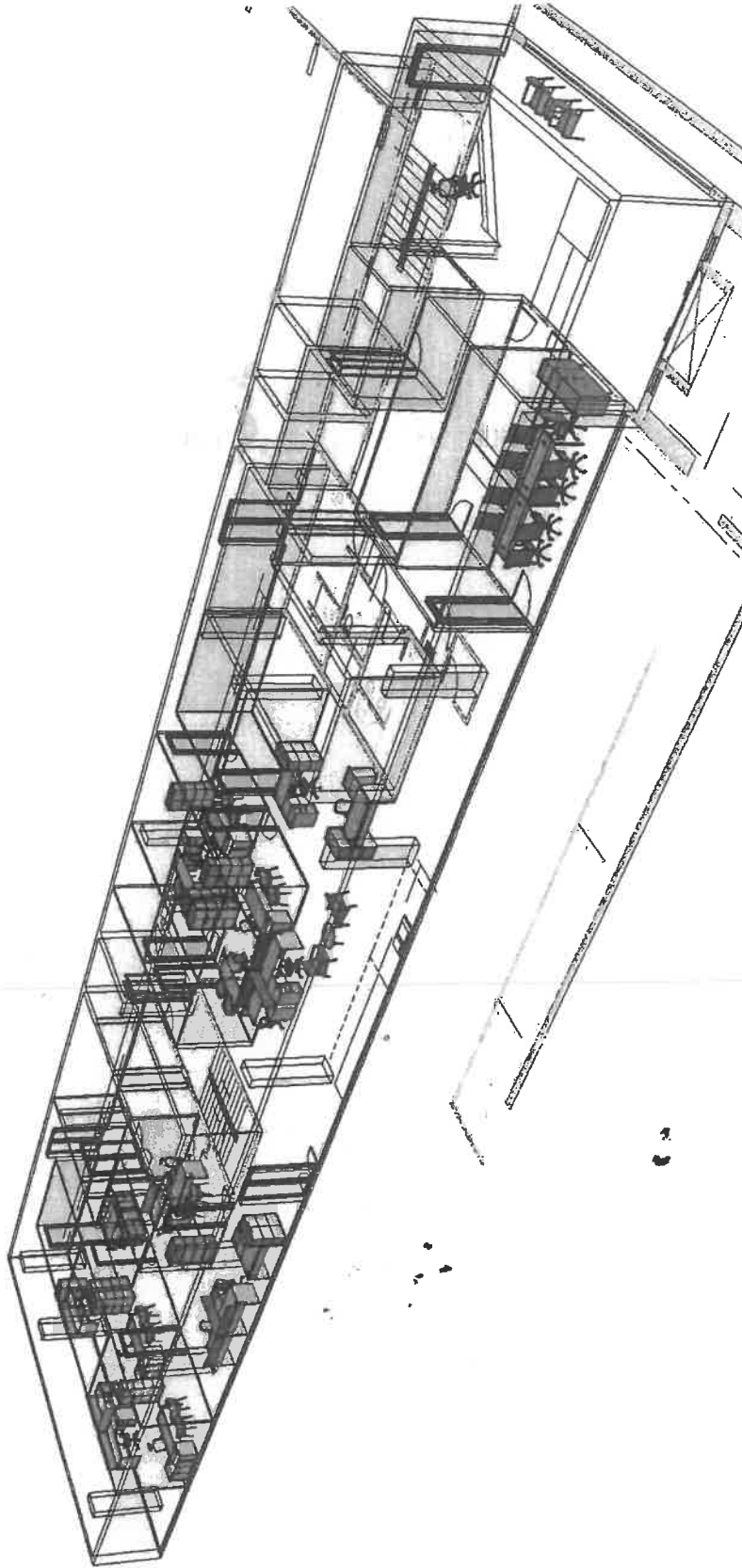

**GROUND FLOOR PERSPECTIVE**

# D.D ADMIN EXEC OFFICE



LEGACY EXEC DESK WITH DROPPED SIDE L - EXTENSION STORAGE UNIT - WITH ANTHRACITE



ARCO TASK CHAIR WITH HEADREST

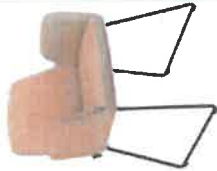

C-VISITORS CHAIR - TAN

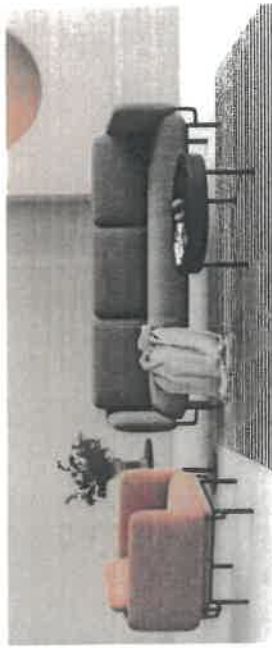

BREEZE DOUBLE + SINGLE SEATERS - GREY & ORANGE FABRIC - TRAY COFFEE TABLE BLACK (800mm DIA) + SELEMA SIDE TABLE/ BARON OBLONG LAPTOP TABLE - BLACK

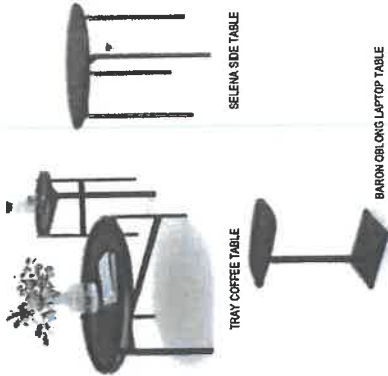

TRAY COFFEE TABLE

SELEMA SIDE TABLE

BARON OBLONG LAPTOP TABLE

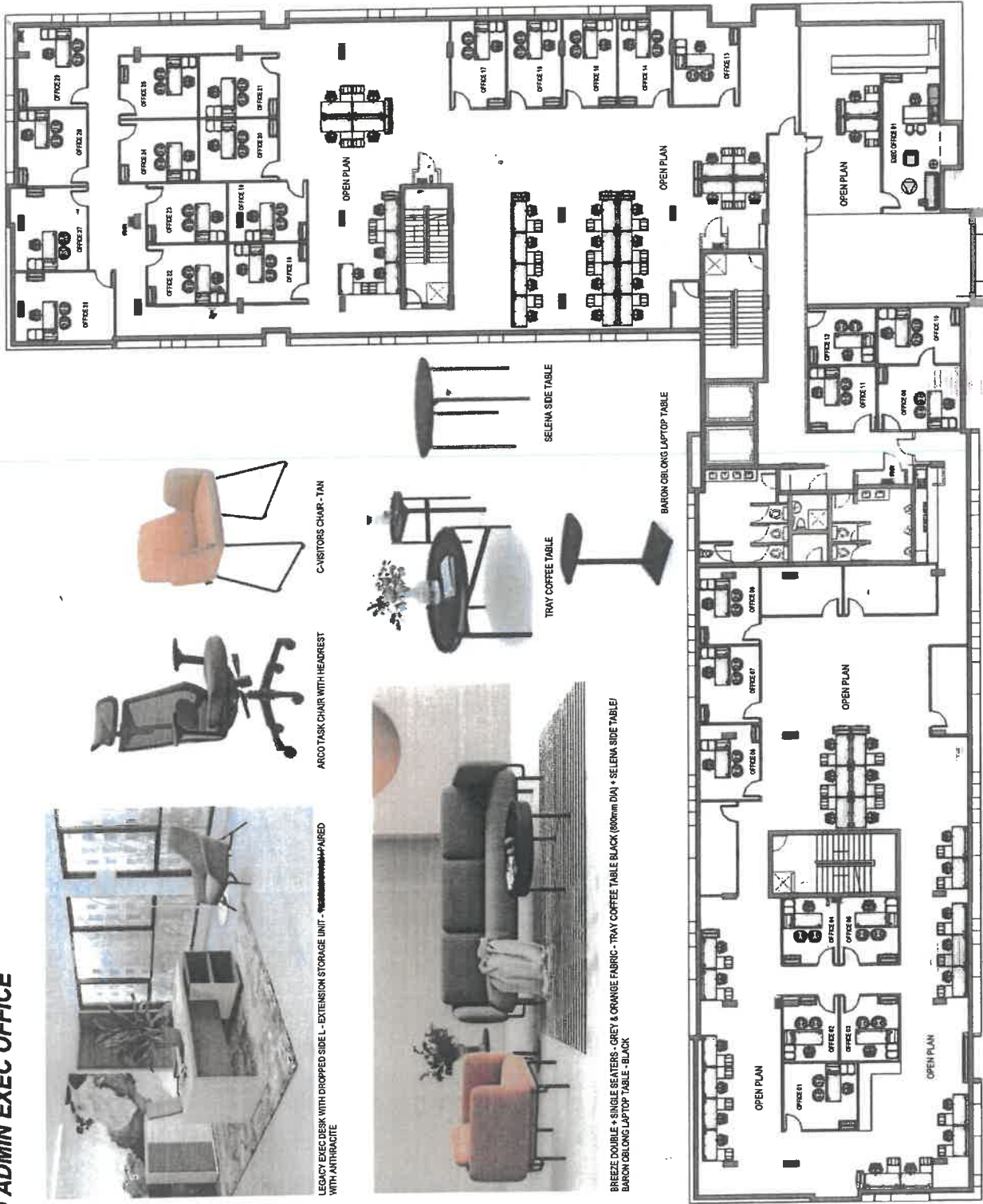

THUTHUKA OFFICE - WOOD FINISHES



PROGRAMMING CENTER

1 X EXECUTIVE OFFICE

ANTHRACITE

OFFICES + OPEN PLAN - WOOD FINISHES

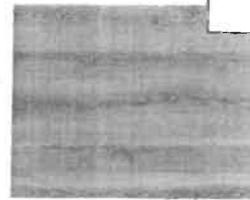

PROGRAMMING CENTER

OFFICES + OPEN PLAN

WHITE

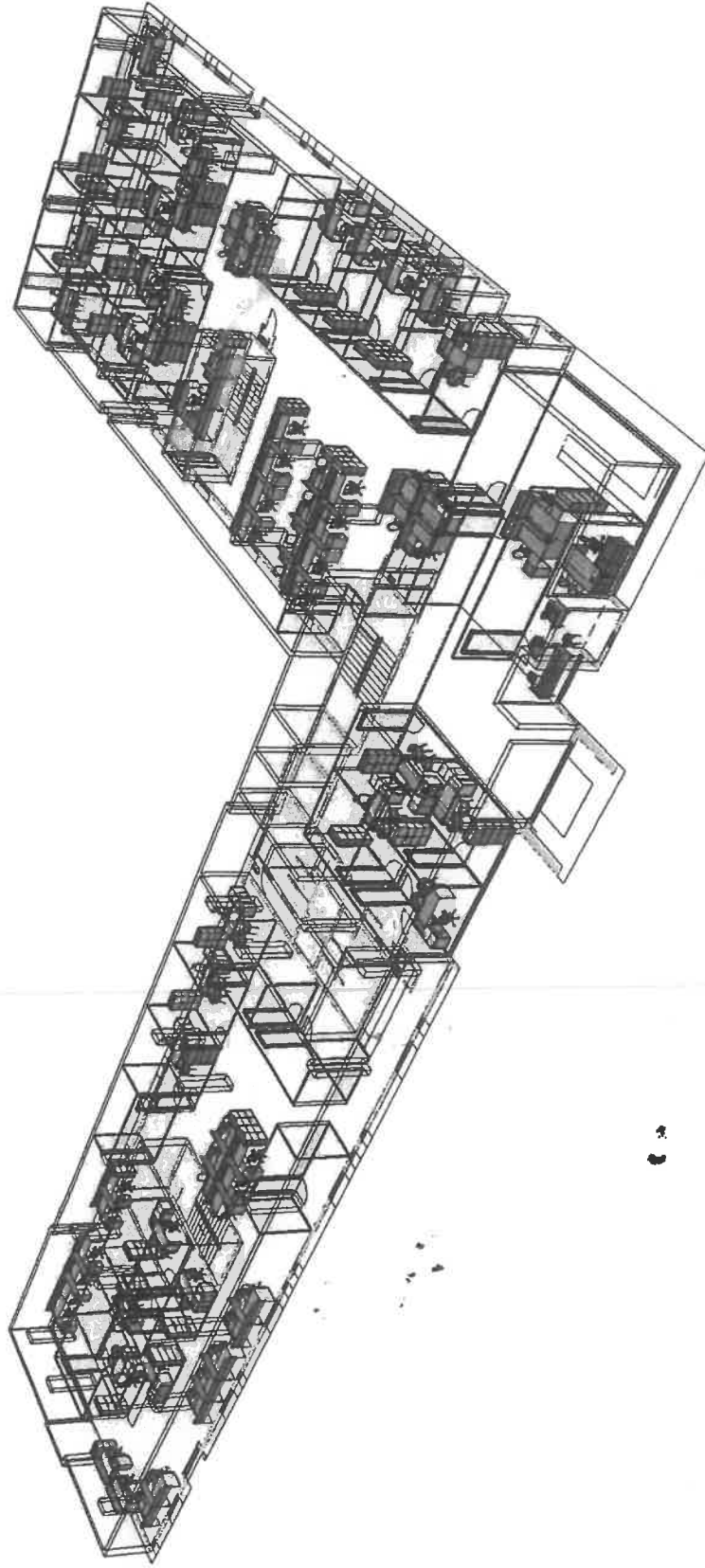

FIRST FLOOR PERSPECTIVE

**SHARED BOARDROOM**

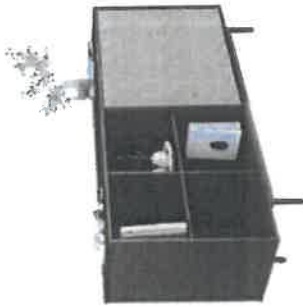
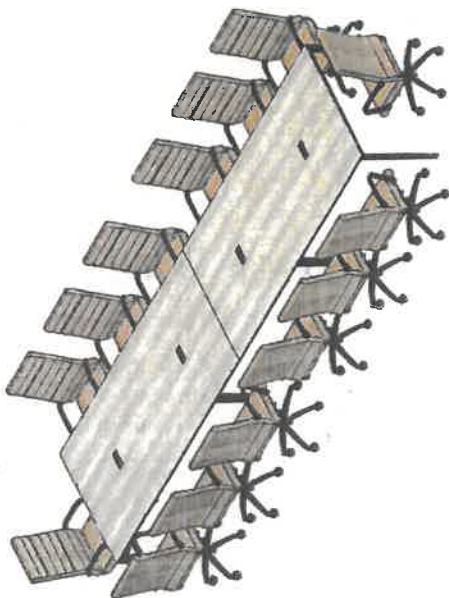

**UNIQU MUTE SERVER UNIT**

**DIAMOND OPEN BOARDROOM FRAME + INTERMEDIATE LEGS - BLACK!  
DIAMOND 2 PIECE BOARDROOM TOP - TACORNA ASH WITH BLACK CABLE OUTLET COVERS (4800 L X 1200mm W)**

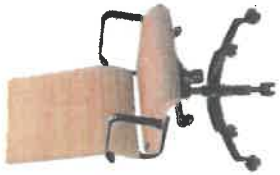

**CLASSICAL HIB CHAIR - TAN BONDED LEATHER**

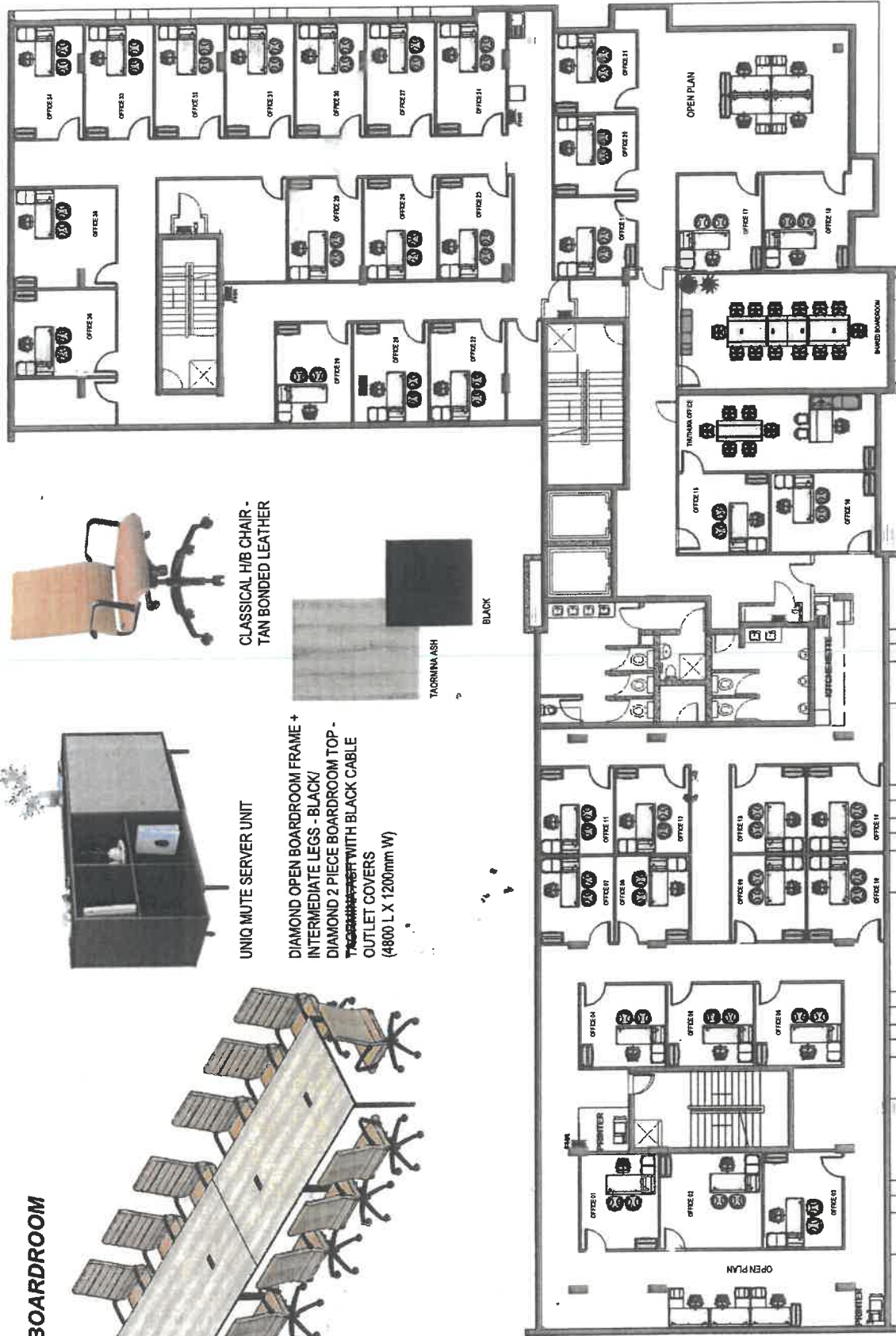
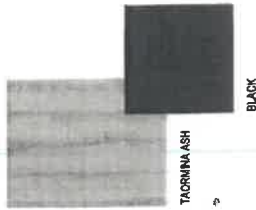

**SECOND FLOOR PLAN**

**THUTHUKA OFFICE - WOOD FINISHES**

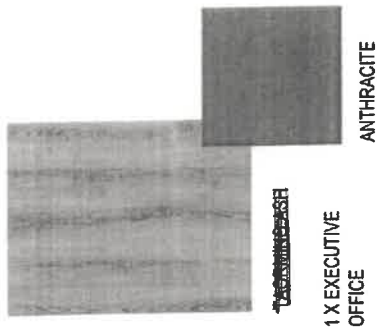

1 X EXECUTIVE OFFICE

ANTHRACITE

**OFFICES + OPEN PLAN - WOOD FINISHES**

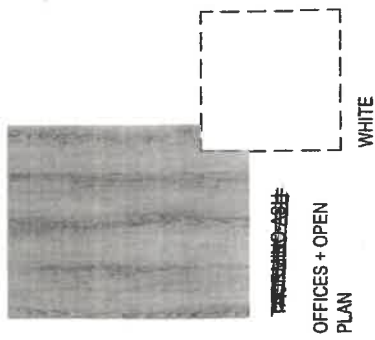

OFFICES + OPEN PLAN

WHITE

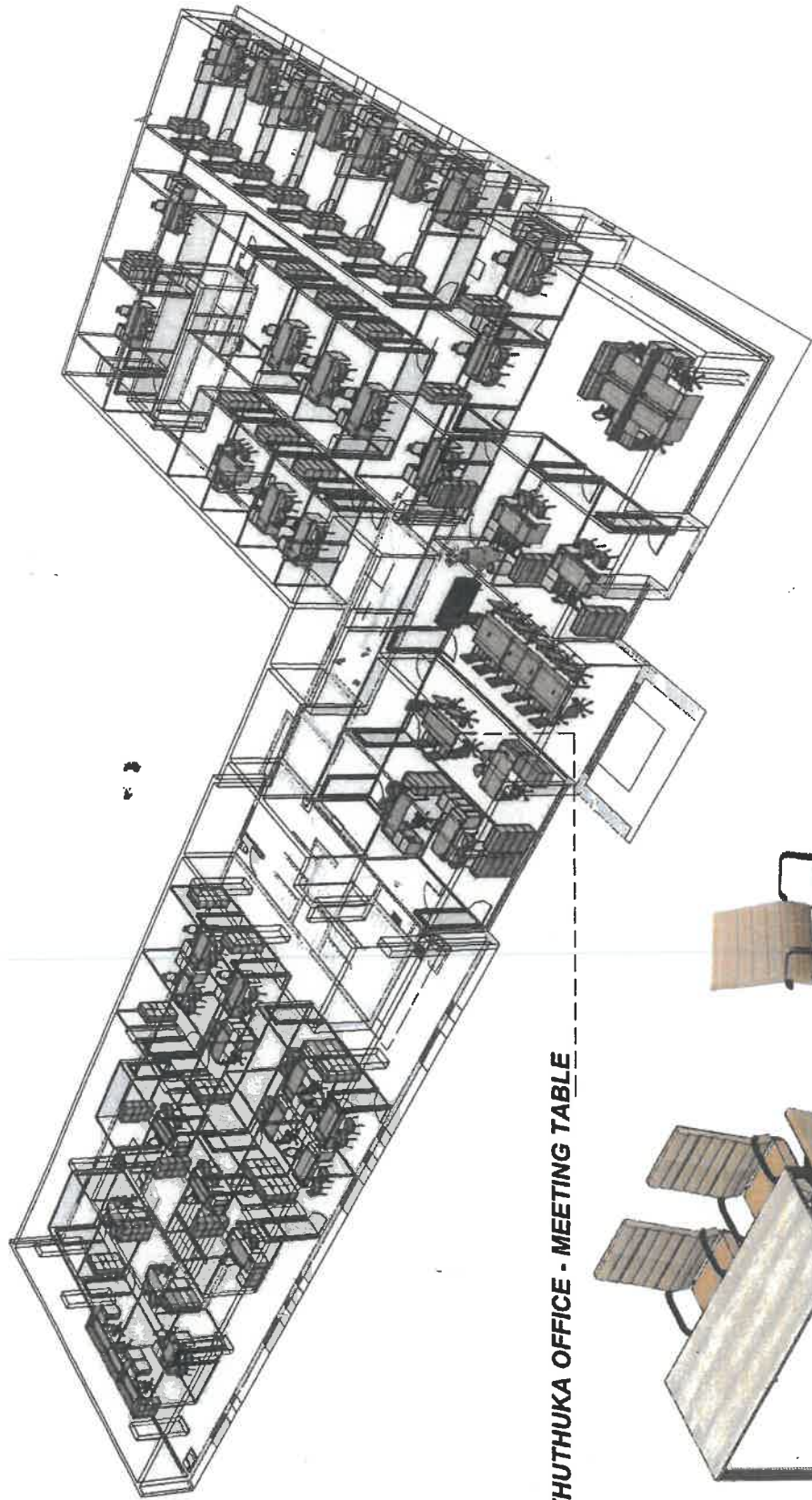

**THUTHUKA OFFICE - MEETING TABLE**

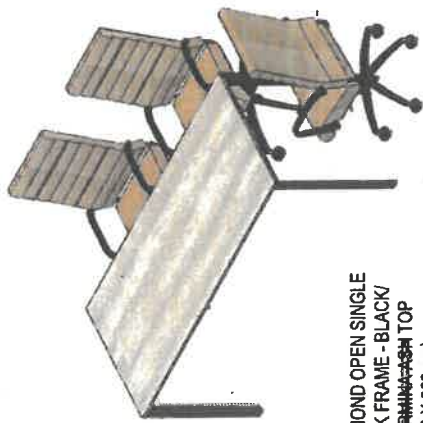

**DIAMOND OPEN SINGLE  
DESK FRAME - BLACK/  
FRAMING CHAIR TOP  
(1800 X 800mm)**



**CLASSICAL MB CHAIRS  
TAN BONDED LEATHER**

**SECOND FLOOR PERSPECTIVE**

**EXECUTIVE OFFICES X2**

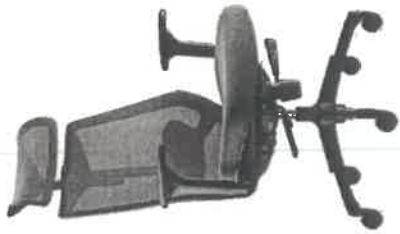
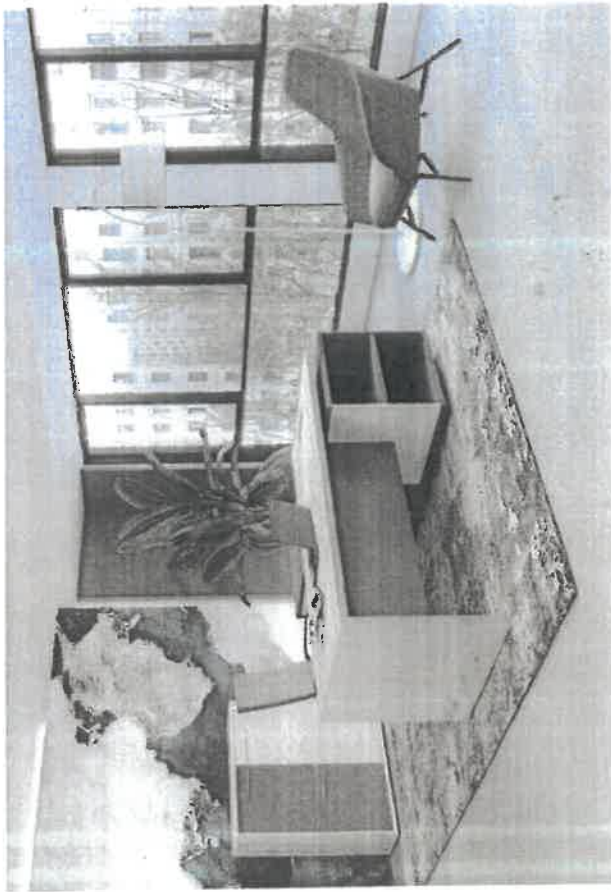

ARCO TASK CHAIR WITH HEADREST



C-VISITORS CHAIR - GREY

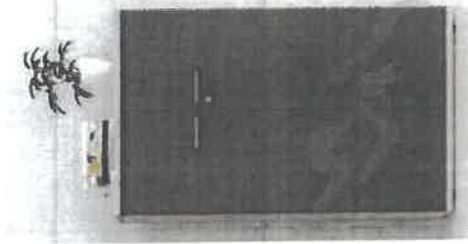

ECOCENTRIC HID STORAGE CABINET



ANTHRACITE

TRAFFIC LIGHT WASH

LEGACY EXECUTIVE DESK WITH DROPPED L-EXTENSION SIDE STORAGE UNIT (1900 L X 2000 W X 739mm H) - ANTHRACITE/TRAFFIC LIGHT WASH, PAIRED WITH ANTHRACITE

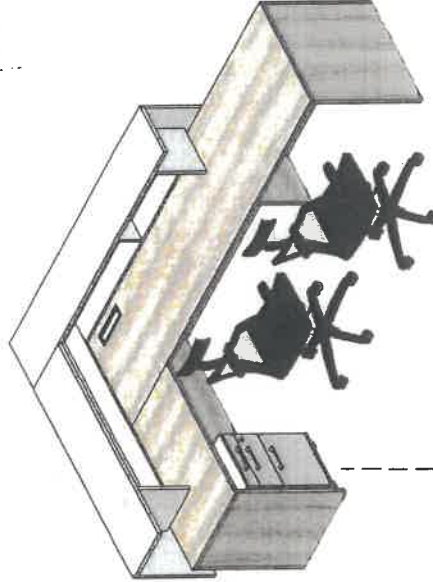
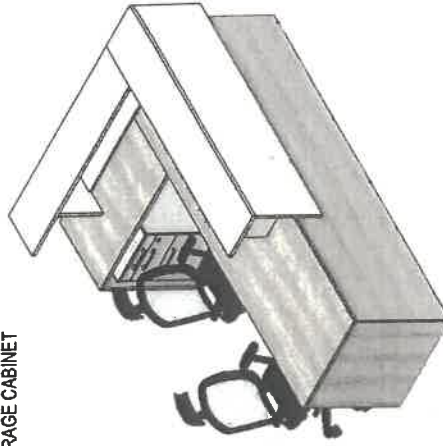

FRANKLIN RECEPTION COUNTER (2700 L X 1800 X W X 1080mm H) - TRAFFIC LIGHT WASH WITH WHITE TOP MODULE/ GLOBAL MOBILE PEDESTAL WHITE WITH SILVER HANDLES

**RECEPTION & WAITING AREA**

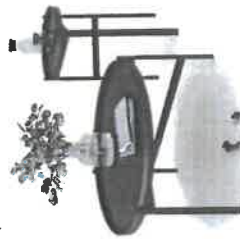

TRAY COFFEE TABLE (800mm DIA) BLACK

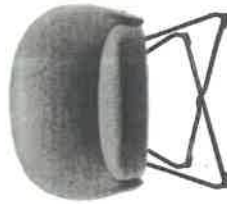

HERA OCCASIONAL CHAIR EMERALD GREEN

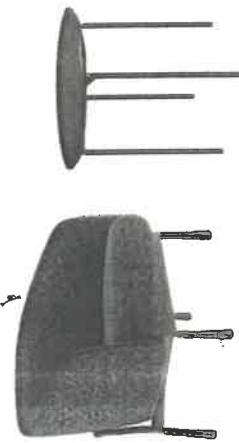

COSMOS SINGLE SEATER - BLUE FABRIC



GLOBAL MOBILE PEDESTAL WHITE, SILVER HANDLES

SELENA SIDE TABLE BLACK

**HEAD OF FM**

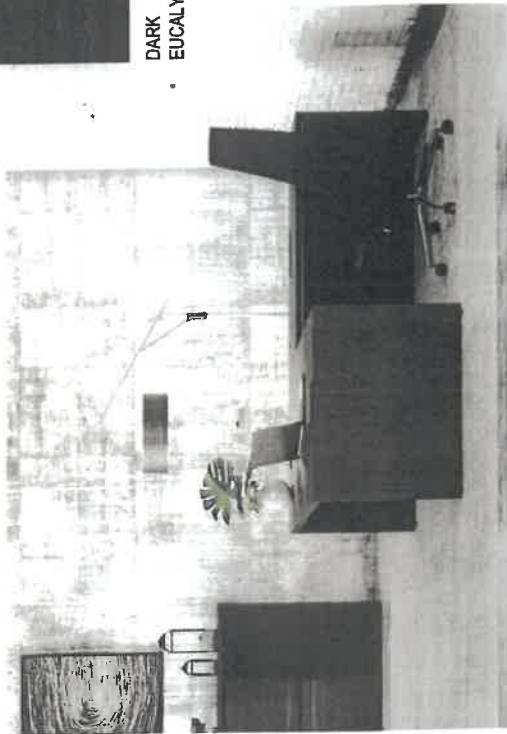

ALLURE EXECUTIVE DESK INCLUDING OPEN L - EXTENSION WITH DRAWERS (2200 L X 2150 W X 738mm H) - DARK EUCALYPTUS PAIRED WITH BLACK

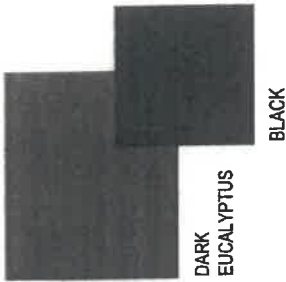

DARK EUCALYPTUS

BLACK

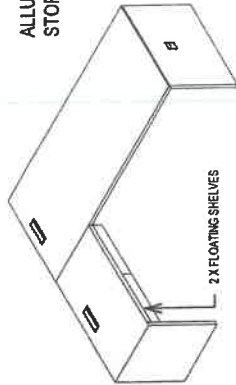

2 X FLOATING SHELVES



ALLURE EXEC HINGE DOOR STORAGE UNIT



ACCORD HIB CHAIR

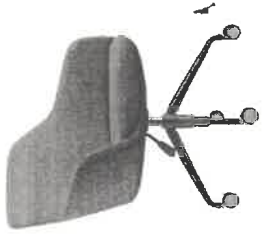

CHICO SWIVEL TUB CHAIR

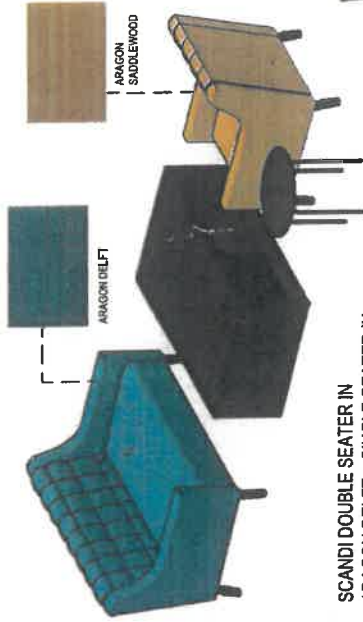

SCANDI DOUBLE SEATER IN ARAGON DELFT + SINGLE SEATER IN ARAGON SADDLEWOOD/ ECOCENTRIC COFFEE TABLE + SELENA SIDE TABLE



CLASSICAL HIB CHAIR - TAN

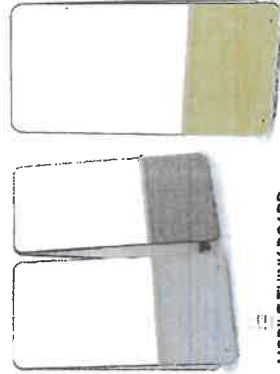

MOBILE THINK BOARD

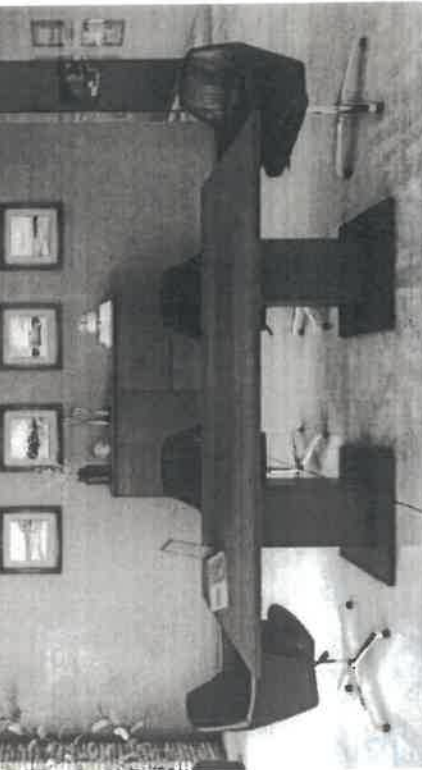

ALLURE EXECUTIVE BOARDROOM TABLE (2400 X 1200mm) - DARK EUCALYPTUS TOP WITH BLACK CENTER INLAY + BLACK RETICULATED PEDESTAL BASES



ECOCENTRIC COFFEE TABLE



SELENA SIDE TABLE



ECOCENTRIC SERVER UNIT

EXECUTIVE WING - WOOD FINISHES



DARK EUCALYPTUS

FM OFFICE, FM BOARDROOM,  
EXEC BOARDROOM

BLACK

EXECUTIVE OFFICES 01 + 02 - WOOD FINISHES

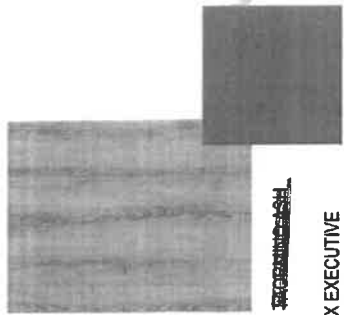

2 X EXECUTIVE  
OFFICES

ANTHRACITE

OFFICES + OPEN PLAN - WOOD FINISHES

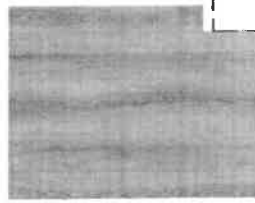

OFFICES + OPEN  
PLAN

WHITE

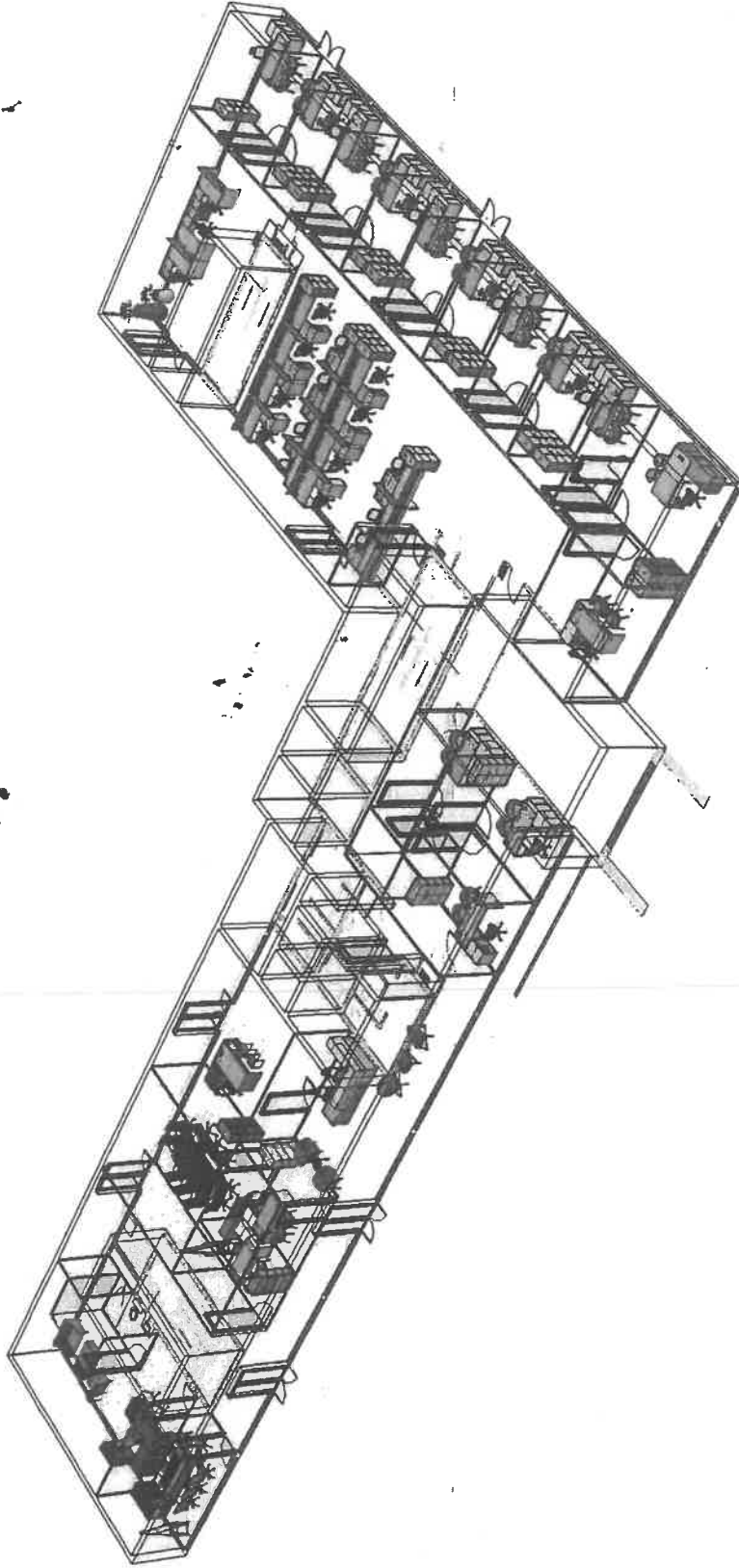

THIRD FLOOR PERSPECTIVE

# EXECUTIVE BOARDROOM

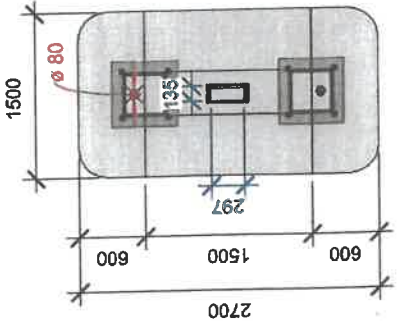

## DOT EVO

DEIN • [BLK/WH]

- 1 x South African 16 Amp 3 Pin / 1 x South African compact 16 Amp 3 Pin / 1 x USB A Quick Charger technology (QC) max 10W / 1 x USB C Power Delivery technology (PD) max 30W / Available in Black [BLK] or White [WH]

\*Fit standard 80mm grommet hole

## PIVOT HORIZONTAL

- 1 x illuminated over lead switch / 2 x Standard 3 pin South African 16 Amp socket / 2 x Compact 3 pin South African 16 Amp socket / 1 x HDMI / 2 x DATA blank / Available in Graphite [BLK] & Titanium [SIL] finish

\*Cut out: 333 (L) x 135 (M) mm



## BOARDROOM TECHNICAL



CLASSIC BLOCK HIB CHAIR

## DOT EVO POWER UNIT

## PIVOT HORIZONTAL POWER UNIT

BLACK INLAY

CLASSIC BLOCK HIB CHAIR

## GLOBAL EVO 4X1 LOW STORAGE UNIT

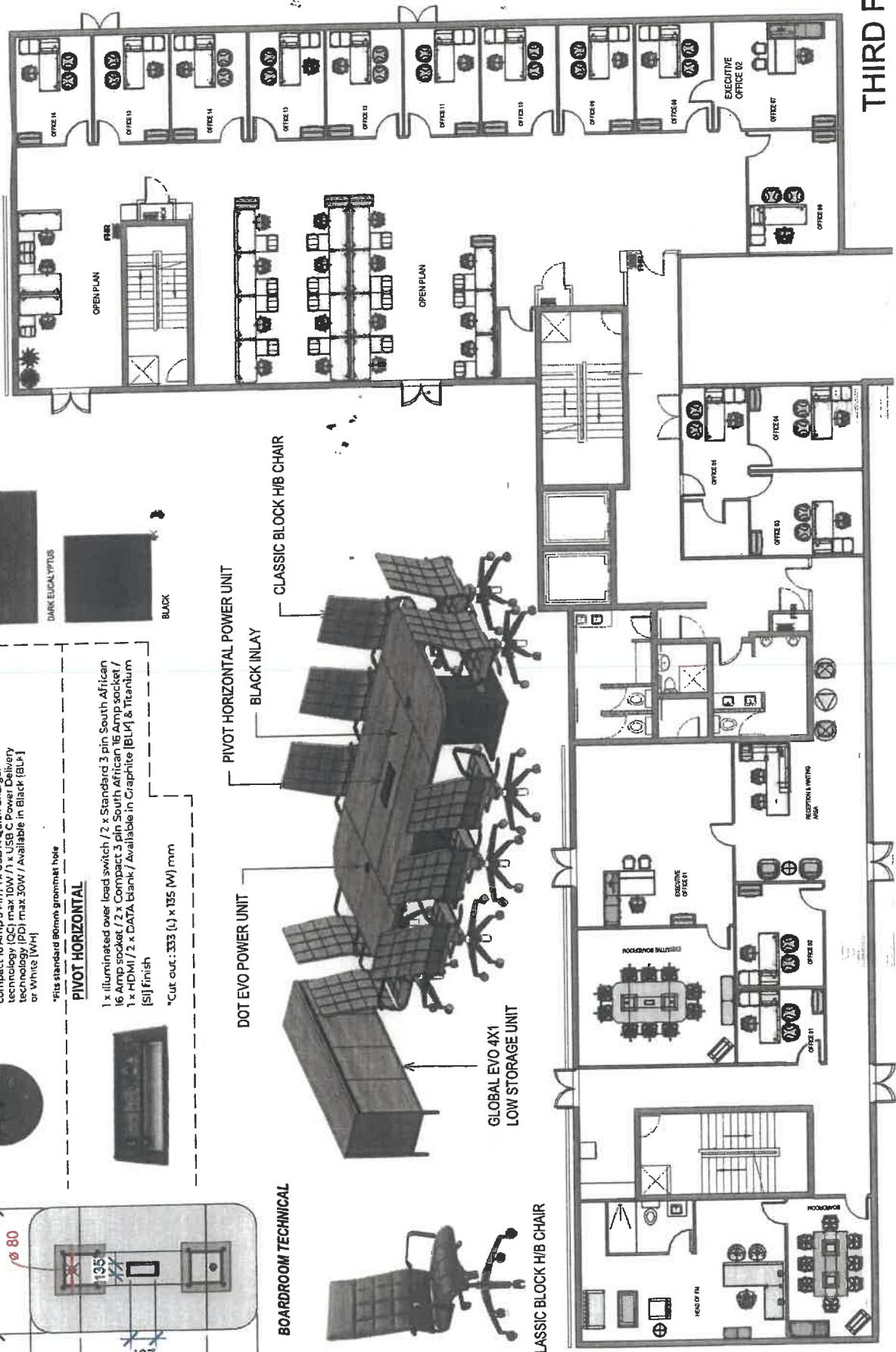

# THIRD FLOOR PLAN

**OFFICES X 15**

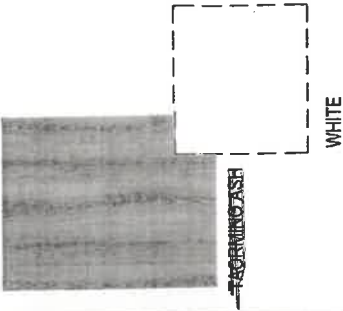

WHITE

TAORMINA ASH

XPRESS ME PANEL DESK (1 X LEG) WITH DROPPED L-EXTENSION SIDE STORAGE UNIT - TAORMINA ASH PAIRED WITH WHITE PANEL DESK (11800 X 750mm) + STORAGE UNIT (1500 L X 550 D X 675mm H)

**OPEN PLAN CLUSTERS**

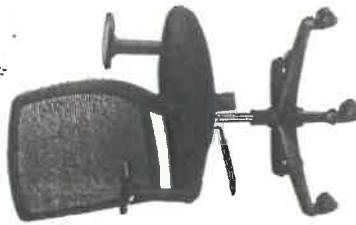

GIRO TASK CHAIR WITH SIMPLE MECHANISM



LINK TASK CHAIR WITH HEADREST

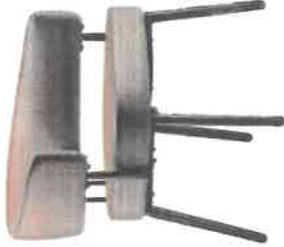

ALCE 4 LEGGED ARMCHAIR - AMBER UPHOLSTERY

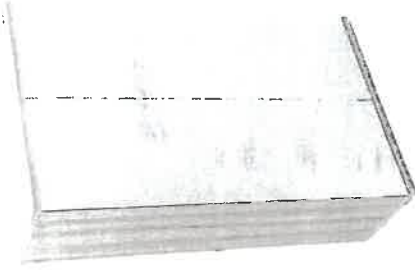

ECOCENTRIC HINGE DOOR STORAGE CABINET - TAORMINA ASH PAIRED WITH WHITE

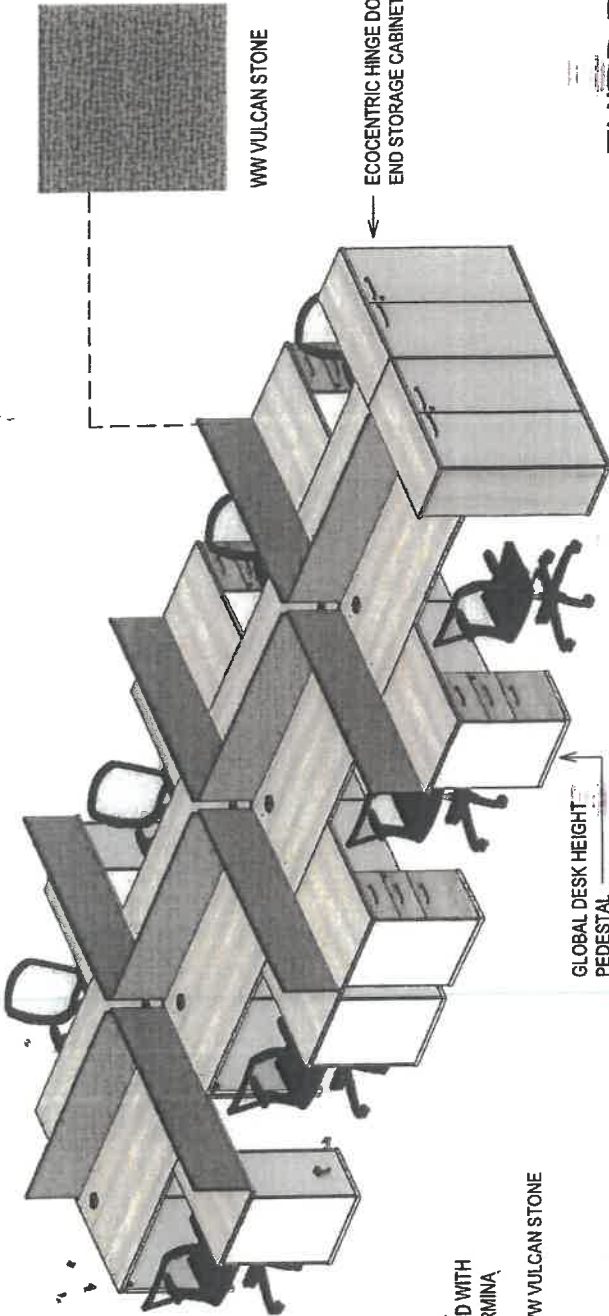

OPEN PLAN CLUSTERS -

XPRESS RECT. DESK (2 X PANEL LEGS) (1600 X 750mm) + DOT COM CABLE OUTLETS/ GLOBAL EXTENSION TOP (800 X 600mm)/ GLOBAL DESK HEIGHT PEDESTAL - TAORMINA ASH PAIRED WITH WHITE/ GLOBAL END STORAGE CABINETS - TAORMINA ASH PAIRED WITH WHITE, SILVER HANDLES/ GLOBAL SIDE STITCH DESK BASED SCREENS - WW VULCAN STONE

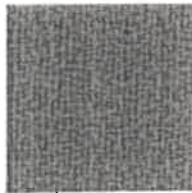

WW VULCAN STONE

ECOCENTRIC HINGE DOOR END STORAGE CABINETS

GLOBAL DESK HEIGHT PEDESTAL

# DPWI FURNITURE BROCHURE 2023

## CHAIRS



**High Back in PU**



**Sleigh base in PU (same frame as sleigh base visitor in fabric)**

# DPWI FURNITURE BROCHURE 2023



**Operator High Back in Fabric**



**Operator High Back in Fabric (Side Angle)**

## DPWI FURNITURE BROCHURE 2023



---

### ADMINISTRATIVE WORKSTATION CONSISTING OF THE FOLLOWING COMPONENTS:

- 1 x Standard core top in Cherry Laminate
- 1 x Rectangular top in Cherry Laminate
- 1 x Rectangular top in Cherry Laminate
- 1 x 2-Drawer filing cabinet with pencil drawer.
- 1 x Modesty panel.
- 1 x Column leg reticulated.
- 1 x Cantilever leg non-reticulated

# DPWI FURNITURE BROCHURE 2023



## EXECUTIVE WORKSTATION CONSISTING OF THE FOLLOWING COMPONENTS:

- 1 x Executive core top in Cherry Veneer
- 2 x Rectangular tops in Cherry Veneer
- 1 x Wing link top in Cherry Veneer.
- 1 x Executive bubble top in Cherry Veneer
- 1 x Desk high pedestal with pencil tray, 2 standard drawers and a deep drawer.
- 1 x 2-Drawer filing cabinet with pencil drawer.
- 1 x Modesty panel.
- 1 x Conference table leg.
- 1 x Column leg reticulated.
- 1 x Cantilever leg non-reticulated.

# DPWI FURNITURE BROCHURE 2023



---

## EXECUTIVE CONFERENCE TABLE CONSISTING OF THE FOLLOWING COMPONENTS:

- 2 x Rectangular tops in Cherry Veneer
- 2 x "D" Boardroom tops in Cherry Veneer
- 6 x Column legs non-reticulated.

# DPWI FURNITURE BROCHURE 2023



# DPWI FURNITURE BROCHURE 2023



*5-drawer cabinet veneer*



*Credenza*