

COPPER CRIMPET

(FOR CRIMPED JOINTS 10mm DIA TO 10mm DIA
BLACK COPPER ROD)

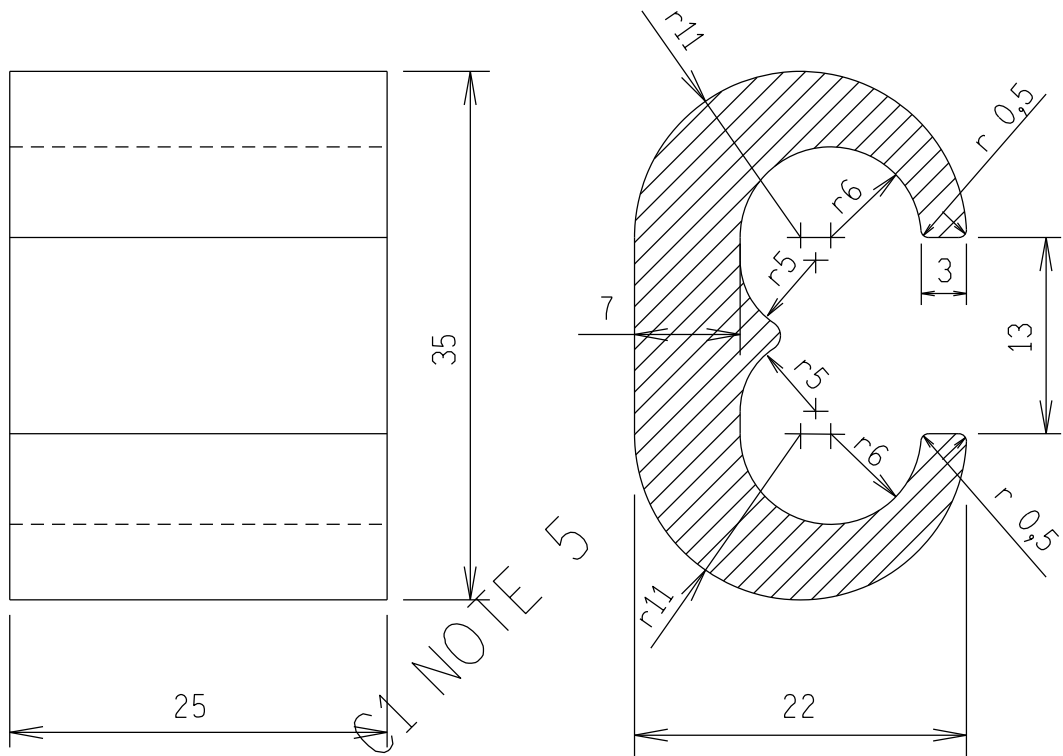

MATERIAL: ELECTROLYTIC COPPER (ANNEALED)

MASS: 8 kg/100 UNITS.

NOTE: ALL DIMENSIONS $\pm 0,5\text{mm}$

SCALE 2:1

THE C.A.D. REFERENCE NUMBER IS:
[100,164]00393EC04.R03

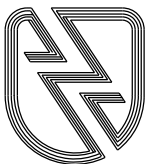

ESKOM

DRAWN
GETEKENCHKD
NAGES

AUTH
MAS

WN

REV

3

DATE
DATUM

15.7.
1996

EARTHING STANDARDS

0.54/393

SHEET C4

DRG.TEK
REGISTR

393C04.DGN