

- LEGEND**
- < OUTSIDE CAMERA
 - OC < INSIDE CAMERA
 - FL OUTSIDE BEAMS
 - AG ACCESS CONTROL POINT- ALLOW FOR DATA (CAT 6A) AND POWER POINT (OLD SA 3)

- CIRCUITING**
- A A- CIRCUIT NUMBER
 - B B- DB NAME

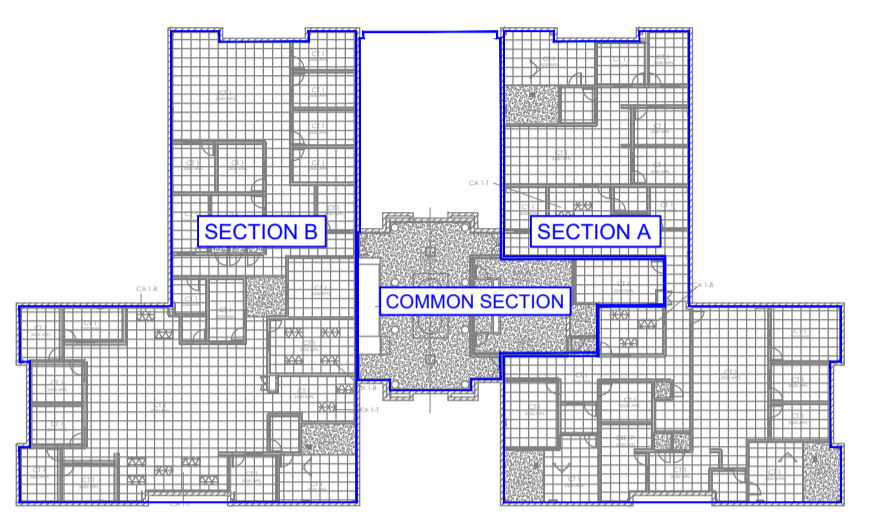

01	ISSUED FOR CONSTRUCTION	05.05.2026
00	ISSUED FOR CONSTRUCTION	02.02.2026
REV	REVISION DETAILS	DATE

CLIENT



MHSC
Mine Health and Safety Council

Haraway House
10 & 12th Floor Pearce Str.
Berea
East London, 5201

Tel: 043 711 1600
Fax: 041 403 0401

P.O Box
East London
5201

APPROVAL

DESIGN ENGINEER: M.BUTHELEZI
2021300956

SIGNATURE: 

DATE SIGNED: 06.05.2026

DESIGN REVIEWER: P.MLANGENI

SIGNATURE:

DATE SIGNED: 06.05.2026

CONSULTING ENGINEERS



Gauteng Office: 1 Mellis road, Mellis court office park, Rivonia Sandton 2128
Tel: 010 500 1486
www.henryfagan.com

Western Cape Office: Suite A2, Ground Floor Building 2, Nordic Park 2, 17 Boundary Road, Century City, 7441
Tel: 021 423 0873
www.henryfagan.com

PROJECT

MHSC OFFICE
BUILDING RENOVATION

DRAWING TITLE

UPPER GROUND
SECURITY LAYOUT

ISSUED FOR CONSTRUCTION

DRAWN BY		DRAWING CHECKED BY	
B.T		P.M	
SCALE	DATE	SHEET SIZE	
1:100	02.02.2026	A1	

PROJECT - ORIG - ZONE - LEVEL - TYPE - DISC - CLASS - NUMBER - REVISION

25002 - HF - ZZ - L1 - DR-EE- DD- 1004 - 01

© COPYRIGHT RESERVED
THE CONTENT OF THIS DOCUMENT IS CONFIDENTIAL AND MAY NOT BE REPRODUCED WITHOUT THE AUTHORISATION OF HENRY FAGAN CONSULTING ENGINEERS.