

CIRCUITING

A - CIRCUIT NUMBER
B - DB NAME

POWER SKIRTING TO BE AT FLOOR HEIGHT UNLESS OTHERWISE SPECIFIED ON PLAN.
COLOUR: WHITE

SURFACE MOUNTED TRUNKING
COLOUR: BLACK

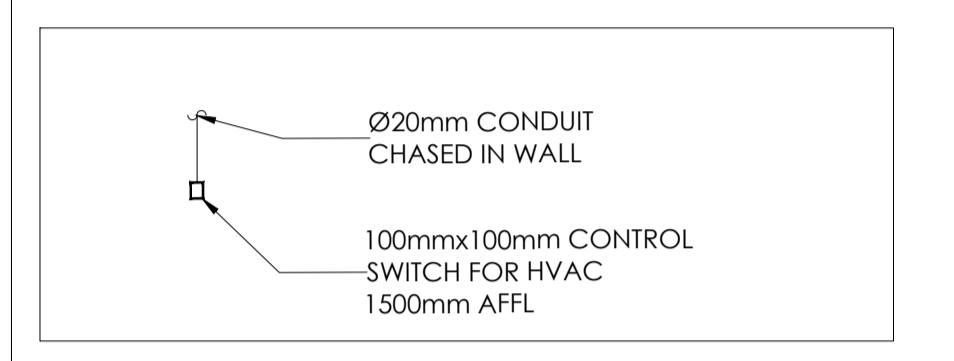
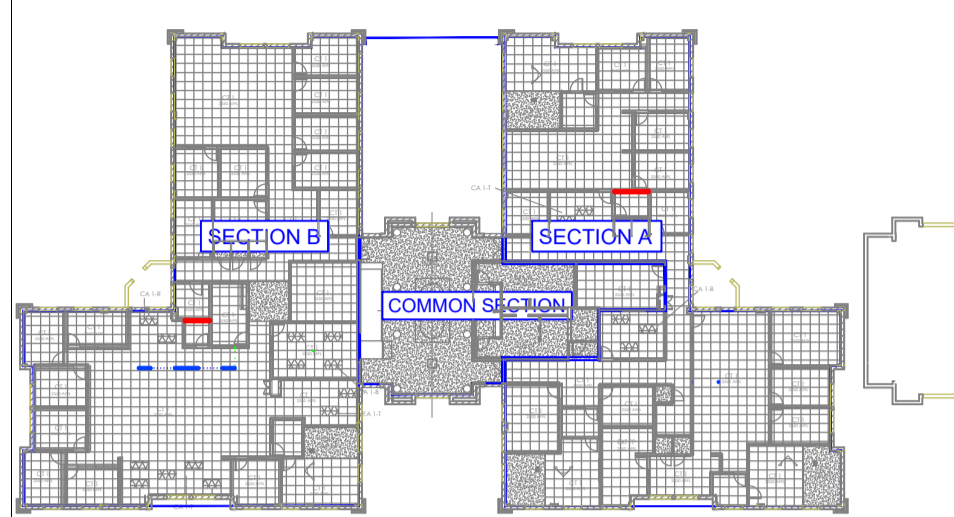

02	ISSUED FOR CONSTRUCTION	06.05.2026
01	CONTROL SWITCH POSITION FOR HVAC INDICATED	03.03.2026
00	ISSUED FOR CONSTRUCTION	02.02.2026

CLIENT

MHSC
Mine Health and Safety Council

Harroway House
10 & 12th Floor Pearce Str,
Barnes
East London, E20 1

Tel: 043 711 1600
Fax: 041 403 0401

P.O Box
East London
5201

APPROVAL

DESIGN ENGINEER: M. BUTHELEZI
2021300956

SIGNATURE: _____

DATE SIGNED: 06.05.2026

DESIGN REVIEWER: P. LANGENI

SIGNATURE: _____

DATE SIGNED: 06.05.2026

CONSULTING ENGINEERS

GAUTENG OFFICE: 1 Mellis road, Mellis court office park, Rivonia
Sandton 2128
Tel: 011 501 1486
www.henryfagan.com

WESTERN CAPE OFFICE: Suite A2, Ground Floor Building 2, Nordic Park 2,
17 Boundary Road, Century City, 7441
Tel: 021 423 0873
www.henryfagan.com

PROJECT

MHSC OFFICE BUILDING RENOVATION

DRAWING TITLE

UPPER GROUND POWER LAYOUT

ISSUED FOR CONSTRUCTION

DRAWN BY		DRAWING CHECKED BY	
B.T		P.M	
SCALE	DATE	SHEET SIZE	
1:100	02.02.2026	A1	

PROJECT - ORIG - ZONE - LEVEL - TYPE - DISC - CLASS - NUMBER - REVISION

25002 - HF - ZZ - L1 - DR - EE - DD - 1000 - 02

© COPYRIGHT RESERVED
THE CONTENT OF THIS DOCUMENT IS CONFIDENTIAL AND MAY NOT BE REPRODUCED WITHOUT THE AUTHORISATION OF HENRY FAGAN CONSULTING ENGINEERS.

170 PVD SCHEDULE

Legend	Type Mark	Description	Standard Installation Height	QTY	Image
AC	AC	ACCESS CONTROL POINT-ALLOW FOR DATA (CAT 6A) AND POWER POINT (OLD SA 3 PIN).	<varies>	9	
EL B1	BRICK WALL	SINGLE NORMAL POWER POINT TO BE INSTALLED IN BRICK WALL TO BE CHASED. FITTING: SINGLE SOCKET WITH 4X4 COVERPLATE. COLOUR: BLACK MODULES ON GRAPHITE COVER. MODULE: BLACK MODULE -1 X 16A OLD SA 3 PIN - SWITCHED	300mm AFFL	11	
EL B2	BRICK WALL	DOUBLE NORMAL POWER POINT INSTALLED IN BRICK WALL TO BE CHASED. FITTING: DOUBLE SOCKET WITH 4X4 COVERPLATE. COLOUR: BLACK MODULES ON GRAPHITE COVER. MODULE: BLACK MODULE -2 X 16A OLD SA 3 PIN - SWITCHED	300mm AFFL	11	
EL B3	BRICK WALL	SINGLE DEDICATED POWER POINT INSTALLED IN BRICK WALL TO BE CHASED. FITTING: SINGLE DEDICATED SOCKET WITH 4X4 COVERPLATE. COLOUR: RED MODULES ON GRAPHITE COVER. MODULE: 1 X 16A OLD SA 3 PIN - SWITCHED	300mm AFFL	1	
EL B4	BRICK WALL	DOUBLE DEDICATED POWER POINT INSTALLED IN BRICK WALL TO BE CHASED. FITTING: DOUBLE DEDICATED SOCKET WITH 4X4 COVERPLATE. COLOUR: RED MODULES ON GRAPHITE COVER. MODULE: 2 X 16A OLD SA 3 PIN - SWITCHED	300mm AFFL	6	
EL C1	CEILING	SINGLE 16A POWER SOCKET TO BE INSTALLED IN CEILING VOID. STANDARD WHITE FITTING TO BE INSTALLED. MODULE: 1X OLD SA 3 PIN NOT SWITCHED	IN CEILING VOID	3	
EL C2	CEILING	DOUBLE 16A POWER SOCKET TO BE INSTALLED IN CEILING VOID. STANDARD WHITE FITTING TO BE INSTALLED. MODULE: 2X OLD SA 3 PIN NOT SWITCHED	IN CEILING VOID	4	

Legend	Type Mark	Description	Standard Installation Height	QTY	Image
EL CC1		IN DESK CORPORATE CONNECTOR. MODULES: 1X OLD SA 3 PIN, 1X NEW SA 3 PIN, 1X DEDICATED RED OLD SA 3 PIN, 1X USB A, 1X USB C, 1X HDMI, 1X DATA PASS THROUGH. COLOUR: GRAPHITE. BODY AND MODULES MOUNTING: FLUSH IN DESK SURFACE - CUTOUTS TO BE MADE PRIOR TO INSTALLATION. TECHNICAL SPECIFICATIONS: BODY MATERIAL: ANODISED ALUMINIUM. MAX CURRENT: 16amp. OPERATING VOLTAGE: 220-240V AC 50/60HZ. USB CONNECTOR STRENGTH: 30W SHARED. CORD LEGTH: 4m STANDARD	TOP - FLUSH	4	
EL CC2		IN DESK CORPORATE CONNECTOR. MODULES: 1X OLD SA 3 PIN, 1X NEW SA 3 PIN, 1X DEDICATED RED OLD SA 3 PIN, 1X USB A, 1X USB C, 1X DATA PASS THROUGH. COLOUR: GRAPHITE. BODY AND MODULES MOUNTING: FLUSH IN DESK SURFACE - CUTOUTS TO BE MADE PRIOR TO INSTALLATION. TECHNICAL SPECIFICATIONS: BODY MATERIAL: ANODISED ALUMINIUM. MAX CURRENT: 16amp. OPERATING VOLTAGE: 220-240V AC 50/60HZ. USB CONNECTOR STRENGTH: 30W SHARED. CORD LEGTH: 4m STANDARD	TOP - FLUSH	1	
EL CC3		IN DESK CORPORATE CONNECTOR. MODULES: 1X OLD SA 3 PIN, 1X NEW SA 3 PIN, 1X DEDICATED RED OLD SA 3 PIN, 1X USB A, 1X USB C, 1X DATA PASS THROUGH. COLOUR: GRAPHITE. BODY AND MODULES MOUNTING: FLUSH IN DESK SURFACE - CUTOUTS TO BE MADE PRIOR TO INSTALLATION. TECHNICAL SPECIFICATIONS: BODY MATERIAL: ANODISED ALUMINIUM. MAX CURRENT: 16amp. OPERATING VOLTAGE: 220-240V AC 50/60HZ. USB CONNECTOR STRENGTH: 30W SHARED. CORD LEGTH: 4m STANDARD	TOP - FLUSH	4	

Legend	Type Mark	Description	Standard Installation Height	QTY	Image
EL CD1		UNDER DESK DAISY CHAIN POWER UNIT, INCLUDE MODULES: 1X DEDICATED 3 PIN, 1X NORMAL 3 PIN, 1X NEW SA 3 PIN, DATA TO BE RETICULATED TO DESK THROUGH UNDER DESK CABLE TRAYS.	<varies>	20	
EL CW		WIFI POINT TO BE INSTALLED IN CEILING	<varies>	7	
EL D1		SINGLE NORMAL POWER POINT TO BE INSTALLED IN DRYWALL. FITTING: SINGLE SOCKET WITH 4X4 COVERPLATE. COLOUR: BLACK MODULES ON GRAPHITE COVER. MODULE: BLACK MODULE -1 X 16A OLD SA 3 PIN - SWITCHED. SINGLE NORMAL POWER POINT TO BE INSTALLED IN DRYWALL. FITTING: SINGLE SOCKET WITH 4X4 COVERPLATE. COLOUR: BLACK MODULES ON GRAPHITE COVER. MODULE: BLACK MODULE -1 X 16A OLD SA 3 PIN - SWITCHED	<varies>	57	
EL D2		DOUBLE NORMAL POWER POINT TO BE INSTALLED IN DRYWALL. FITTING: DOUBLE SOCKET WITH 4X4 COVERPLATE. COLOUR: BLACK MODULES ON GRAPHITE COVER. MODULE: BLACK MODULE -2 X 16A OLD SA 3 PIN - SWITCHED	300mm AFFL	9	
EL D4		DOUBLE DEDICATED POWER POINT TO BE INSTALLED IN DRYWALL. FITTING: DOUBLE DEDICATED SOCKET WITH 4X4 COVERPLATE. COLOUR: RED MODULES ON GRAPHITE COVER. MODULE: 2 X 16A OLD SA 3 PIN - SWITCHED	300mm AFFL	44	
EL DP		DATA POINT. MINIMUM REQUIREMENT FOR CABLEING: CAT-6A	300mm AFFL	61	
EL IS		60AMP ISOLATOR SWITCH - FITTING: ONESHO MATRIX 60A ISOLATOR SWITCH MODULE WITH 4X4 COVERPLATE. COLOUR: BLACK MODULES ON GRAPHITE COVER.	AS PER PLAN	2	

Legend	Type Mark	Description	Standard Installation Height	QTY	Image
EL NT		NO TOUCH ACCESS CONTROL. ALLOW FOR DATA AND NORMAL POINT	<varies>	7	
EL PC		POP UP BOX TO BE INSTALLED IN FLOOR. 146X146mm SOFT POP-UP STYLE FLOOR BOX. MATERIAL: ALUMINIUM ALLOY. COLOUR: SILVER. MOUNTING: TO BE CHASED INTO SLAB (SUBJECT TO APPROVAL BY STRUCTURAL ENGINEER). MODULES: TO INCLUDE 1X OLD RSA 3 PIN, 1X DEDICATED RED OLD RSA 3 PIN, 2X DATA, 1X COMBINATION TRIPLE SUMLINE NEW RSA 3 PIN.	FLUSH WITH FLOOR FINISH	1	
EL PY		PYRAMID SURFACE MOUNTED FLOOR BOX TO BE INSTALLED. SPECIFICATION & MODULES TO BE CONFIRMED	FLUSH WITH FLOOR FINISH	1	
EL S4		DOUBLE 16A POWER POINT INSTALLED IN POWER SKIRTING MODULE: 2X DEDICATED RED OLD SA 3 PIN	SKIRTING	4	
EL TV		TV POINT - ALLOW FOR DATA (CAT 6A) AND POWER POINT (OLD SA 3 PIN).	1500mm AFFL	12	
EL WI		WIFI POINT TO BE INSTALLED IN CEILING VOID	IN CEILING VOID	1	
SB		EXTERIOR SECURITY BEAMS. SPECIFICATION AS PER ECT AND ELECTRICAL ENGINEER. ALLOW FOR POWER & DATA FOR BEAM POINT. MOUNTING: FUTURE AND HEIGHT AS PER MANUFACTURER.	<varies>	2	
SP		CEILING/SOFT FIXED PUBLIC ADDRESS SPEAKER. SPECIFICATION BY SPECIALIST. ALLOW FOR POWER AND DATA.	<varies>	30	
SW D1		SINGLE LEVER LIGHT SWITCH. DIMMABLE. FITTING: SINGLE LEVER SWITCH ON 2X4 COVER PLATE. COLOUR: GRAPHITE BLACK. 2 WAY SWITCH. DIMMABLE SWITCHES TO OVERRIDE MOTION SENSORS	1100mm AFFL	3	
SW N1		SINGLE LEVER SWITCH. COLOUR: GRAPHITE BLACK.	1100mm AFFL	8	

