

DIMENSIONS IN mm EXCEPT WHERE OTHERWISE INDICATED

FOR LIMITS ON UNTOLERANCED DIMENSIONS SEE DRG. No. CME 4092/0-000/-

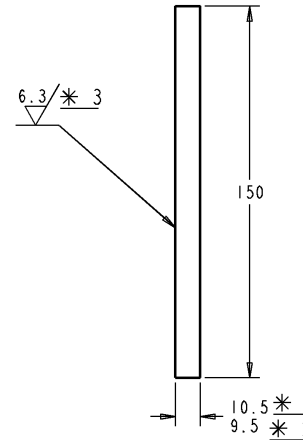

**TRANSNET ENGINEERING GERMISTON
MANUFACTURING PURPOSES**

TRANSNET ENGINEERING GERMISTON VALIDITY

FROM 23 -04 - 2024 / 23 -05 - 2024 TO

ID:

SIGN: *[Signature]*

-/B
REDRAWN AND
ALTERED
15/1/14/4
04/0053

AMENDMENTS



MASS(kg) 2.918

- * 1 MAXIMUM INCLUDING WARPAGE
- * 2 MINIMUM THICKNESS AT ANY POINT
- * 3 IF NECESSARY

COPYRIGHT <small>THIS DRAWING TOGETHER WITH THE COPYRIGHT IS THE PROPERTY OF TRANSNET. THIS DRAWING OR ANY PART THEREOF IS NOT TO BE COPIED OR OTHERWISE REPRODUCED OR USED FOR MANUFACTURE OR ANY OTHER PURPOSE WITHOUT THE WRITTEN PERMISSION FROM THE ASSISTANT GENERAL MANAGER, WAGONS.</small>	ASSEMBLY DRG. No: CME068_12728_558	DRAWN: M.M.B	RAIL AND TERMINAL SERVICES	WAGONS	PROMAT IT. No:
		APPROVED: R.E	PLATE, WEARING		MATERIAL
	SUPERSEDES/REPLACES DRG. No:	ARCHIVE: PROJ1071	SIDE FRAME WINDOW WEARING PLATE		STEEL, SPECIFICATION ROO-LAST TH400
	DATE: 1978-05-11	SCALE: -0.500	DRAWING No: CME68_023017_729_B		
A3	PROJECTION	CLASS OR TYPE: HS BOGIES MK2 , MK 5	PLATE 10x229x150		