

FLOOR LAYOUT
1:25

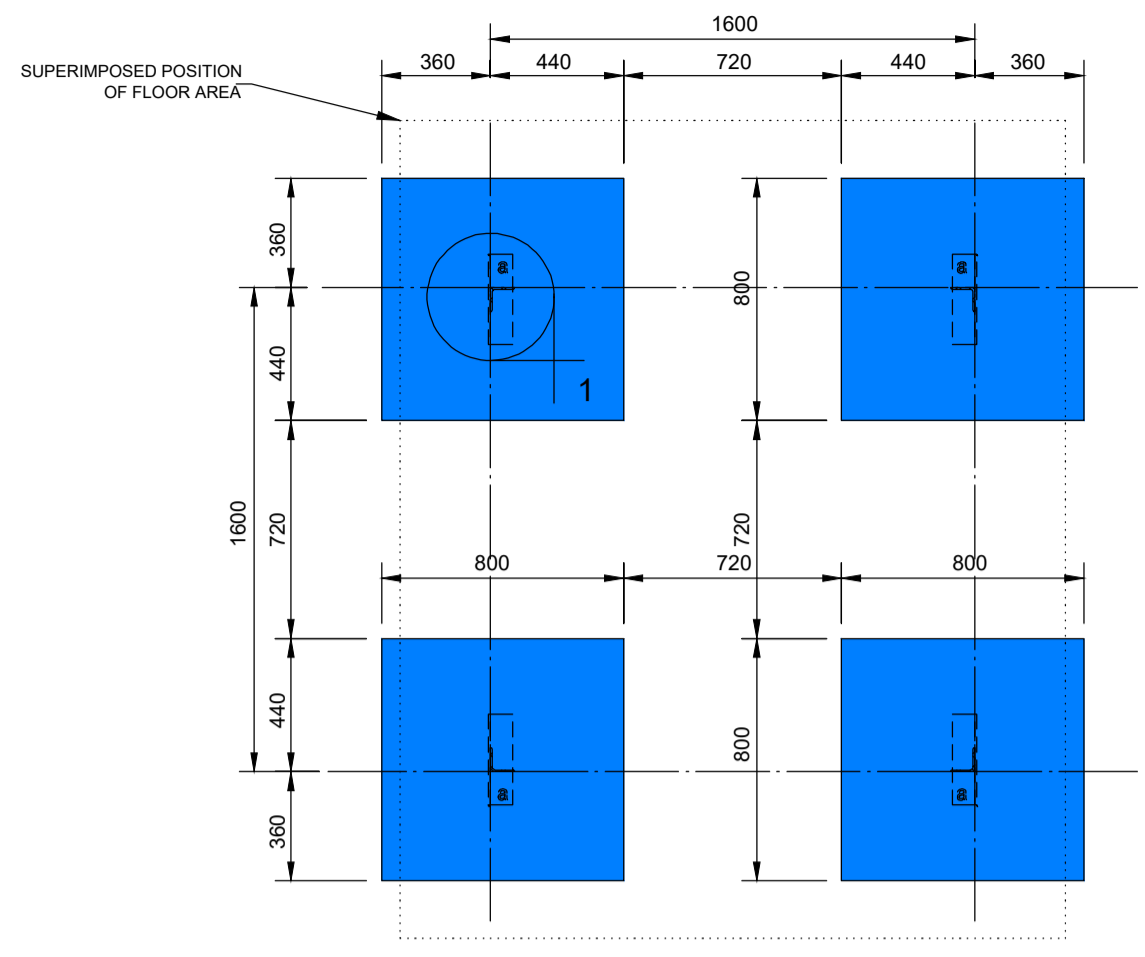

FOUNDATION LAYOUT FOR SINGLE ELEVATED TANK
1:25

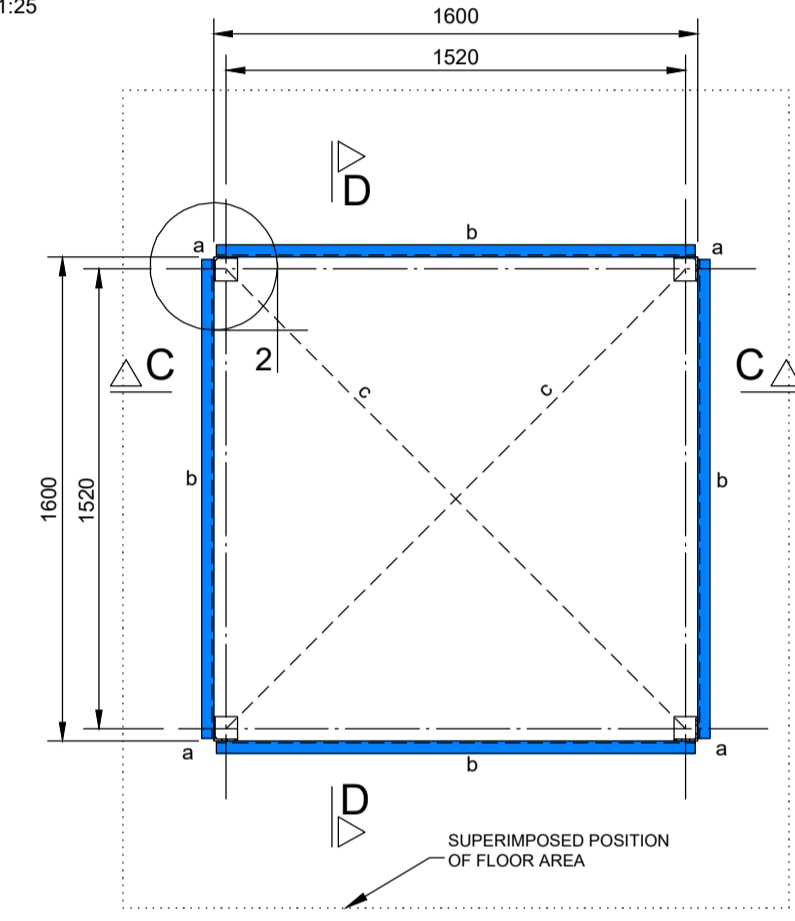

LAYOUT PLAN E-E
1:25

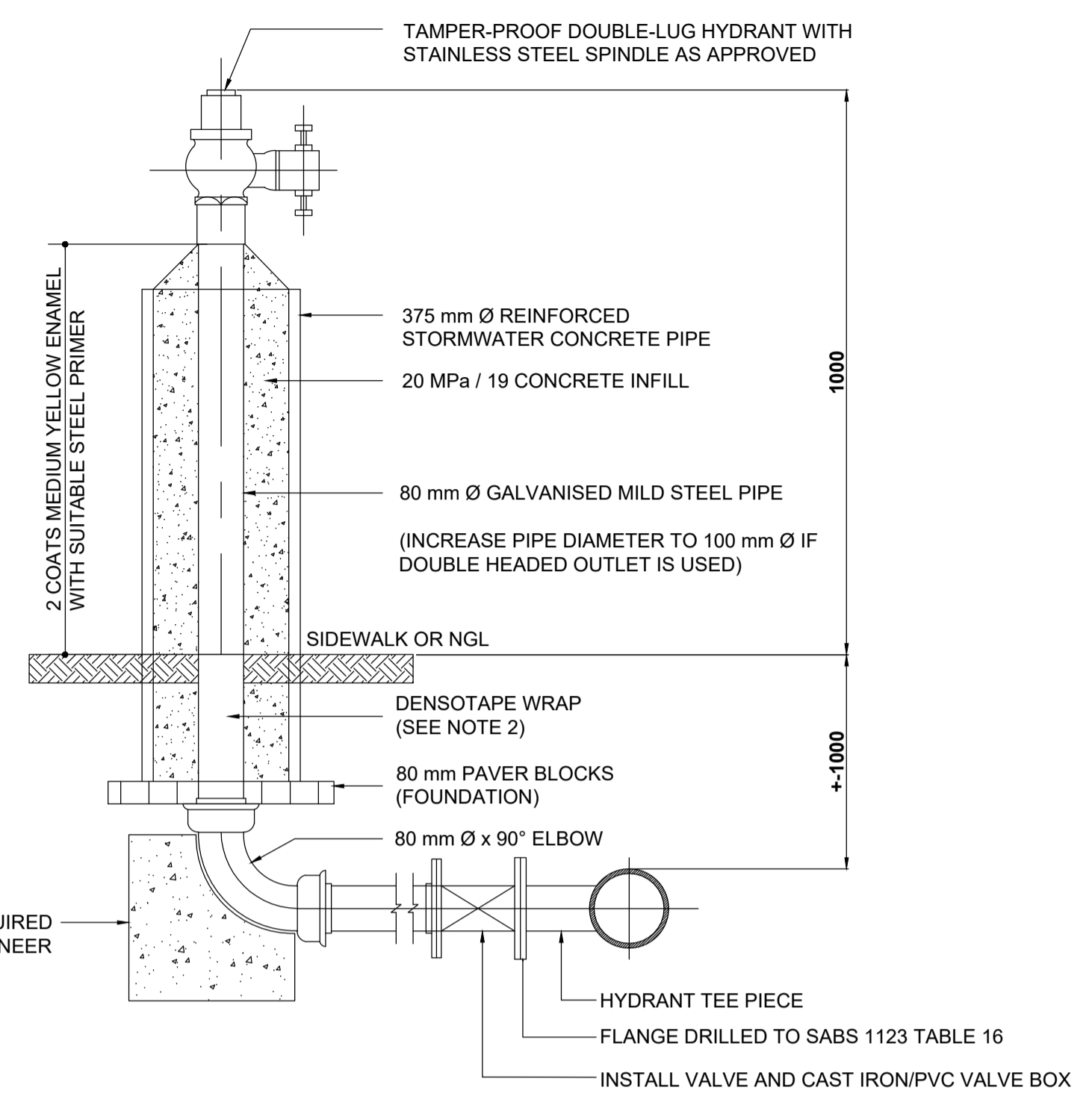

STANDARD FIRE HYDRANT
SCALE 1:10

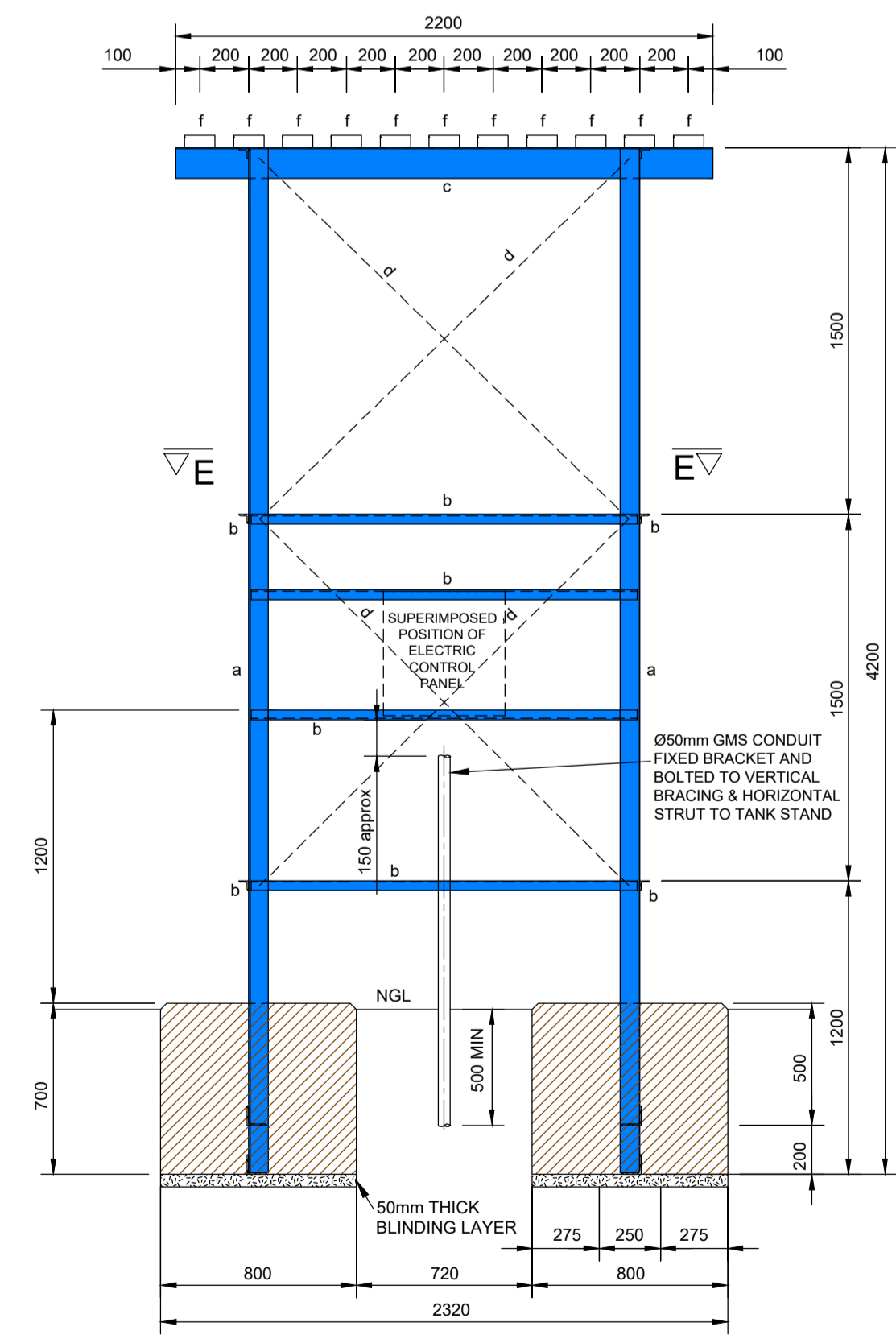

SECTION C-C
1:25

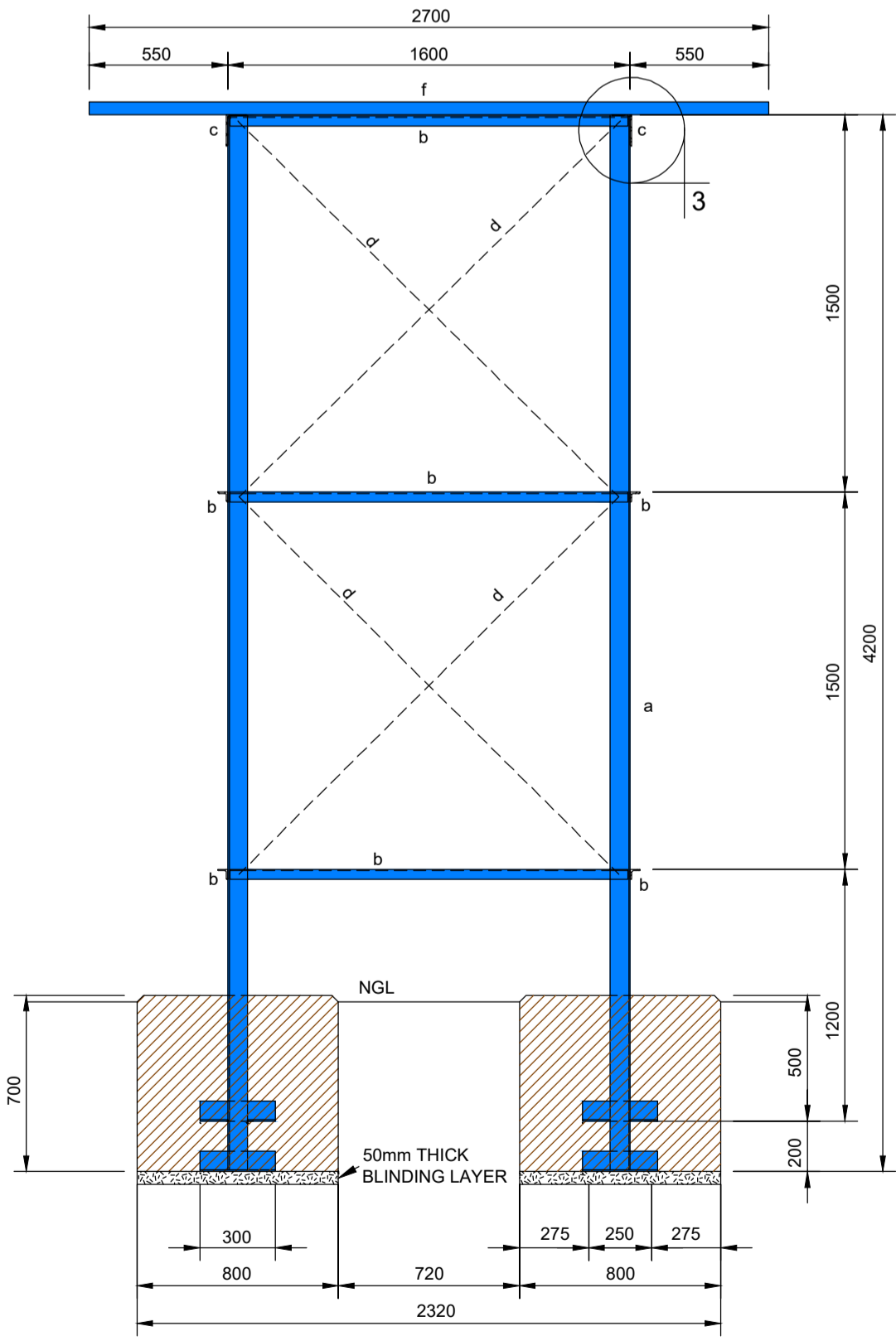

SECTION D-D
1:25

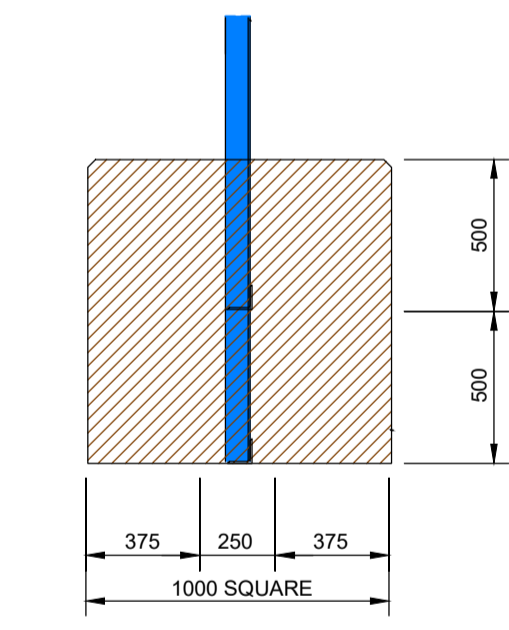

FOOTING DETAIL FOR SANDY CONDITIONS
1:25

NOTE:
TANK STAND COLUMNS TO REST ON TOP OF BLINDING LAYER BEFORE THE FOOTINGS ARE CAST.

NOTES:

LEGEND:

DATE	NO.	REVISION / VARIATIONS	KUT
28.09.23	1	ISSUED FOR TENDER	BS

CLIENT:
LIMPOPO
 PROVINCIAL GOVERNMENT
 REPUBLIC OF SOUTH AFRICA
DEPARTMENT OF EDUCATION
 CNR 113 BILLARD & 24 EXCELSIOR STREET
 POLOKWANE 0700

IMPLEMENTING AGENT:
THE MVULA TRUST
 A leading developmental NGO
 ROP 6 RHODES DRIFT OFFICE PARK
 RHODES DRIFT STREET
 BENDOR, POLOKWANE 0689 Tel No.: (015) 291 2405

PROJECT ENGINEERS:
KUTLO
 CONSULTING ENGINEERS
 2 HEUWELKRUIN THABAZIMBI EXT 1 THABAZIMBI 0380 Tel No.: 014 312 0112 Fax No.: 086 674 3237 E-mail: admin@kutloconsulting.co.za

PROJECT:
LIMPOPO DEPARTMENT OF EDUCATION
WATER, SANITATION AND FENCING PROGRAMME
 TITLE:
LAERSKOOL BYSONDERHEID
NEW ELEVATED WATER TANK

DRAWING No.: **K1000-LB-015**

SCALE: 1:25	DESIGNED: BS
DATE: SEPTEMBER 2023	DRAWN: KN
REV. NO. 1	APPROVED: BS