

Annexure 2 - KNP Workshop Infrastructure- equipment and tools

1. Skukuza workshop

➤ Floor plan

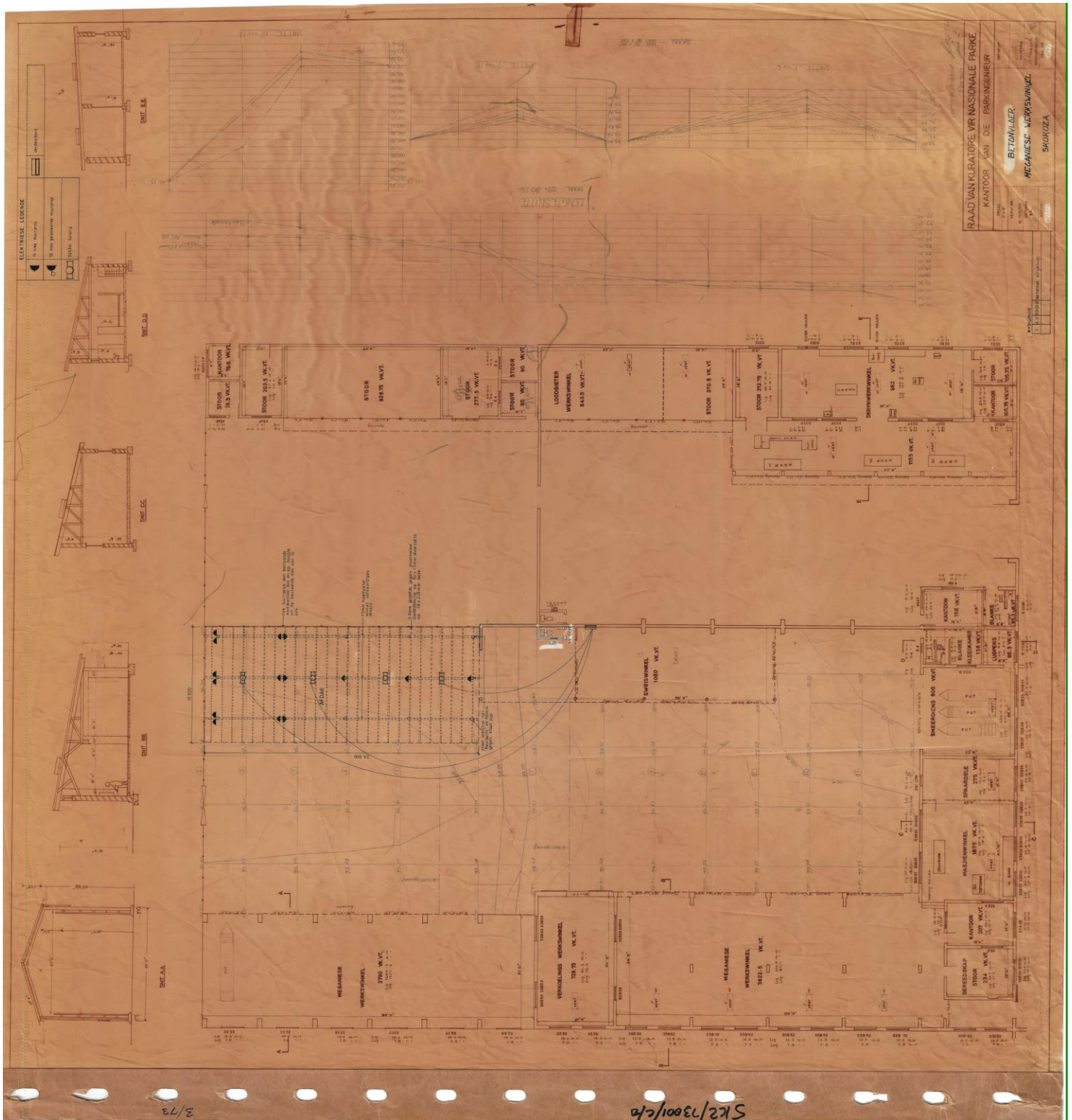

➤ **Infrastructure consists of:**

- ☞ Size: 5,460m²
- ☞ Office block: 3 x offices
- ☞ Working bays = 11
- ☞ Storerooms = 4
- ☞ Tyre change bay = 1
- ☞ 2 x Service pits
- ☞ Structure to accommodate a medium spray booth
- ☞ No equipment
- ☞ Electricity and water available in all work bays

2. Emergency roadside assistance workshop Skukuza

➤ **Floor plan**

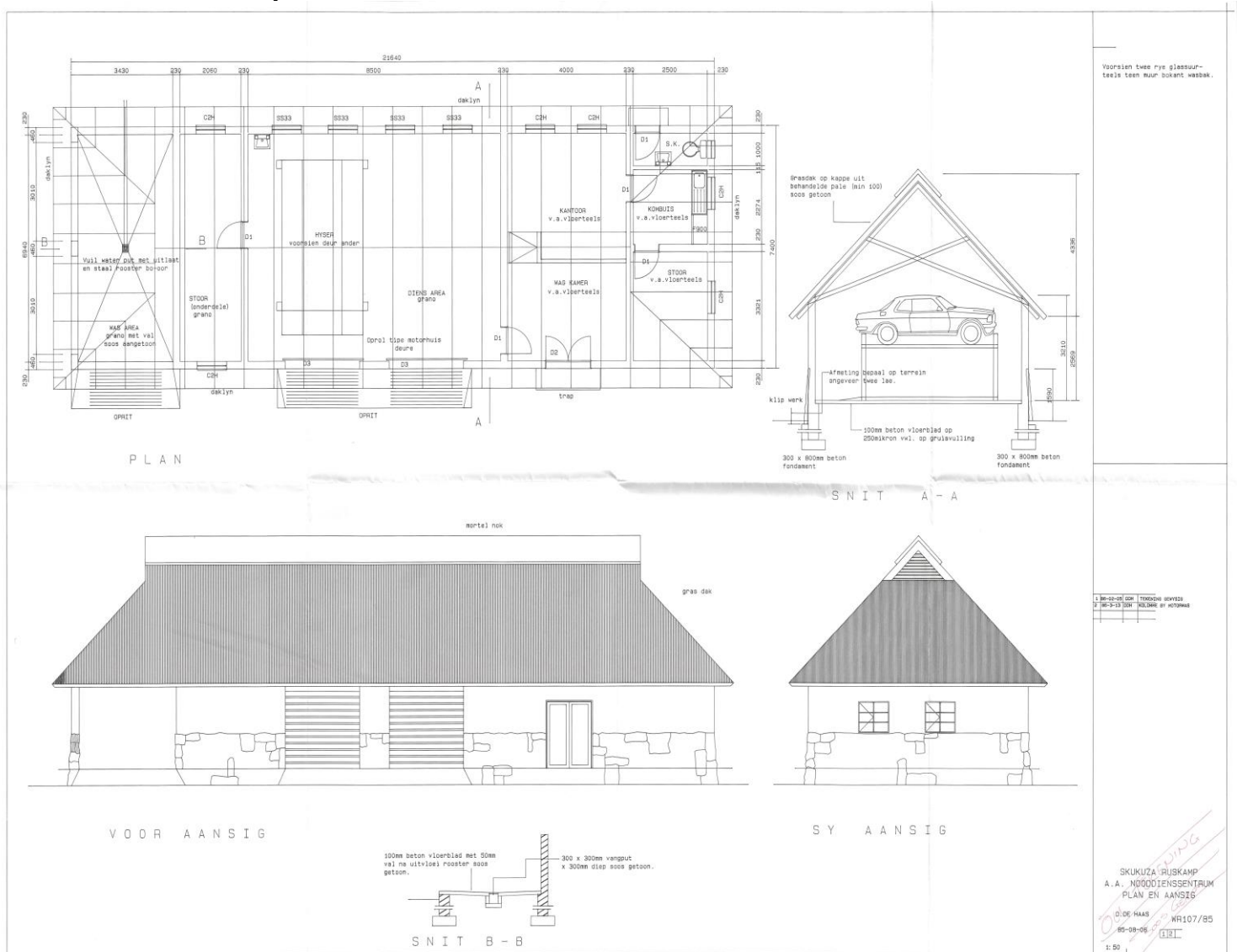

➤ **Infrastructure consists of:**

- ☞ Size: 877m²
- ☞ Office block: 1 x office
- ☞ Working bays = 2
- ☞ Storerooms = 1
- ☞ Tyre change bay = 1
- ☞ Equipment = 1 service lift
- ☞ Electricity and water available in all work bays

3. Letaba workshop

➤ Floor plan

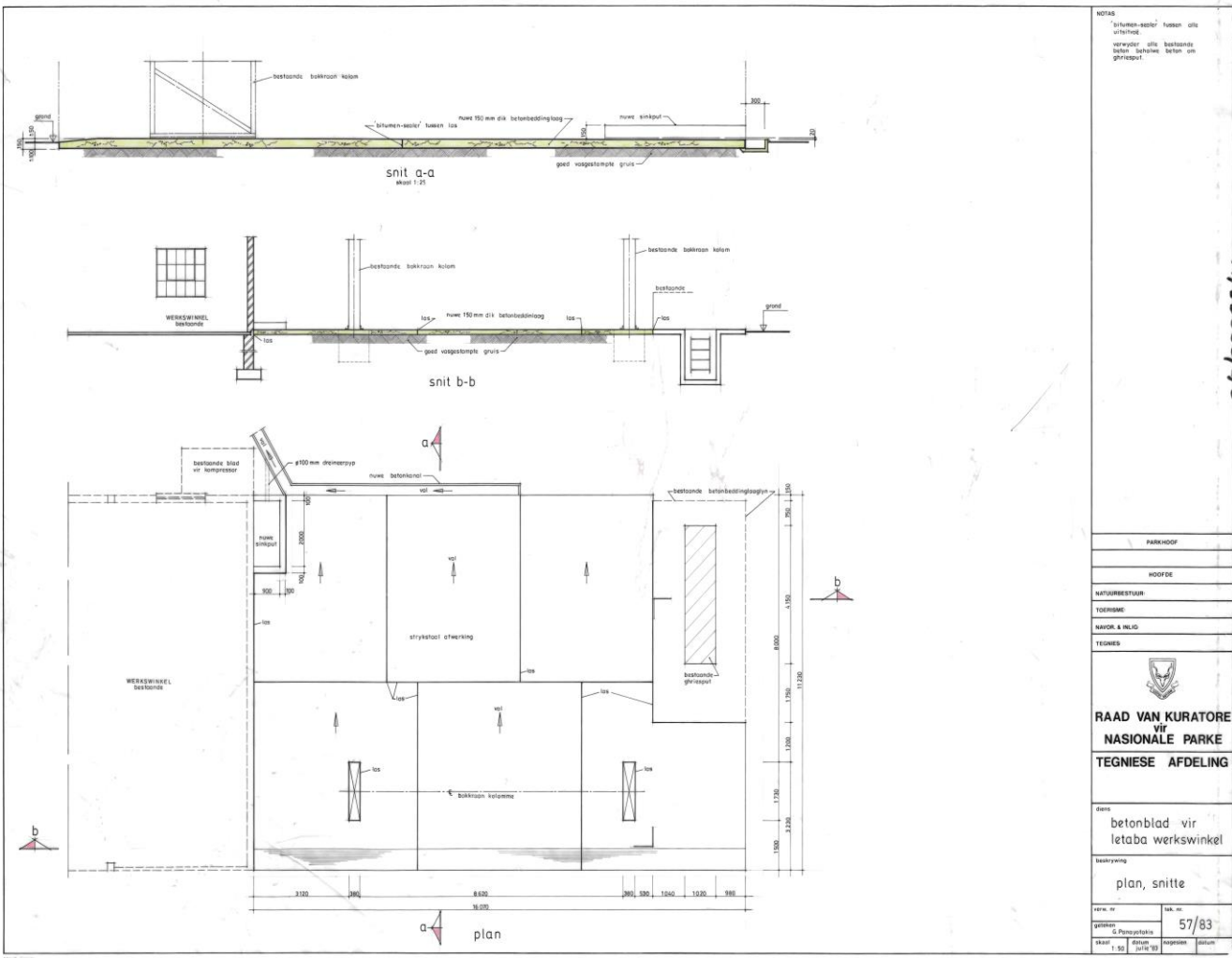

- #### ➤ Infrastructure consists of:
- ☞ Size: 2,078m²
 - ☞ Office block: 1 x office
 - ☞ Working bays = 4
 - ☞ Storerooms = 3
 - ☞ Tyre change bay = 1
 - ☞ Equipment = 1 Service lift – not operational
 - ☞ Electricity and water available in all work bays

4. Shingwedzi workshop

➤ Floor plan

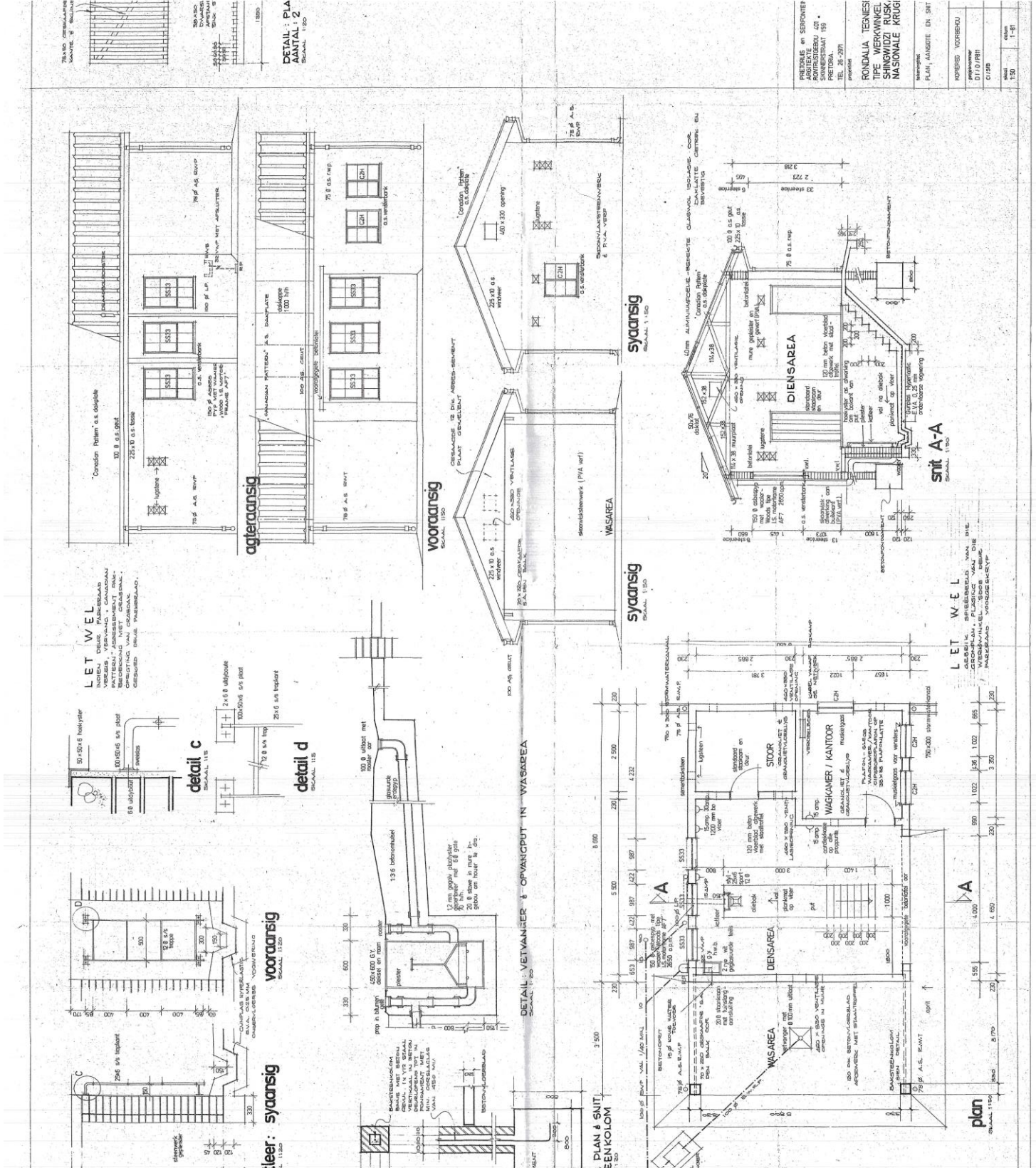

➤ **Infrastructure consists of:**

- ☞ Size: 1,832m²
- ☞ Office block: 1 x office
- ☞ Working bays = 3
- ☞ Storerooms = 3
- ☞ Tyre change bay = 1
- ☞ Equipment = 1 Service lift – not operational
- ☞ Electricity and water available in all work bays